

Technical data sheet for

## VEE RAY FILTAMAX

EF30, EF35, EF40

- Mobility and space saving features
- Powerful reversible 1/3 HP pump
- Full stainless steel construction
- Reusable filter bag
- Upgrade kit to carbon pad filtering
- Easy clean
- Easy service



EF35

### Overall Construction

- Full stainless steel construction
- Mounted on two fixed and two swivel castors
- 1/3 HP motor, reversible, heavy duty pump
- Heavy duty motor switch
- Rigid return delivery tube for safe, efficient, return of oil and shortening to fryer tank
- Reusable 'easy clean' filter bags, with upgrade kit to carbon pad filtering available
- Heavy duty stainless steel handle
- Cord storage
- Heavy duty heat resistant handle fitted to oil delivery tube

### Controls

- Off/Forward/Reverse pump control

### Cleaning and Servicing

- Open stainless steel pan for easy clean
- Easy clean stainless steel exterior

# Technical data sheet for VEE RAY FILTAMAX

## Specifications

### Pump

1/3 HP single phase reversible pump

### Electrical requirements

220 - 240 V.a.c., 50/60 Hz, 1 P+N+E, 3.2A

110 - 120 V.a.c., 50/60 Hz, 1 P+N+E, 6.4A

### Electrical connection

62mm from RH side, 365mm from rear, and 440mm from floor

3 pin 10A plug cordset fitted

### Filtering capacity

EF30 20 litres

EF35 30 litres

EF40 32 litres

### Fryer compatability

EF30 GT45/E

GT46/E

EF35 E43/E

E44/E

EF40 GT60/E

GT60-HPO/E

### Under fryer storage

EF30 GT45/E

GT46/E

EF35 N/A

EF40 GT60/E

GT60-HPO/E

## Dimensions

### EF30

Width 324mm

Depth 683mm

Height 562mm

### EF35

Width 324mm

Depth 735mm

Height 562mm

### EF40

Width 474mm

Depth 683mm

Height 562mm

## Nett weight

### EF30

24kg

### EF35

26kg

### EF40

28kg

## Packing data

### EF30

0.28m<sup>3</sup>, 51kg

### EF35

0.28m<sup>3</sup>, 53kg

### EF40

0.28m<sup>3</sup>, 55kg

## Options at extra cost

Additional filter bags

Carbon pad upgrade kit (Part No. 025669)

Flexible hose with stay cool handle (Part No. 020417)

Drain adaptor kit (Part No. 024705) and drain

extension kit (Part No. 024710) available for using

EF40 for combined 450mm + 600mm wide

Blue Seal fryer filtering applications.

### EF30

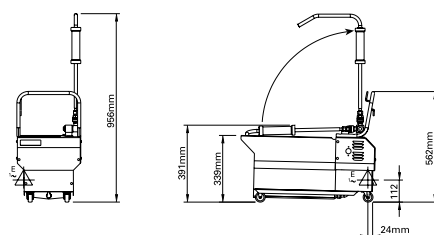

### EF35

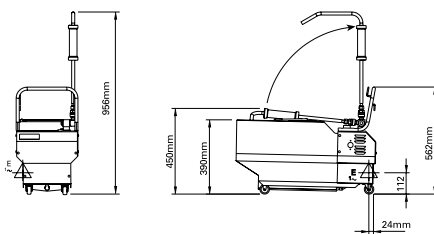

### EF40

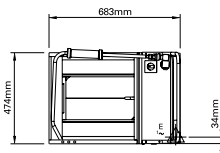
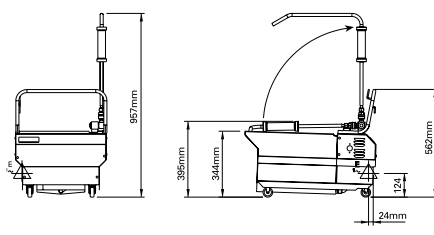

**MOFFAT**

Australia  
www.moffat.com.au  
New Zealand  
www.moffat.co.nz

www.bluesealevolution.com

Australia  
Moffat Pty Limited

Victoria/Tasmania  
740 Springvale Road  
Mulgrave, Victoria 3170  
Telephone 03-9518 3888  
Facsimile 03-9518 3833  
vsales@moffat.com.au

New South Wales  
Telephone 02-8833 4111  
nswsales@moffat.com.au

South Australia  
Telephone 03-9518 3888  
vsales@moffat.com.au

Queensland  
Telephone 07-3630 8600  
qldsales@moffat.com.au

Western Australia  
Telephone 08-9202 6820  
bgarcia@moffat.com.au

New Zealand  
Moffat Limited

Christchurch  
16 Osborne Street  
Christchurch 8011  
Telephone 03-389 1007  
Facsimile 03-389 1276  
sales@moffat.co.nz

Auckland  
Telephone 09-574 3150  
sales@moffat.co.nz



Designed and manufactured by



ISO9001

All Blue Seal products are designed and manufactured by Moffat using the internationally recognised ISO9001 quality management system, covering design, manufacture and final inspection, ensuring consistent high quality at all times.

In line with policy to continually develop and improve its products, Moffat Limited reserves the right to change specifications and design without notice.

Printed in China  
© Copyright Moffat Ltd  
Moffat / 7.09 / 1140



BLUE SEAL EVOLUTION SERIES®

VEERAY®