

UNDERMOUNT SINK

INSTALLATION INSTRUCTIONS

1

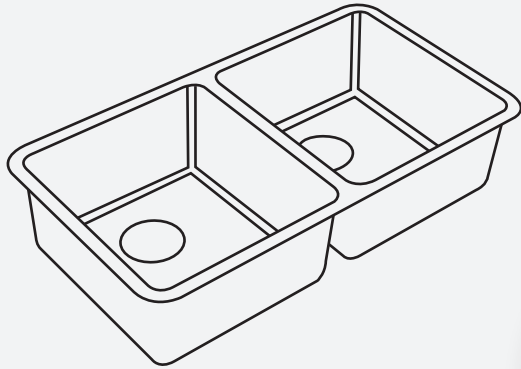

2

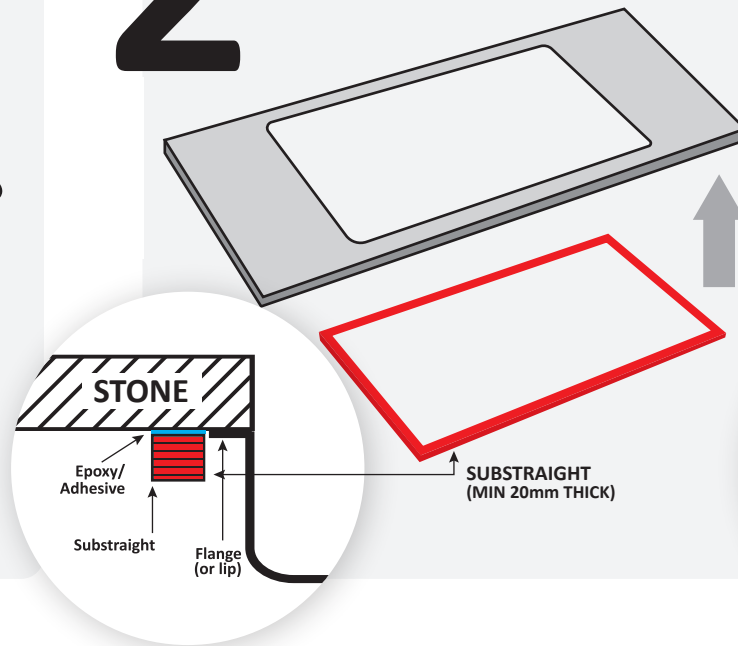

NOTE: paper and cardboard templates where supplied are only to be used as a guide. Using the actual sink ensures a more accurate cutout.

Attach substraight under the bench around the perimeter of the benchtop cutout to accommodate the size of the sink.

3

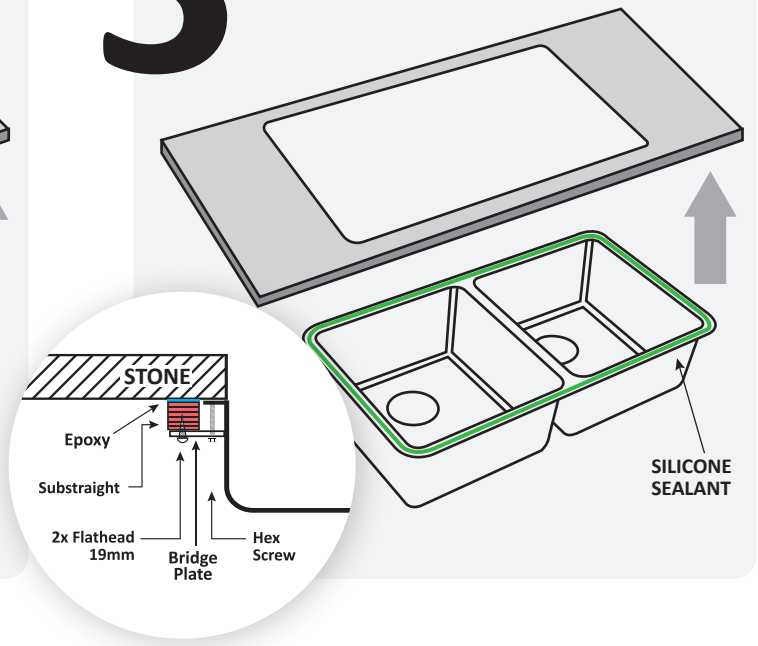

Clean the bottom of the countertop and the top flange (or lip) of the sink with methylated spirits. Then apply a bead of silicone to the top edge of the bowl. Position sink in place then screw the bridge plate to the substraight using the hex screws to secure the sink in correct position.

Templates are supplied only as a guide. The physical use of the sink will ensure a more accurate cutout. Abey recommends that undermount sinks and routing of your solid surface material should be installed by a professional installer for best results. Warranty is voided if epoxy or adhesive is used to secure the sink to the bench.

Abey^{AU}

Inset Sink Installation ICS Clip System

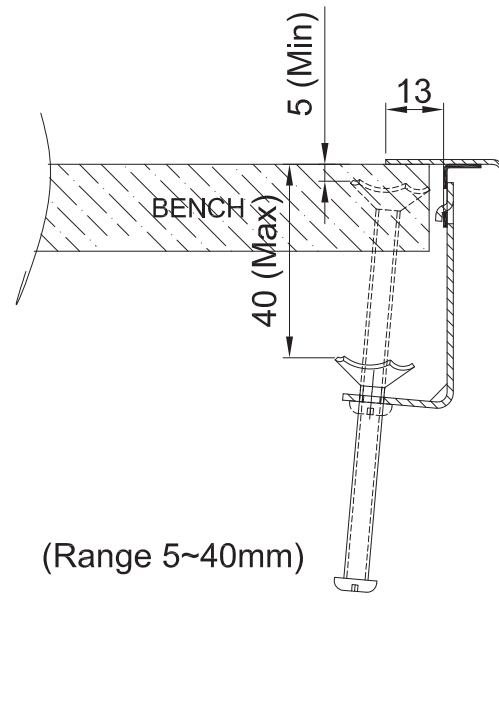
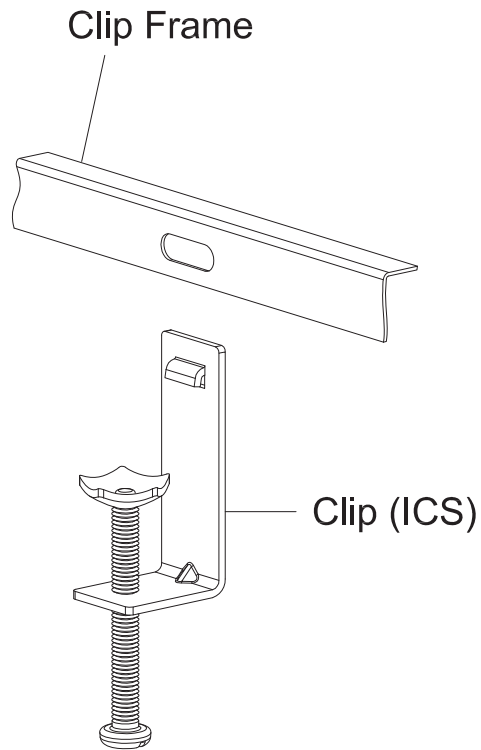

Detail A