







Model Code: RFA100K

Included Accessories

		
ICE10	LB-9134	DTA30

Optional Accessories

		
UMD	DR006	CBB282
		
6020		

Dimensions

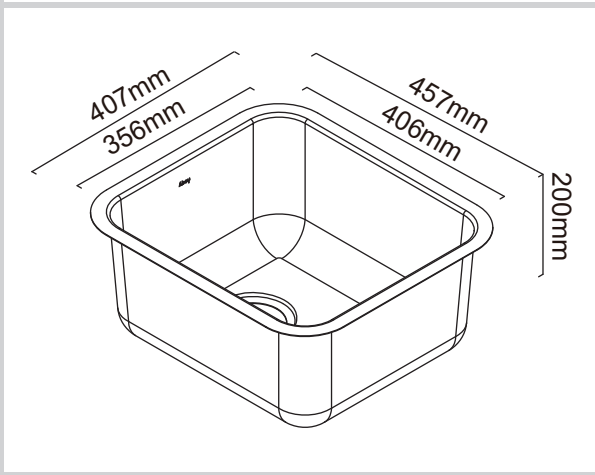

Specifications

Description	Single Bowl
Overall Sink Size	407mm x 457mm x 200mm deep
Bowl Dimensions	356mm x 406mm x 200mm deep
Drainer Length	N/A
Technic	Pressed
Material	1.1 mm Stainless steel SUS304

Installation

Fixings	Inset clips supplied
Template	N/A
Min Cabinet Size	500mm
Waste Holes	1 x 90mm round Compatible with waste disposal

Plumbing

Waste Fittings	1 x (90mm x 2") basket waste included
----------------	---------------------------------------

Packaging

Carton Type	EPS protection & individual sleeve
Gross Weight	6.2Kg
Carton Size	510mm x 330mm x 460mm
Pack QTY	1

SURFACE FINISH

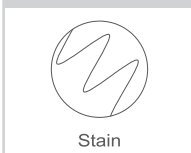

WASTE KIT

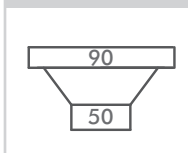

MATERIAL

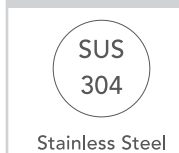

INSTALLATION OPTIONS

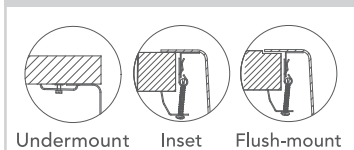

PROFILE

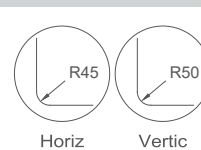

Abey are Australia's leaders in sinkware, designing and manufacturing to the world's highest quality specifications as well as sourcing and bringing you Europe's very best, leading edge designs – practical, affordable, inspirational, stylish, timeless or cutting edge. When you buy an Abey stainless steel sink you receive the highest quality and a 25 year warranty. Abey and the manufacturer are continually seeking ways to improve the design specifications, aesthetic and production techniques of the products. As a result, alterations to the specifications and dimensions of the products and designs occur continually.