

VOLLEY

Lighting that's made to linger. A refined illumination that's designed to bring intentional warmth to every space it inhabits. Creating a soft ambience that makes you want to linger.

- Available in unique finishes; such as Champagne & Carbon.
- Change the ambience with White or Smoke glass.
- Set the mood further with Phase-Cut Dimming.
- 3 Years Warranty.

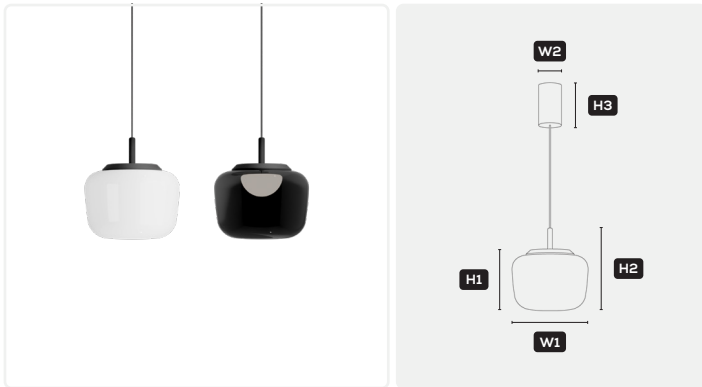

DIMENSIONS W1 Ø150mm H1 106mm H2 160mm

CANOPY DIMENSIONS W2 Ø60mm H3 100mm

CABLE LENGTH 2m

LUMINAIRE OPTIONS

FINISHES

BLACK WHITE CHAMPAGNE CARBON

GLASS FINISHES

WHITE SMOKE

GENERAL SPECIFICATIONS

LED LUMENS (WHITE | SMOKE)

15W 1080Lm | 505Lm

EFFICACY Up to 72 Lm/W

COLOUR 3000K, Warm White

MATERIAL Aluminium, Glass

CABLE FINISHES Black | White | Transparent

[BLACK & CARBON |
WHITE | CHAMPAGNE]

CRI 90+

BEAM Diffused

IP 20

COLOUR DEVIATION SDCM ≤3

LIFETIME > 72,000hrs L70

WARRANTY 3 Years

DRIVER SPECIFICATIONS

POWER 240V Built-In, Dimmable Driver

DIMMING Phase-Cut Dimming

PROJECT DETAILS

PROJECT

TYPE

NOTES

PRODUCT CODES

Black + White Glass **119-VOL15015BWG3**

Black + Smoke Glass **119-VOL15015BSG3**

White + White Glass **119-VOL15015WWG3**

White + Smoke Glass **119-VOL15015WSG3**

Champagne + White Glass **119-VOL15015CHWG3**

Champagne + Smoke Glass **119-VOL15015CHSG3**

Carbon + White Glass **119-VOL15015CWG3**

Carbon + Smoke Glass **119-VOL15015CSG3**

