

Visual Inspection Zone



MAINTAINING THE BARRIER

The Termimesh barrier itself needs no upkeep or maintenance, however the Australian Standard (AS 3660.1) recommends annual termite inspections. To conduct inspections effectively it is critical to have an exposed gap around the perimeter walls between the Termimesh level and any substrate. This gap creates a visual inspection zone to identify termite activity such as bridging.

It is very important to keep this inspection zone free of obstructions and fully visible around the complete perimeter of your house.

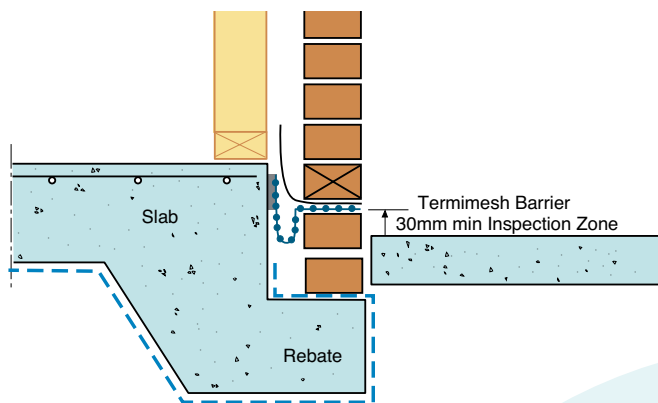

Around paved areas

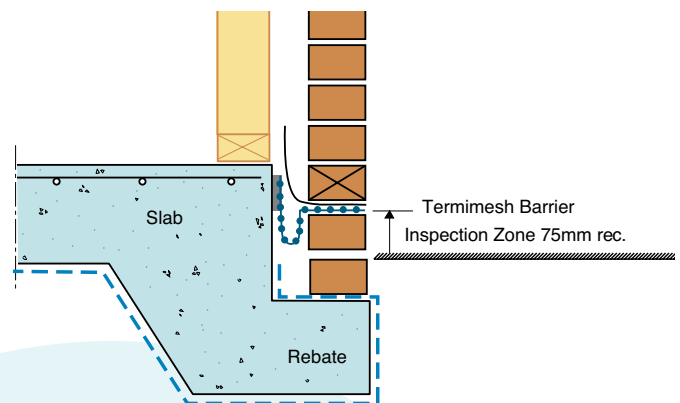

Garden Beds or Lawn areas

Around Paved Areas

Areas involving concrete paths or brick paving require a visual inspection zone of at least 30mm, except in doorways where this zone may be reduced to 20mm.

These areas should also be kept clear of permanent doormats which may obstruct or cover the barrier and inspection zone.

Garden Beds or Lawn Areas

A garden or lawn area adjacent to an exterior wall, will require a greater visual inspection zone as it is possible for termite activity to be concealed by leaf litter, long grass or the like.

This zone should be a minimum of 75mm as recommended under Australian Standards. In areas of known high termite activity, a larger zone should be considered.

YOUR RESPONSIBILITY FOR CARE AND MAINTENANCE

You can help maintain the integrity of the Termimesh barrier by ensuring the following:

- **Inspection.** Book your annual termite inspection with Termi Home & Commercial today.
- **Storage.** Do not store or place any materials over the barrier.
- **Future fixtures on outside walls.** Provide a 25mm inspection gap between the wall and the fixture. Fixtures include hot water systems, air conditioners, storage sheds or water tanks.
- **Timber fences and landscaping timbers.** Landscape and fence timbers that come in contact with the ground increase the risk of termite infestation.
- **Visual inspection zones.** Ensure you regularly check the visual inspection zone and keep free from any obstructions which could result in termites bridging the Termimesh barrier.
- **Moisture.** Termites are drawn to moisture, so repair any leaking taps or plumbing as soon as possible. Reduce damp soil around exterior walls by managing air-conditioner runoff, downpipes and irrigation.
- **New plumbing or cabling.** Any new plumbing pipes or cabling entering the home from outside walls must be above the termite barrier level. Ensure contractors are aware of this.
- **Extensions or additions to your property.** Contact us before undertaking any extensions or alterations to the building as they may impact the Termimesh barrier and Warranty. We will advise you how to maintain the integrity of your termite protection.
- **Warranty.** Register your Termimesh Pledge Guarantee [here](#) or scan the QR code.

