

| Revision | Rev. Date | Changes Made |
|---------------|-----------|--|
| REV. - 1 (SB) | 28-07-05 | "I" POST CROSS SECTION MODIFIED TO 150x102, BASE PLT. PC DWG MODIFIED |
| REV. - 2 (SB) | 20-09-05 | Part No. of Bridge Post deleted, Individual Part nos. for Bridge Post added |
| REV. - 3 (SB) | 08-10-06 | Post length modified |
| REV. - 4 (SB) | 29-03-10 | Post length 830 now shown as TL4 |
| REV. - 5 (SB) | 25-01-12 | ringing hole size corrected, nut class added |
| REV. - 6 (SB) | 06-03-12 | "I" Post & blockout specs added, dim of blockout updated, cast-in bkt dwg removed |
| REV. - 7 (SB) | 28-03-12 | Blockout notch dimensions updated as per AASHTO document PWB03 |
| REV. - 8 (LA) | 07-02-13 | Change Blockout from hot rolled section to welded section as per AASHTO document PWB03 |
| REV. - 9 (LA) | 09-07-14 | Added note "Welded Steel Modified Blockout accepted by NZTA" |

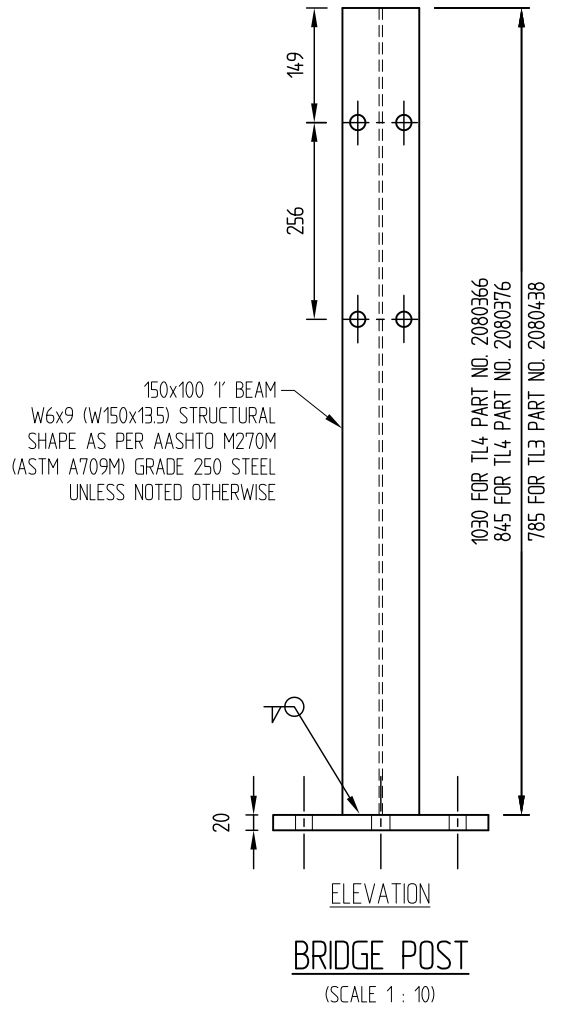
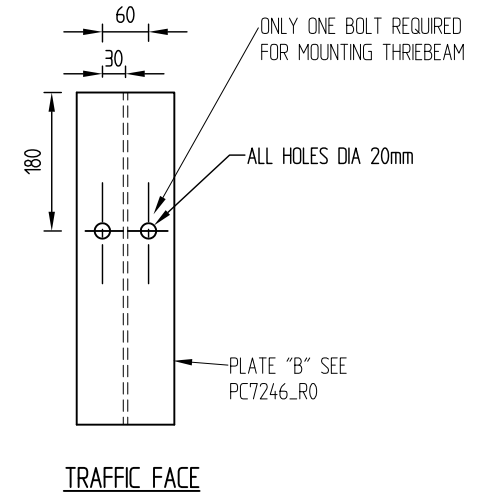
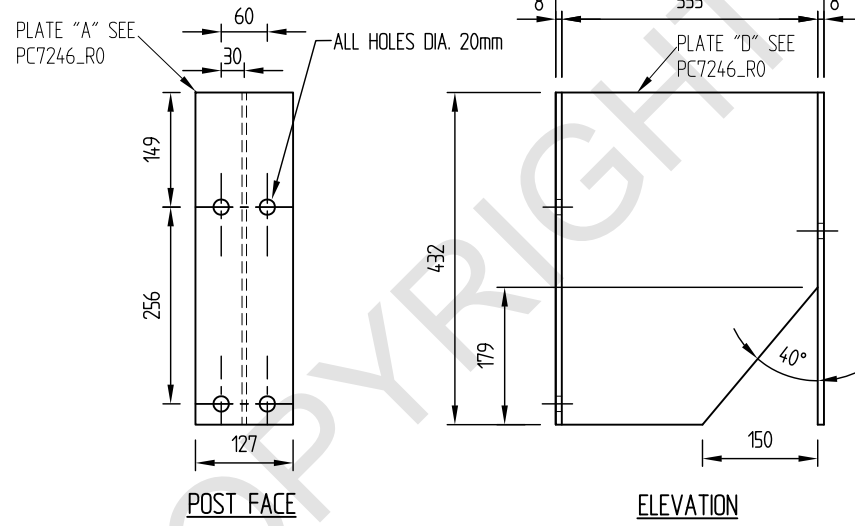

WELDED MODIFIED BLOCKOUT
PART NO. 2080389
(SCALE 1 : 10)
BLACK WT. = 13.1 kg
GALV WT. = 13.9 kg - DIP AS PER AS/NZS 4680:2006

**WELDED STEEL MODIFIED BLOCKOUT
ACCEPTED BY NZTA**

- NOTES :**
- HEIGHT FROM ROAD TO TOP OF THRIEBEAM TO BE 865mm FOR TL4 OR 805mm FOR TL3. ASSUMES 20mm DRY PACK UNDER BASE PLATE AS PER TNZ BRIDGE MANUAL.
 - REFER TO G9 (MODIFIED) AS/NZS3845:1999 WITHOUT THE "C" POST.
 - "I" POST AS PER AASHTO M270M (ASTM A709M) GRADE 250 STEEL. FOR CAST-IN BRACKET REFER TO DWG FX150.
 - WELDED BLOCKOUT STEEL MATERIAL - GRADE 250 TO AS/NZS 3678
 - ALL FILLET WELDS CONTINUOUS WITH A MIN 6mm LEG LENGTH, CATEGORY SP TO AS/NZS 1554.1, UNLESS NOTED OTHERWISE
 - BLOCKOUT TO BE HOT DIP GALVANIZED TO AS/NZS4680:2006.
 - WELDED BLOCKOUT PLATE THICKNESSES ARE DERIVED FROM EX. I-BEAM M14X18 [M360X25.6] AS DEFINED IN AASHTO M 160 / M 160M.

306 Neilson Street,
Onehunga, Auckland
PO Box 12 949, Penrose
Auckland, New Zealand
Telephone 09-634 1239
Facsimile 09-634 4525
www.cspacific.co.nz

THRIEBEAM
"I" SECTION BRIDGE POST AND
WELDED MODIFIED BLOCKOUT

| | | | |
|---------------|-------|----------|-----------------|
| Drawn by | SB | Date | 04-02-2004 |
| Checked | SW | Scale | A4 As Stated |
| Reference No. | | | |
| Drawing no. | FX475 | Rev. No. | 9 |

ALSO SEE FX150, FX476 & PC7246_R0

Copyright: This design, information and drawing remain the property of CSP Pacific and may not be used or copied without approval in writing from CSP Pacific.