

46 Symon Crescent, Greensborough



46 Symon Crescent, Greensborough, comprising of Reserve 1 on Plan of Subdivision 337171S, being the land contained in Certificate of Title Volume 10260 Folio 575 as shown below.

Zoning: General Residential Zone1 (GRZ1) - see FAQs for more information

Overlays: Special Building Overlay (SBO) (partially covered - to the eastern and lower part of the land) - see FAQs for more information.

Note: The sale of the land will be conditional upon Council removing the reserve status from the land. See FAQs for more information.

The sale of the land will be subject to a condition that the purchaser enters into a section 173 agreement under the *Planning and Environment Act 1987* that allows only a single dwelling on each lot if the land is subsequently subdivided.

Council proposes to sell the land by either; expression of interest, tender; auction or public sale.

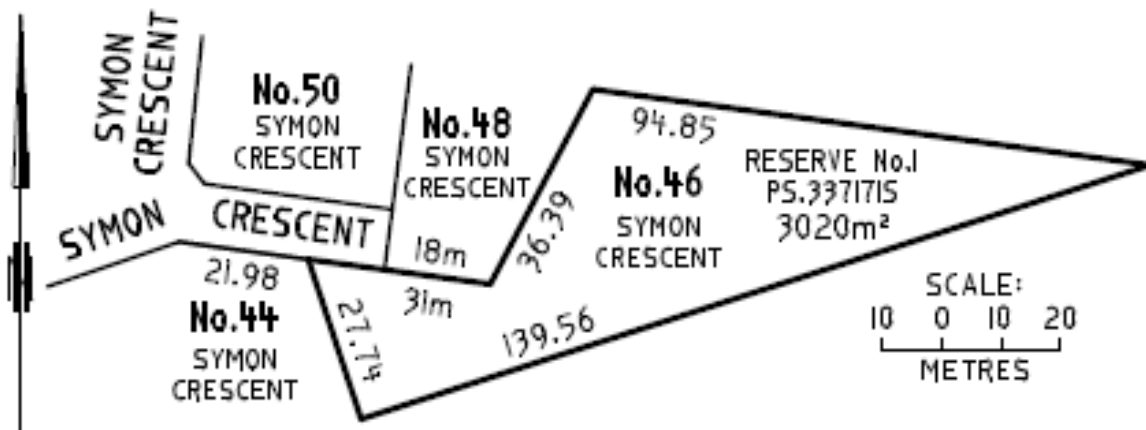

Enquiries : 9433 3111
www.nillumbik.vic.gov.au