

[F] PROPOSED EASEMENT FOR ELECTRICITY PURPOSES VARIABLE WIDTH

[E] EASEMENT FOR SEWERAGE
 GOV GAZ 1/12/1961 (18293-3000 & VIDE DP 839H65)

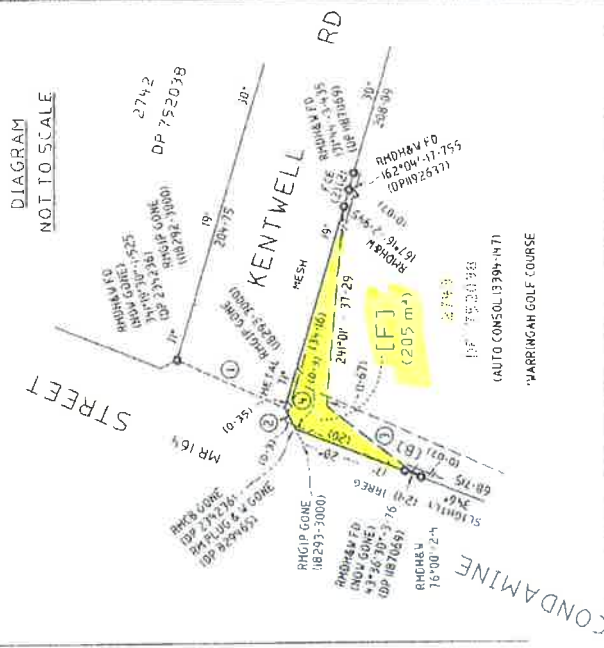
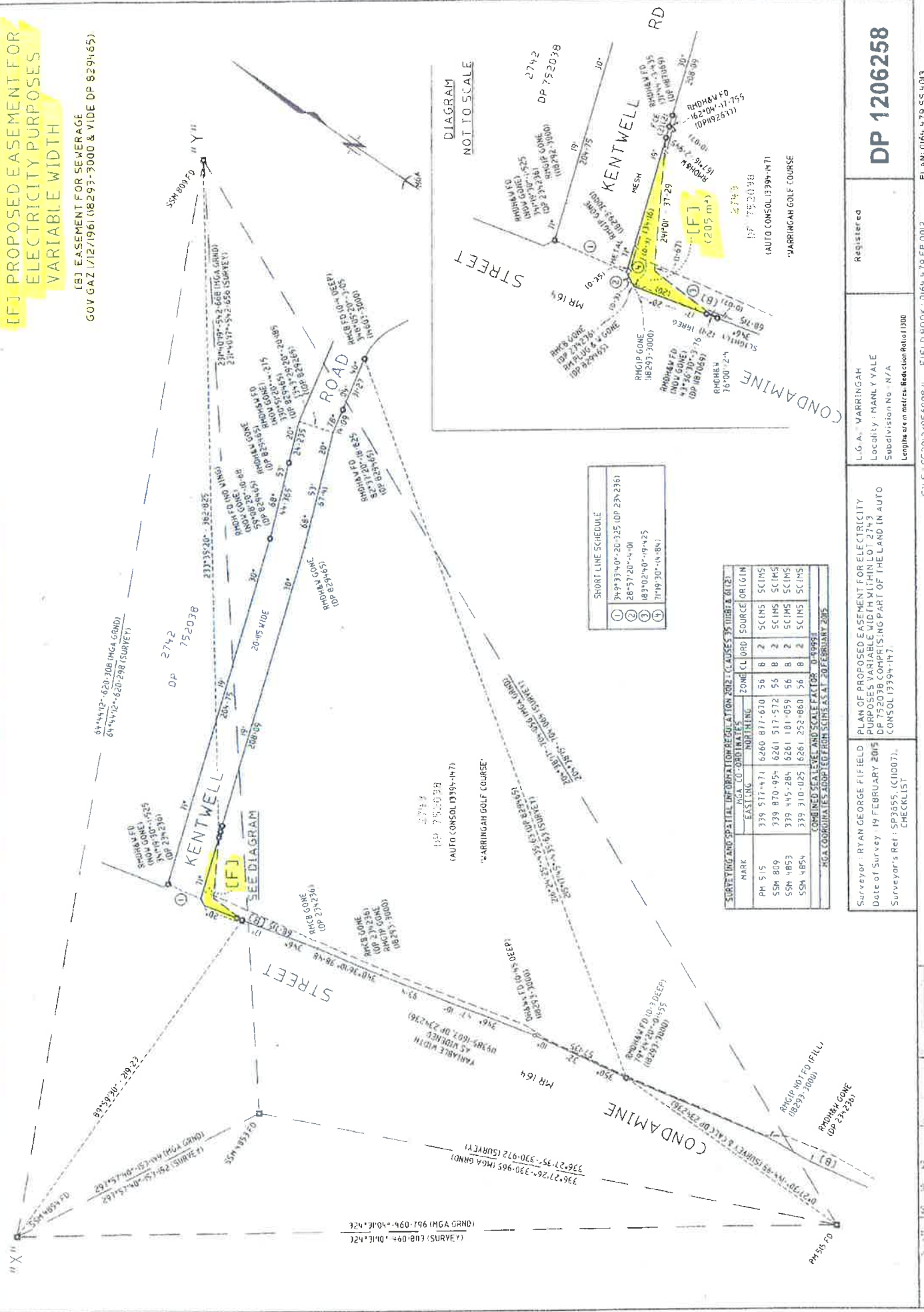

SHORT LINE SCHEDULE

1	34°33'40"-20-325 (OP 234-236)
2	26°57'20"-4-01
3	18°30'24"-194-25
4	71°19'30"-14-84

SOURCING AND SPATIAL INFORMATION (CONVEYANCE TABLE CLAUSES) (SHEET 1) (M2)

MARK	EASTING	NORTHING	ZONE	CL	DRD	SOURCE	ORIGIN
PH 515	339 517-471	6260 877-670	56	B	2	SCIMS	SCIMS
SSM 809	339 870-954	6261 517-572	56	B	2	SCIMS	SCIMS
SSM 4853	339 445-284	6261 181-059	56	B	2	SCIMS	SCIMS
SSM 4854	339 310-025	6261 262-860	56	B	2	SCIMS	SCIMS

COMBINED SCALE AND SCALE FACTOR: 1:10000
 MGA COORDINATES ADJUSTED FROM SCIMS AS AT 20 FEBRUARY 2015

Surveyor: RYAN GEORGE FIFIELD
 Date of Survey: 19 FEBRUARY 2015
 Surveyor's Ref: SP3855 (C11007)
 CHECKLIST

PLAN OF PROPOSED EASEMENT FOR ELECTRICITY PURPOSES VARIABLE WIDTH WITHIN LOT 2743 DP 7520378 COMPRISING PART OF THE LAND IN AUTO CONSOL 13394-147

L.G.A.: WARRINGAH
 Locality: MANNLY VALE
 Subdivision No.: N/A
 Lengths are in metres. Reduction Ratio: 1:1000

Registered

DP 1206258