

Copyright State of Victoria. This publication is copyright. No part may be reproduced by any process except in accordance with the provisions of the Copyright Act 1968 (Cth) and for the purposes of Section 32 of the Sale of Land Act 1962 (Vic) or pursuant to a written agreement. The information is only valid at the time and in the form obtained from the LANDATA REGD TM System. The State of Victoria accepts no responsibility for any subsequent release, publication or reproduction of the information.

REGISTER SEARCH STATEMENT (Title Search) Transfer of Land Act 1958

VOLUME 11270 FOLIO 215

Security no : 124079613214C
Produced 07/10/2019 11:30 AM

LAND DESCRIPTION

Lot 1 on Plan of Subdivision 640388Y.
PARENT TITLE Volume 08144 Folio 670
Created by instrument PS640388Y 12/05/2011

REGISTERED PROPRIETOR

Estate Fee Simple
Sole Proprietor
HAGA PTY LTD of 200 HODDLE STREET ABBOTSFORD VIC 3067
AR196339R 02/07/2018

ENCUMBRANCES, CAVEATS AND NOTICES

Any encumbrances created by Section 98 Transfer of Land Act 1958 or Section 24 Subdivision Act 1988 and any other encumbrances shown or entered on the plan set out under DIAGRAM LOCATION below.

AGREEMENT Section 173 Planning and Environment Act 1987
AH907230U 20/04/2011

DIAGRAM LOCATION

SEE PS640388Y FOR FURTHER DETAILS AND BOUNDARIES

ACTIVITY IN THE LAST 125 DAYS

NIL

-----END OF REGISTER SEARCH STATEMENT-----

Additional information: (not part of the Register Search Statement)

Street Address: PRINCES HIGHWAY PAKENHAM VIC 3810

ADMINISTRATIVE NOTICES

NIL

eCT Control 19751U KALUS KENNY INTELEX
Effective from 02/07/2018

DOCUMENT END

Delivered from the LANDATA® System by InfoTrack Pty Ltd.

The information supplied by InfoTrack (BHL Insight) has been obtained from InfoTrack Pty Limited by agreement between them. The information supplied has been obtained by InfoTrack Pty Limited who is licensed by the State to provide this information.

Signed by Council: Cardinia Shire Council, Original Certification: 08/11/2010, S.O.C.: 29/04/2011

PLAN OF SUBDIVISION		Stage No.	LR use only EDITION 1	Plan Number PS 640388Y
Location of Land Parish: Pakenham Township: Pakenham Section: Crown Allotment: 3 (part) Crown Portion: Title References: Vol. 8144 Fol. 670 Last Plan Reference: TP883881W Lot 1 Postal Address: Princes Highway, Pakenham 3810 (At time of subdivision) MGA Co-ordinates E. 364 060 (Of approx. centre of plan) N. 5 786 560 ZONE 55		Council Certification and Endorsement Council Name: Cardinia Shire Council Ref: 1. This Plan is certified under Section 6 of the Subdivision Act 1988. 2. This plan is certified under section 11(7) of the Subdivision Act 1988 Date of original certification under section 6/...../ 3. This is a statement of compliance issued under section 21 of the Subdivision Act 1988. OPEN SPACE (i) A requirement for public open space under Section 18 Subdivision Act 1988 has / has not been made. (ii) The requirement has been satisfied. (iii) The requirement is to be satisfied in Stage Council delegate Council seal Date / / Re-certified under section 11(7) of the Subdivision Act 1988. Council delegate Council seal Date / /		
Vesting of Roads or Reserves				
Identifier	Council/Body/Person			
Nil				
Notations				
Depth Limitation : Does not apply		Staging This is not a staged subdivision Planning permit No.		
		This is a SPEAR plan		
		Survey This plan is based on survey		
		This survey has been connected to permanent marks no(s). 28 & 36 in Proclaimed Survey Area no.		
Easement Information				
Legend: A - Appurtenant Easement E - Encumbering Easement R - Encumbering Easement (Road)				LRS use only
Easement Reference	Purpose	Width (Metres)	Origin	Land Benefited/in Favour Of
Nil				
				Statement of compliance/ Exemption Statement Received <input checked="" type="checkbox"/> Date: 03/05/11
				LRS use only PLAN REGISTERED TIME 1.33 DATE: 12/05/2011 Ian R Mcleod Assistant Registrar of Titles. Sheet 1 of 2 Sheets
 Cardno Grogan Richards Consulting Engineers Structural, Civil, Hydraulic, Land Surveying, Traffic & Transportation Cardno Victoria Pty Ltd ABN 47 106 610 913 150 Oxford Street Collingwood, VIC 3066 Tel: +61 3 8415 7777 Fax: +61 3 8415 7788 cgr@cardno.com.au www.cardnogroganrichards.com.au		LICENSED SURVEYOR (PRINT) <u> Peter Francis Sullivan </u> SIGNATURE <u> Digitally Signed </u> DATE _____ REF. CG110534-2 VERSION C		_____ DATE / / COUNCIL DELEGATE SIGNATURE Original sheet size A3

Signed by: Peter Francis Sullivan (Cardno Grogan Richards) Surveyor's Plan Version (CG110534-2 version C) 11/05/2011, Amended: 11/05/2011.

Signed by Council: Cardinia Shire Council, Original Certification: 08/11/2010, S.O.C.: 29/04/2011

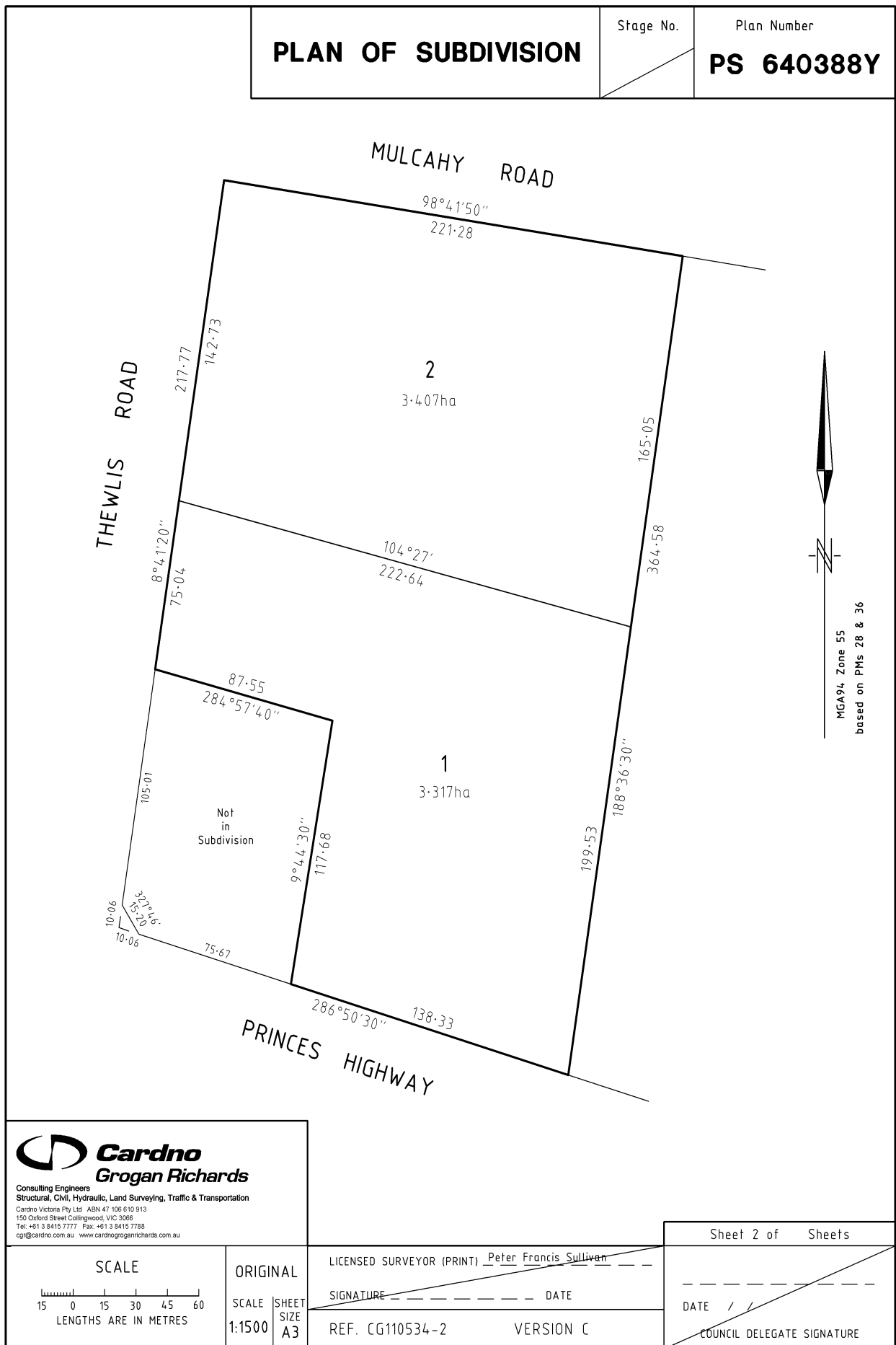

Cardno
Grogan Richards

Consulting Engineers
Structural, Civil, Hydraulic, Land Surveying, Traffic & Transportation
Cardno Victoria Pty Ltd. ABN 47 106 610 913
150 Oxford Street Collingwood, VIC 3066
Tel: +61 3 8415 7777 Fax: +61 3 8415 7788
cgr@cardno.com.au www.cardnogroganrichards.com.au

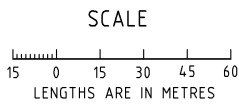

ORIGINAL
SCALE 1:1500
SHEET SIZE A3

LICENSED SURVEYOR (PRINT) Peter Francis Sullivan

SIGNATURE _____ DATE _____

REF. CG110534-2 VERSION C

Sheet 2 of Sheets

DATE / /

COUNCIL DELEGATE SIGNATURE _____

Plan of Subdivision PS640388Y
Certification by Council (Form 5)

SUBDIVISION (PROCEDURES) REGULATIONS 2000

SPEAR Reference Number: S009049C

Plan Number: PS640388Y

Council Name: Cardinia Shire Council

Council Reference Number 1: S10/154

Surveyor's Plan Version: CG110534-2 version C

Certification

This plan is certified under section 6 of the Subdivision Act 1988

Public Open Space

A requirement for public open space under section 18 of the Subdivision Act 1988

Has not been made

Digitally signed by Council Delegate: Penny Carney

Organisation: Cardinia Shire Council

Date: 08/11/2010

Signed by: Penny Carney (Cardinia Shire Council) 08/11/2010