

**Legend**

- Design
- ▭ Cadastre

Map: 2135645A_GIS_1532_A1	Author: MB		 1:2,000 Scale ratio correct when printed at A3	 		<b>Engineering and Technical Services</b> <b>for Healesville Koo Wee Rup Road Upgrade</b>  <span style="font-size: 2em; color: red; font-weight: bold;">PRELIMINARY</span>	Preliminary design Map 1
Date: 26/09/2018	Approved by: -						

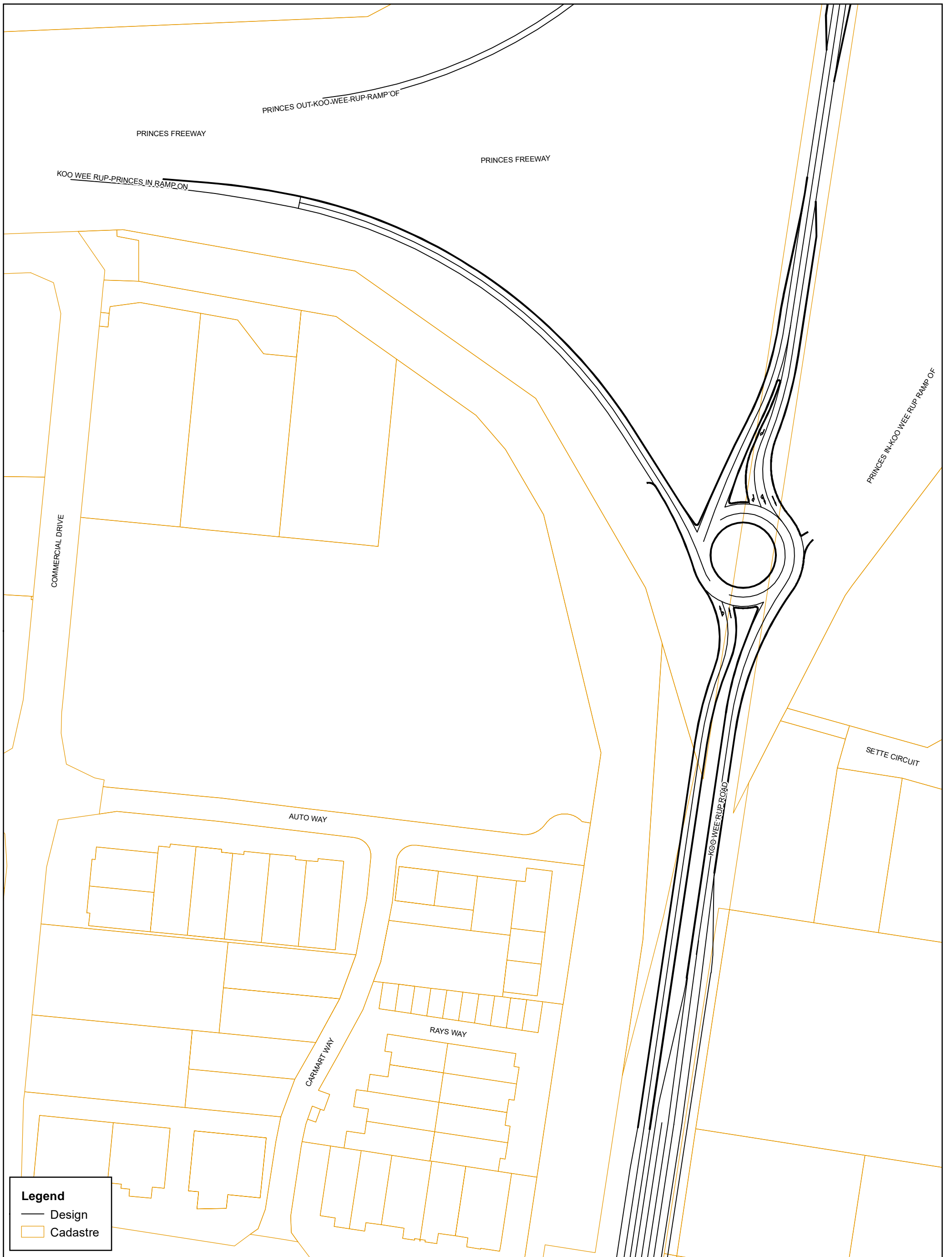

**Legend**

- Design
- ▭ Cadastre

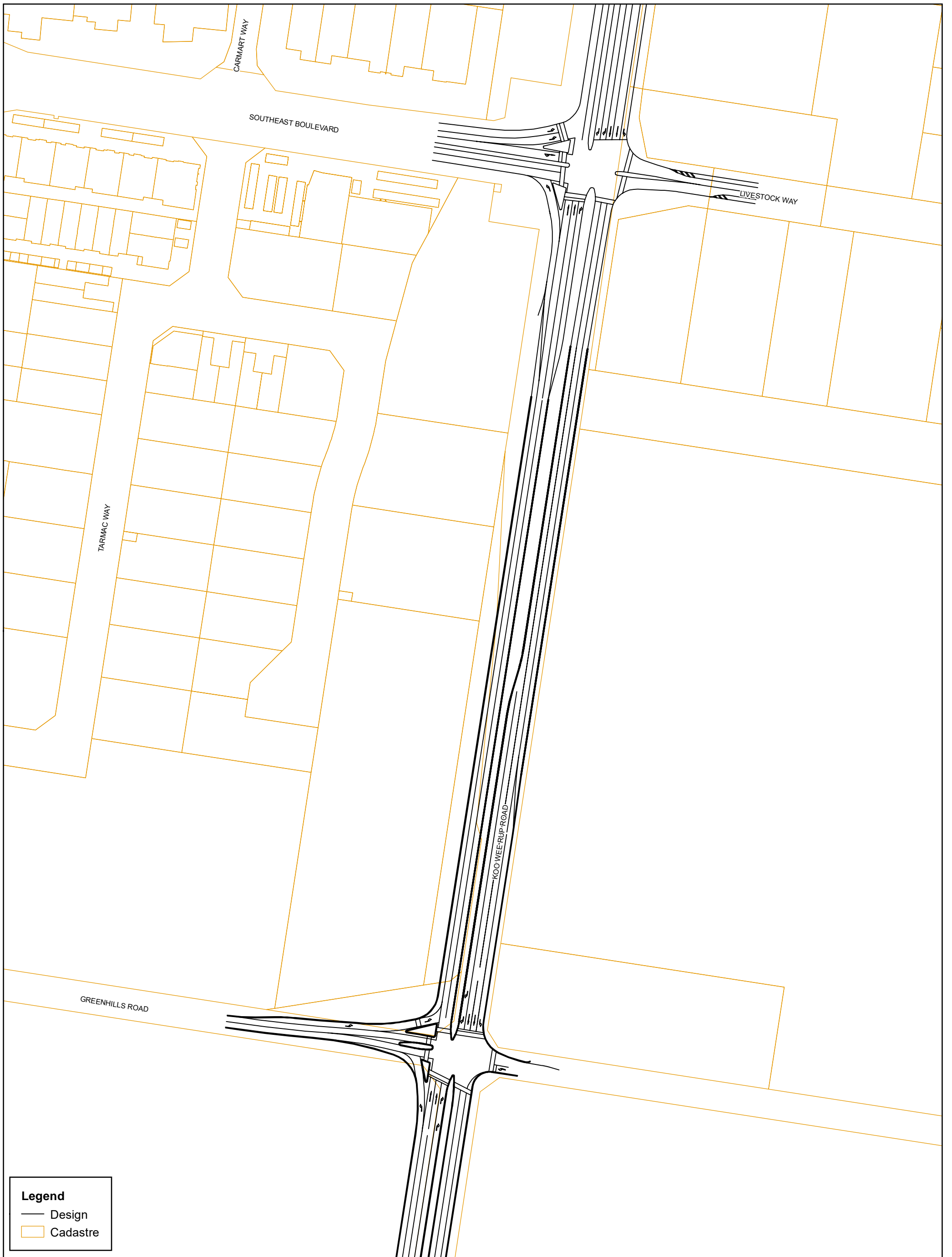

**Legend**

- Design
- ▭ Cadastre

Map: 2135645A_GIS_1532_A1	Author: MB		 1:2,000 Scale ratio correct when printed at A3	 		<b>Engineering and Technical Services</b> <b>for Healesville Koo Wee Rup Road Upgrade</b>  <span style="font-size: 2em; color: red; font-weight: bold;">PRELIMINARY</span>
Date: 26/09/2018	Approved by: -					
<small>Data source: Copyright © The State of Victoria, Department of Environment, Land, Water &amp; Planning 2018          ID: 2135645A-SE-27-GIS-MAP-0001-A</small>			<small>Coordinate system: GDA 1994 MGA Zone 55</small>			<small>© WSP   Parsons Brinckerhoff - Asia Pacific (WSP   PB). Copyright in the drawings, information and data recorded is the property of WSP   PB. This document and the information are solely for the use of the authorised recipient and this document may not be used, copied or reproduced in whole or part for any purpose other than that which it was supplied by WSP   PB. WSP   PB makes no representation, undertakes no duty and accepts no responsibility to any third party who may use or rely upon this document or the information. NCSI Certified Quality System to ISO 9001. © APPROVED FOR AND ON BEHALF OF WSP   Parsons Brinckerhoff - Asia Pacific.</small>
<small>\\apme011\proj\WVicRoads\2135645A_OSAR_ENGINEERING_TECHNICAL_SEI10_GIS\Projects\Maps\2135645A_GIS_1532_A1.mxd</small>			<small>MRPA</small>			<small>www.wsp.com</small>

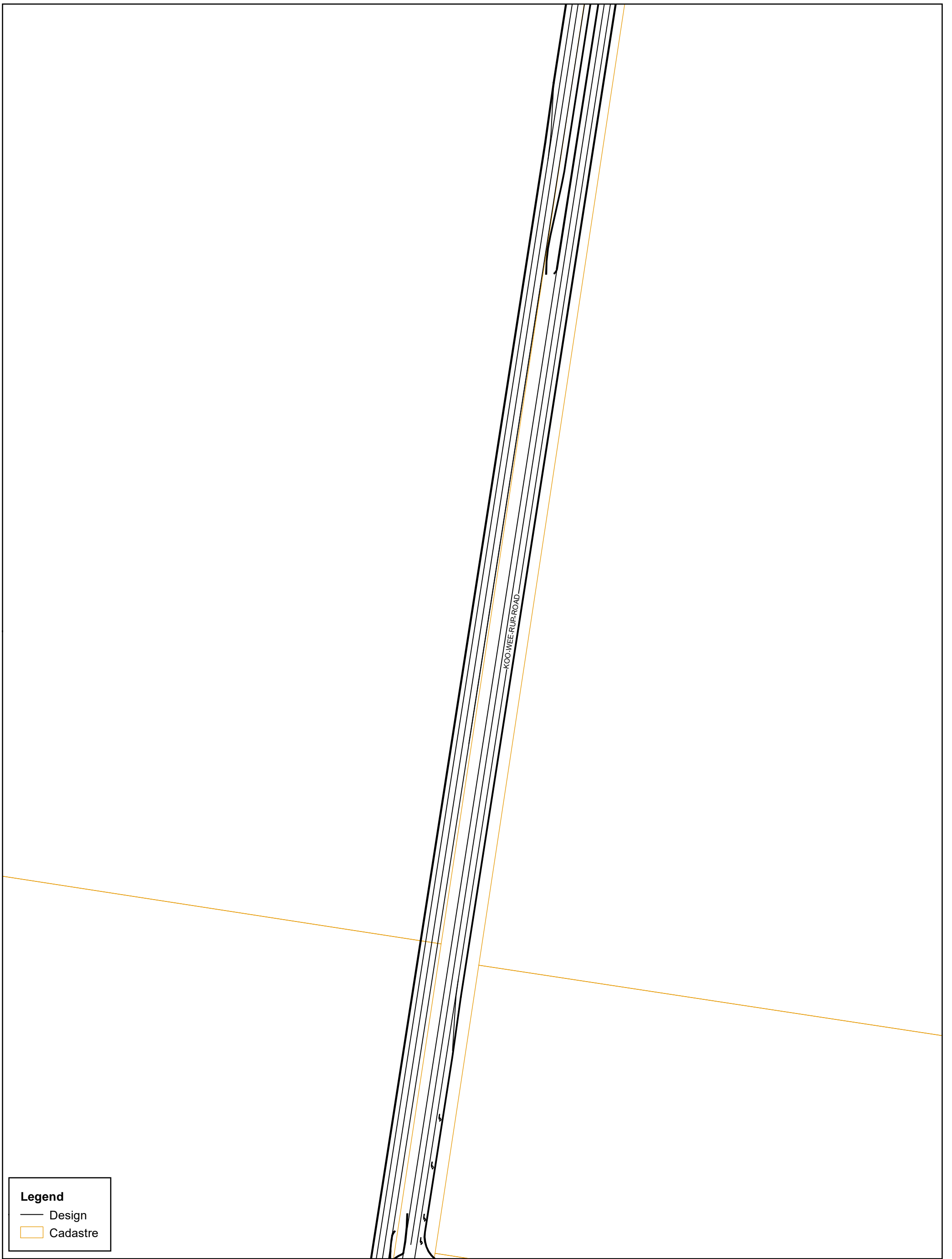

**Legend**

- Design
- ▭ Cadastre

Map: 2135645A\_GIS\_1532\_A1

Author: MB



Date: 26/09/2018

Approved by: -

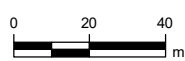

1:2,000

Coordinate system: GDA 1994 MGA Zone 55  
Scale ratio correct when printed at A3



**PRELIMINARY**

**Engineering and Technical Services  
for Healesville Koo Wee Rup Road Upgrade**

Preliminary design  
Map 4

© WSP | Parsons Brinckerhoff - Asia Pacific (WSP | PB). Copyright in the drawings, information and data recorded is the property of WSP | PB. This document and the information are solely for the use of the authorised recipient and this document may not be used, copied or reproduced in whole or part for any purpose other than that which it was supplied by WSP | PB. WSP | PB makes no representation, undertakes no duty and accepts no responsibility to any third party who may use or rely upon this document or the information. NCSI Certified Quality System to ISO 9001. © APPROVED FOR AND ON BEHALF OF WSP | Parsons Brinckerhoff - Asia Pacific.



**Legend**

- Design
- ▭ Cadastre

Map: 2135645A_GIS_1532_A1	Author: MB		 1:2,000	 		<b>Engineering and Technical Services for Healesville Koo Wee Rup Road Upgrade</b>
Date: 26/09/2018	Approved by: -					

© WSP | Parsons Brinckerhoff - Asia Pacific (WSP | PB). Copyright in the drawings, information and data recorded is the property of WSP | PB. This document and the information are solely for the use of the authorised recipient and this document may not be used, copied or reproduced in whole or part for any purpose other than that which it was supplied by WSP | PB. WSP | PB makes no representation, undertakes no duty and accepts no responsibility to any third party who may use or rely upon this document or the information. NCSI Certified Quality System to ISO 9001. © APPROVED FOR AND ON BEHALF OF WSP | Parsons Brinckerhoff - Asia Pacific.

\\apme01\proj\WVicRoads\2135645A\_OSAR\_ENGINEERING\_TECHNICAL\_SEI10\_GIS\Projects\Maps\2135645A\_GIS\_1532\_A1.mxd

MRPA www.wsp.com

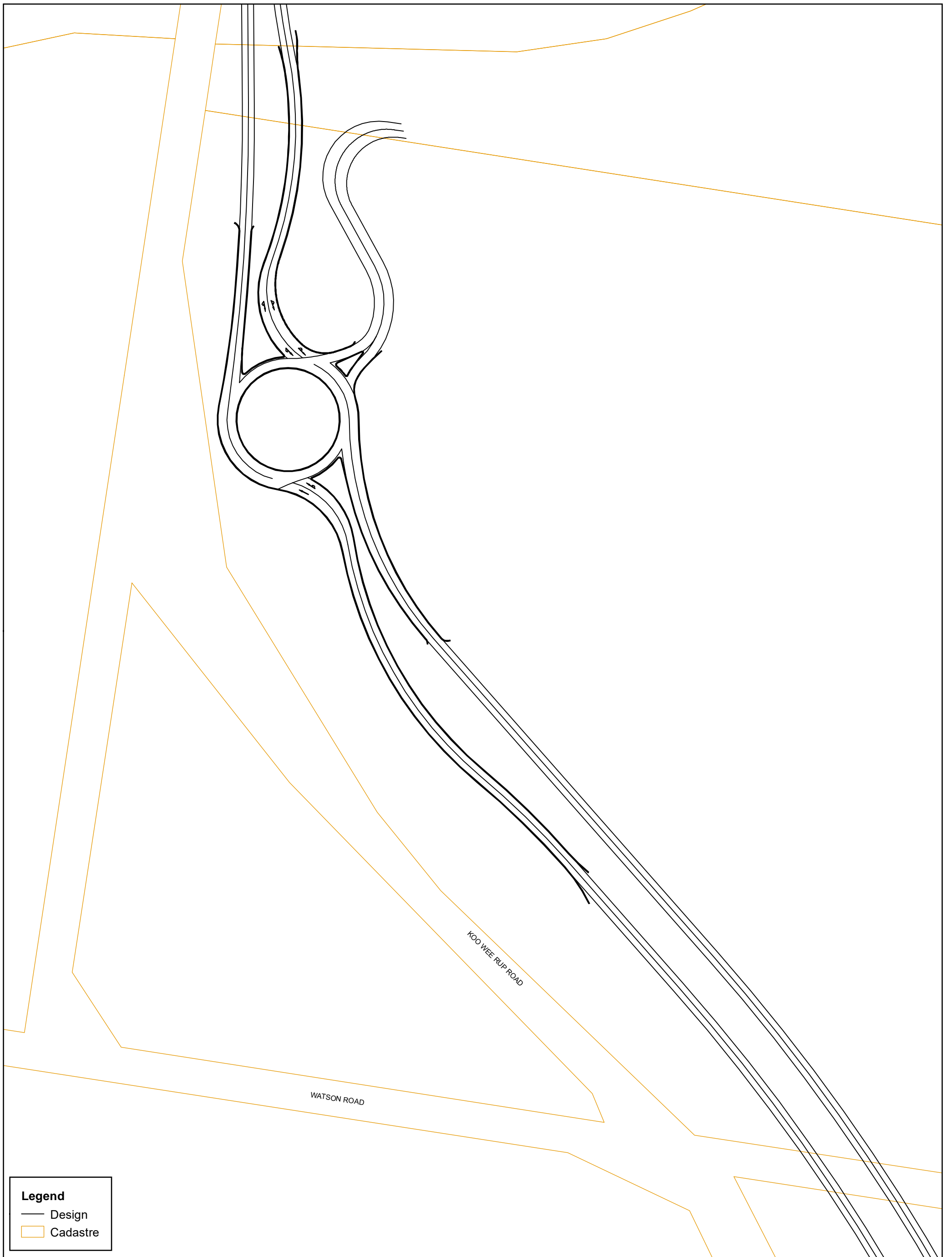

**Legend**

- Design
- ▭ Cadastre

Map: 2135645A_GIS_1532_A1	Author: MB		 1:2,000 Scale ratio correct when printed at A3	 	<b>Engineering and Technical Services for Healesville Koo Wee Rup Road Upgrade</b>
Date: 26/09/2018	Approved by: -				
<small>Data source: Copyright © The State of Victoria, Department of Environment, Land, Water &amp; Planning 2018 ID: 2135645A-SE-27-GIS-MAP-0001-A</small>			<small>© WSP   Parsons Brinckerhoff - Asia Pacific (WSP   PB). Copyright in the drawings, information and data recorded is the property of WSP   PB. This document and the information are solely for the use of the authorised recipient and this document may not be used, copied or reproduced in whole or part for any purpose other than that which it was supplied by WSP   PB. WSP   PB makes no representation, undertakes no duty and accepts no responsibility to any third party who may use or rely upon this document or the information. NCSI Certified Quality System to ISO 9001. © APPROVED FOR AND ON BEHALF OF WSP   Parsons Brinckerhoff - Asia Pacific.</small>		





**Legend**

- Design
- ▭ Cadastre

Map: 2135645A\_GIS\_1532\_A1

Author: MB



Date: 26/09/2018

Approved by: -



1:2,000

Coordinate system: GDA 1994 MGA Zone 55  
Scale ratio correct when printed at A3



**PRELIMINARY**

**Engineering and Technical Services  
for Healesville Koo Wee Rup Road Upgrade**

Preliminary design  
Map 7

© WSP | Parsons Brinckerhoff - Asia Pacific (WSP | PB). Copyright in the drawings, information and data recorded is the property of WSP | PB. This document and the information are solely for the use of the authorised recipient and this document may not be used, copied or reproduced in whole or part for any purpose other than that which it was supplied by WSP | PB. WSP | PB makes no representation, undertakes no duty and accepts no responsibility to any third party who may use or rely upon this document or the information. NCSI Certified Quality System to ISO 9001. © APPROVED FOR AND ON BEHALF OF WSP | Parsons Brinckerhoff - Asia Pacific.

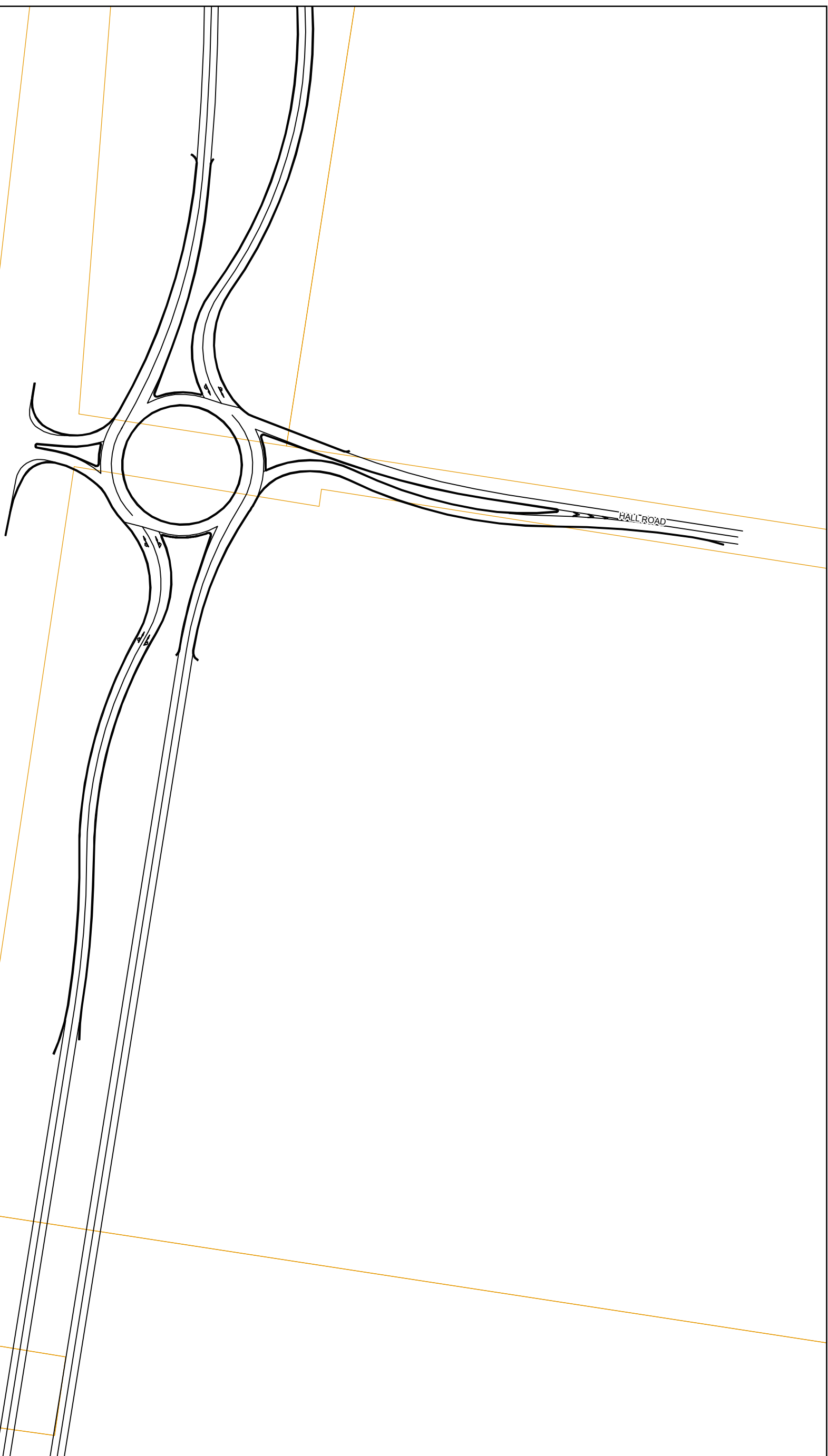

**Legend**

- Design
- Cadastre



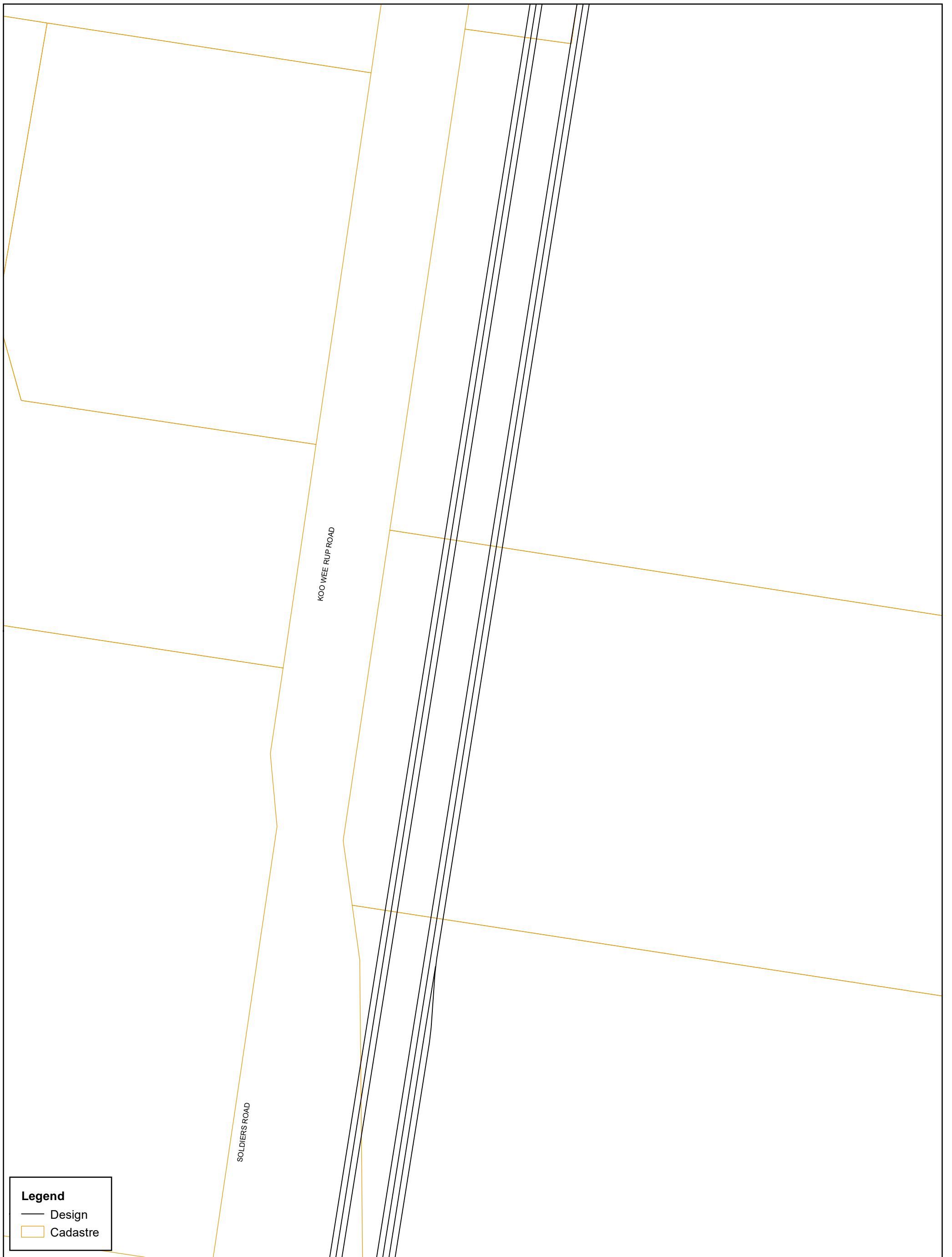

**Legend**

- Design
- Cadastrate

Map: 2135645A_GIS_1532_A1	Author: MB		 1:2,000 Scale ratio correct when printed at A3	 		<b>Engineering and Technical Services for Healesville Koo Wee Rup Road Upgrade</b>	<b>PRELIMINARY</b>	Preliminary design Map 9
Date: 26/09/2018 Approved by: -		<small>         Data source: Copyright © The State of Victoria, Department of Environment, Land, Water &amp; Planning 2018          ID: 2135645A-SE-27-GIS-MAP-0001-A          © WSP   Parsons Brinckerhoff - Asia Pacific (WSP   PB). Copyright in the drawings, information and data recorded is the property of WSP   PB. This document and the information are solely for the use of the authorised recipient and this document may not be used, copied or reproduced in whole or part for any purpose other than that which it was supplied by WSP   PB. WSP   PB makes no representation, undertakes no duty and accepts no responsibility to any third party who may use or rely upon this document or the information. NCSI Certified Quality System to ISO 9001. © APPROVED FOR AND ON BEHALF OF WSP   Parsons Brinckerhoff - Asia Pacific.       </small>						
<small>V:\pme\01\proj\WVicRoads\2135645A_OSAR_ENGINEERING_TECHNICAL_SEI10_GIS\Projects\Maps\2135645A_GIS_1532_A1.mxd</small>			<small>MRPA</small>	<small>www.wsp.com</small>				

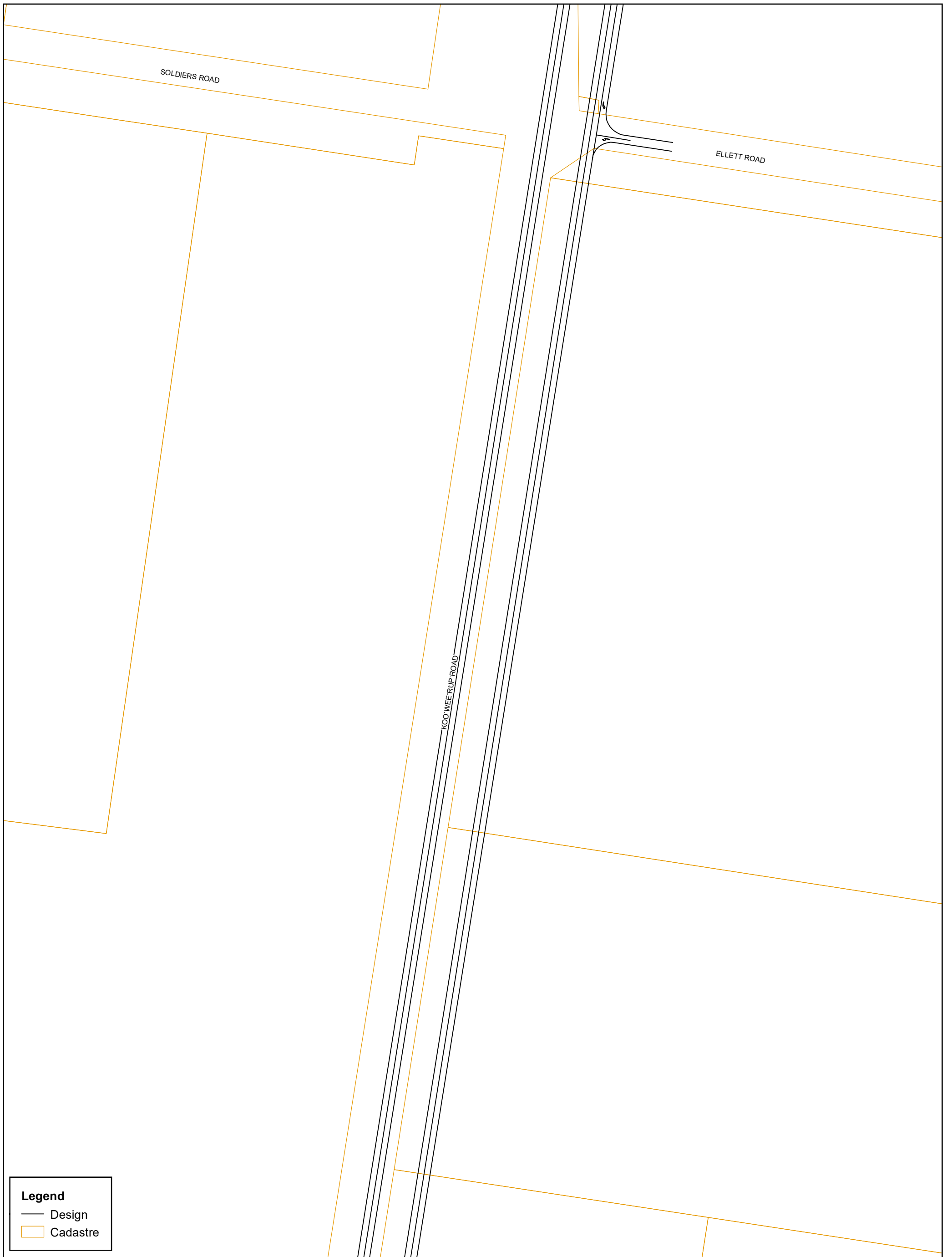

**Legend**

- Design
- ▭ Cadastre

Map: 2135645A_GIS_1532_A1	Author: MB		 1:2,000	 		<b>Engineering and Technical Services for Healesville Koo Wee Rup Road Upgrade</b>	<b>PRELIMINARY</b>	Preliminary design Map 10
Date: 26/09/2018	Approved by: -							
<small>Data source: Copyright © The State of Victoria, Department of Environment, Land, Water &amp; Planning 2018 ID: 2135645A-SE-27-GIS-MAP-0001-A</small>			<small>© WSP   Parsons Brinckerhoff - Asia Pacific (WSP   PB). Copyright in the drawings, information and data recorded is the property of WSP   PB. This document and the information are solely for the use of the authorised recipient and this document may not be used, copied or reproduced in whole or part for any purpose other than that which it was supplied by WSP   PB. WSP   PB makes no representation, undertakes no duty and accepts no responsibility to any third party who may use or rely upon this document or the information. NCSI Certified Quality System to ISO 9001. © APPROVED FOR AND ON BEHALF OF WSP   Parsons Brinckerhoff - Asia Pacific.</small>					
<small>\\apme01\proj\WVicRoads\2135645A_OSAR_ENGINEERING_TECHNICAL_SEI10_GIS\Projects\Maps\2135645A_GIS_1532_A1.mxd</small>			<small>MRPA</small>		<small>www.wsp.com</small>			

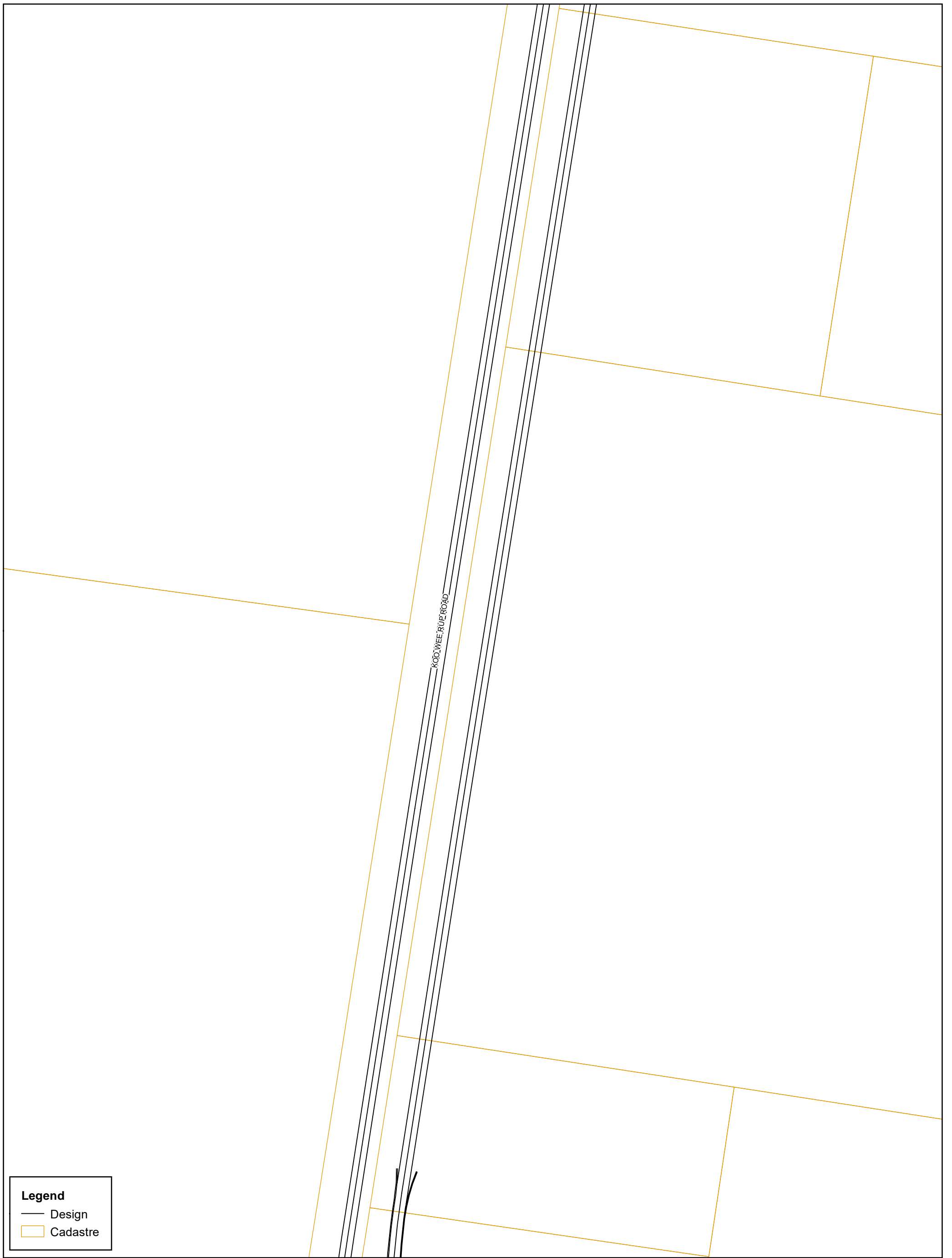

**Legend**

- Design
- ▭ Cadastre

Map: 2135645A\_GIS\_1532\_A1

Author: MB



Date: 26/09/2018

Approved by: -

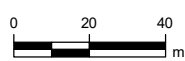

1:2,000

Coordinate system: GDA 1994 MGA Zone 55  
Scale ratio correct when printed at A3



**PRELIMINARY**

**Engineering and Technical Services  
for Healesville Koo Wee Rup Road Upgrade**

Preliminary design  
Map 11

© WSP | Parsons Brinckerhoff - Asia Pacific (WSP | PB). Copyright in the drawings, information and data recorded is the property of WSP | PB. This document and the information are solely for the use of the authorised recipient and this document may not be used, copied or reproduced in whole or part for any purpose other than that which it was supplied by WSP | PB. WSP | PB makes no representation, undertakes no duty and accepts no responsibility to any third party who may use or rely upon this document or the information. NCSI Certified Quality System to ISO 9001. © APPROVED FOR AND ON BEHALF OF WSP | Parsons Brinckerhoff - Asia Pacific.

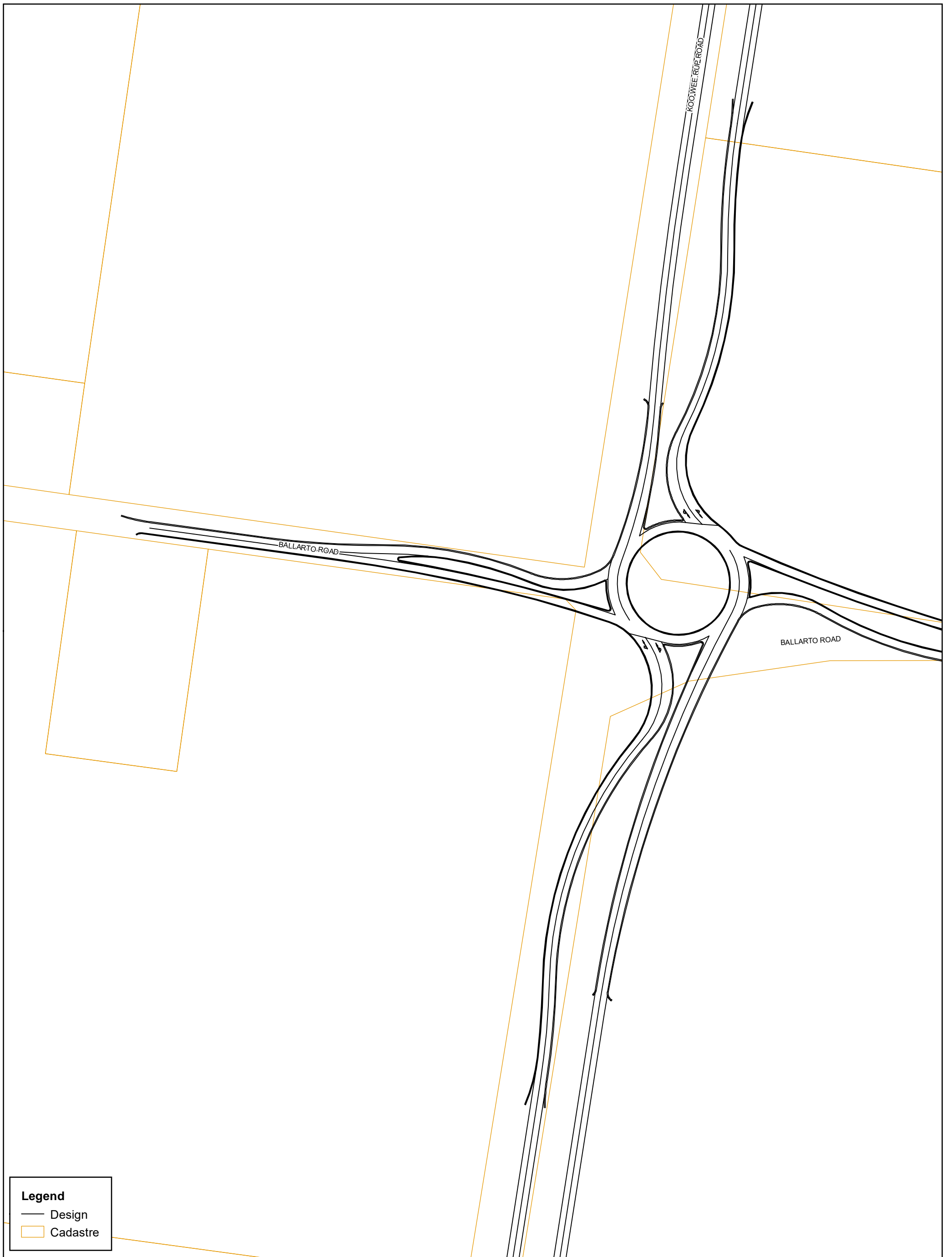

**Legend**

- Design
- Cadastre

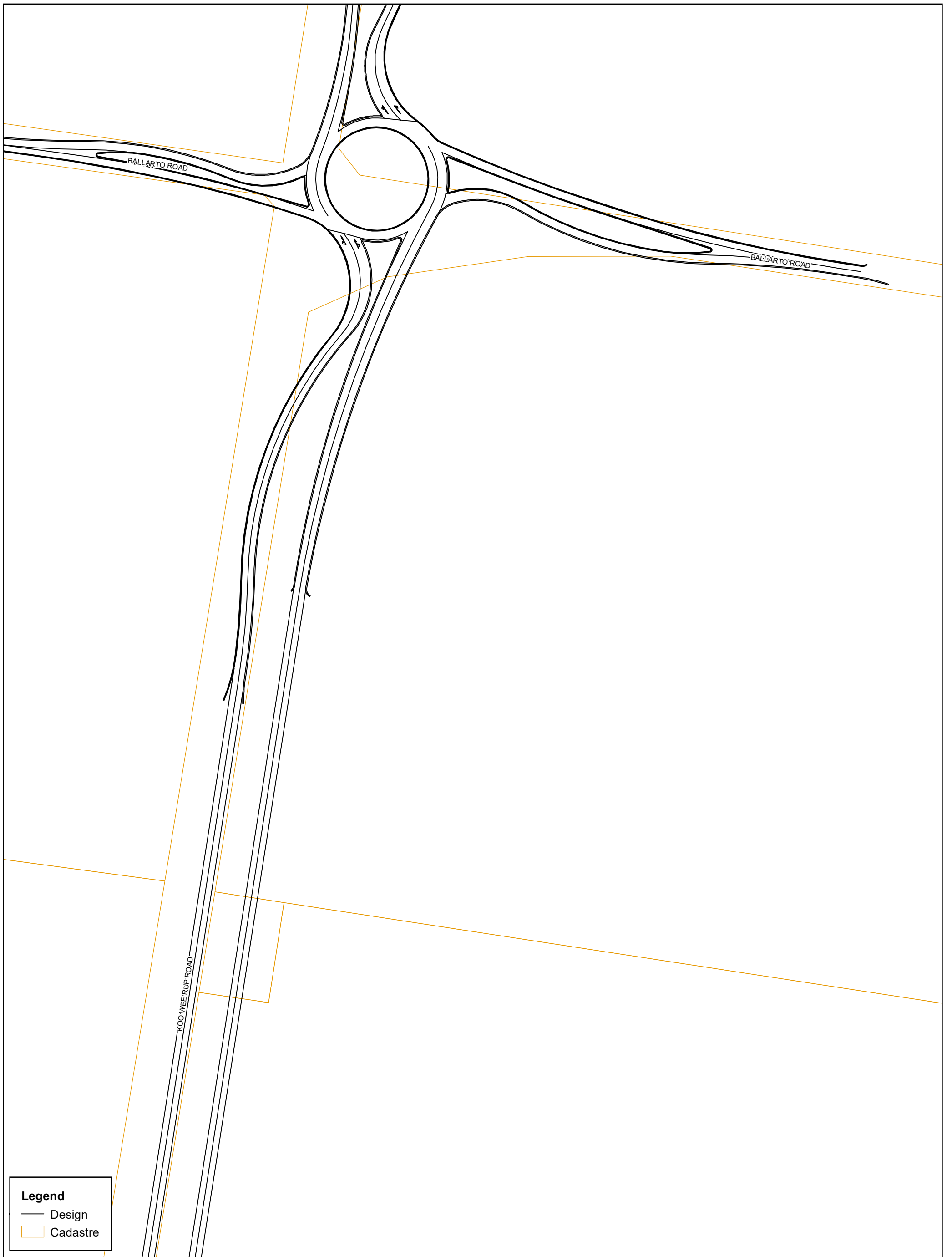

**Legend**

- Design
- ▭ Cadastral

Map: 2135645A\_GIS\_1532\_A1

Author: MB



Date: 26/09/2018

Approved by: -

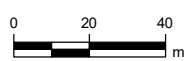

1:2,000

Coordinate system: GDA 1994 MGA Zone 55  
Scale ratio correct when printed at A3



**PRELIMINARY**

**Engineering and Technical Services  
for Healesville Koo Wee Rup Road Upgrade**

Preliminary design  
Map 13

© WSP | Parsons Brinckerhoff - Asia Pacific (WSP | PB). Copyright in the drawings, information and data recorded is the property of WSP | PB. This document and the information are solely for the use of the authorised recipient and this document may not be used, copied or reproduced in whole or part for any purpose other than that which it was supplied by WSP | PB. WSP | PB makes no representation, undertakes no duty and accepts no responsibility to any third party who may use or rely upon this document or the information. NCSI Certified Quality System to ISO 9001. © APPROVED FOR AND ON BEHALF OF WSP | Parsons Brinckerhoff - Asia Pacific.

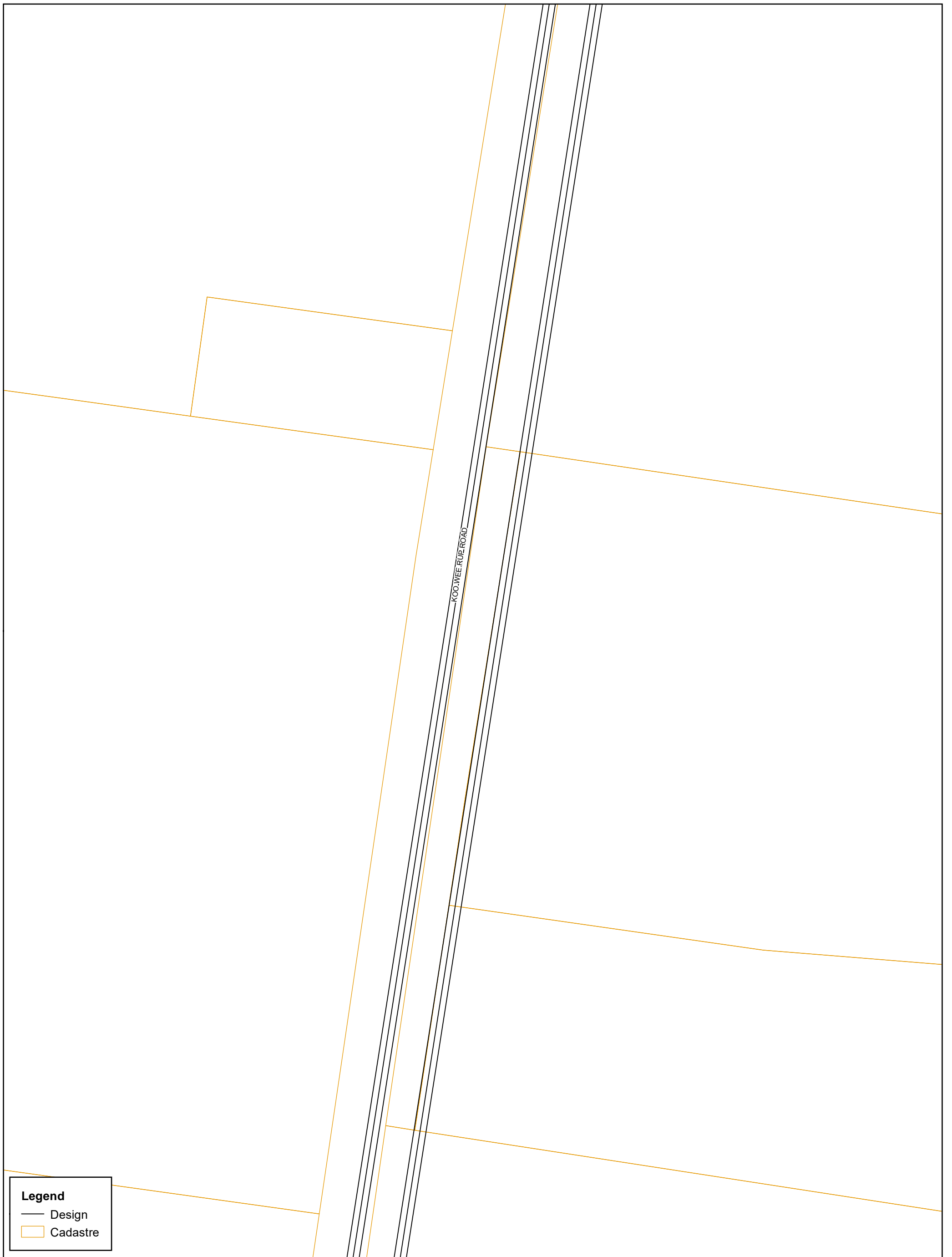

KOO WEE RUP ROAD

**Legend**

- Design
- ▭ Cadastre

Map: 2135645A_GIS_1532_A1	Author: MB		 1:2,000	 		<b>Engineering and Technical Services for Healesville Koo Wee Rup Road Upgrade</b>
Date: 26/09/2018	Approved by: -					
Data source: Copyright © The State of Victoria, Department of Environment, Land, Water & Planning 2018 ID: 2135645A-SE-27-GIS-MAP-0001-A			© WSP   Parsons Brinckerhoff - Asia Pacific (WSP   PB). Copyright in the drawings, information and data recorded is the property of WSP   PB. This document and the information are solely for the use of the authorised recipient and this document may not be used, copied or reproduced in whole or part for any purpose other than that which it was supplied by WSP   PB. WSP   PB makes no representation, undertakes no duty and accepts no responsibility to any third party who may use or rely upon this document or the information. NCSI Certified Quality System to ISO 9001. © APPROVED FOR AND ON BEHALF OF WSP   Parsons Brinckerhoff - Asia Pacific.			
\\Apme\01\proj\WVicRoads\2135645A_OSAR_ENGINEERING_TECHNICAL_SEI10_GIS\Projects\Maps\2135645A_GIS_1532_A1.mxd			MRPA		<a href="http://www.wsp.com">www.wsp.com</a>	



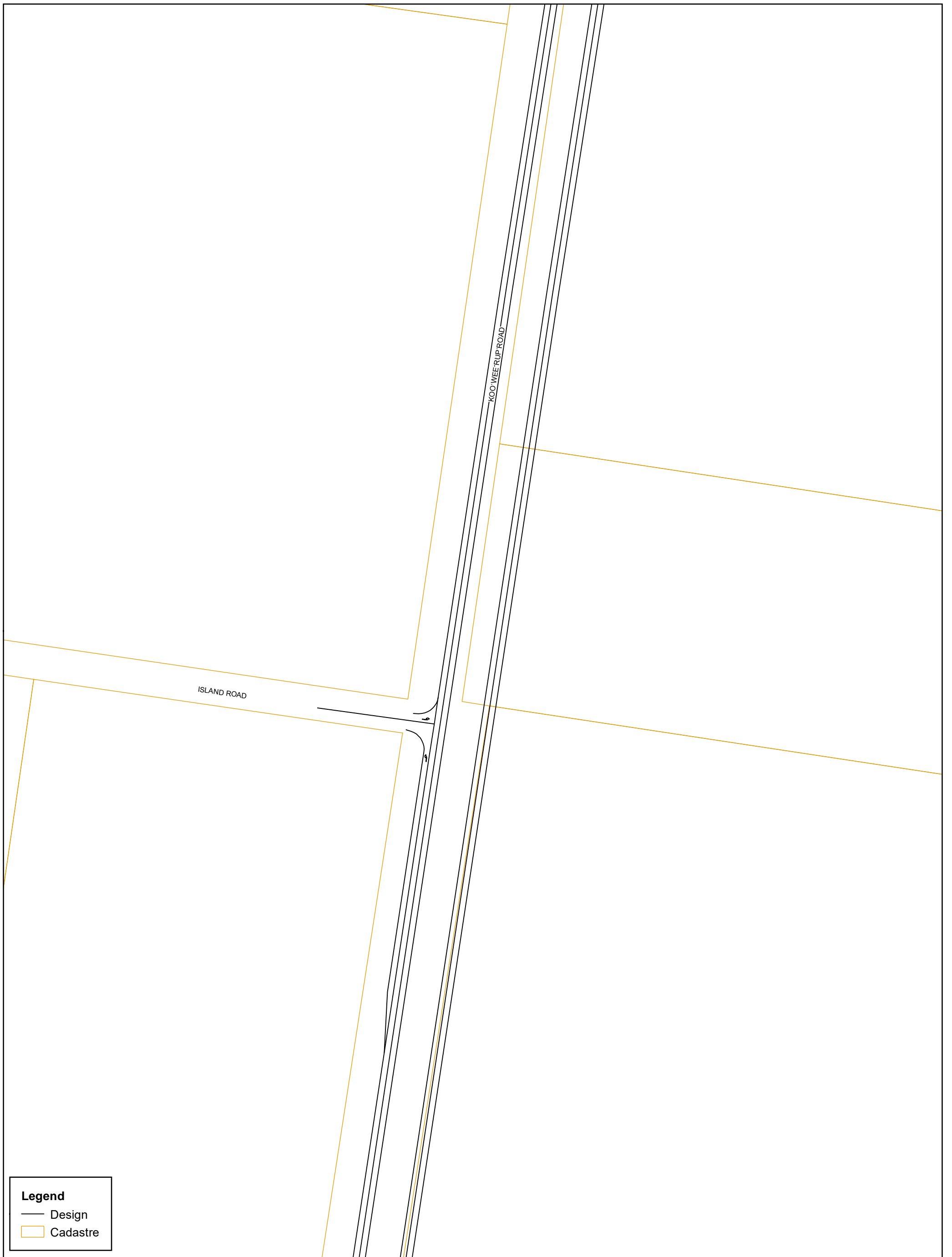

**Legend**

- Design
- Cadastrate

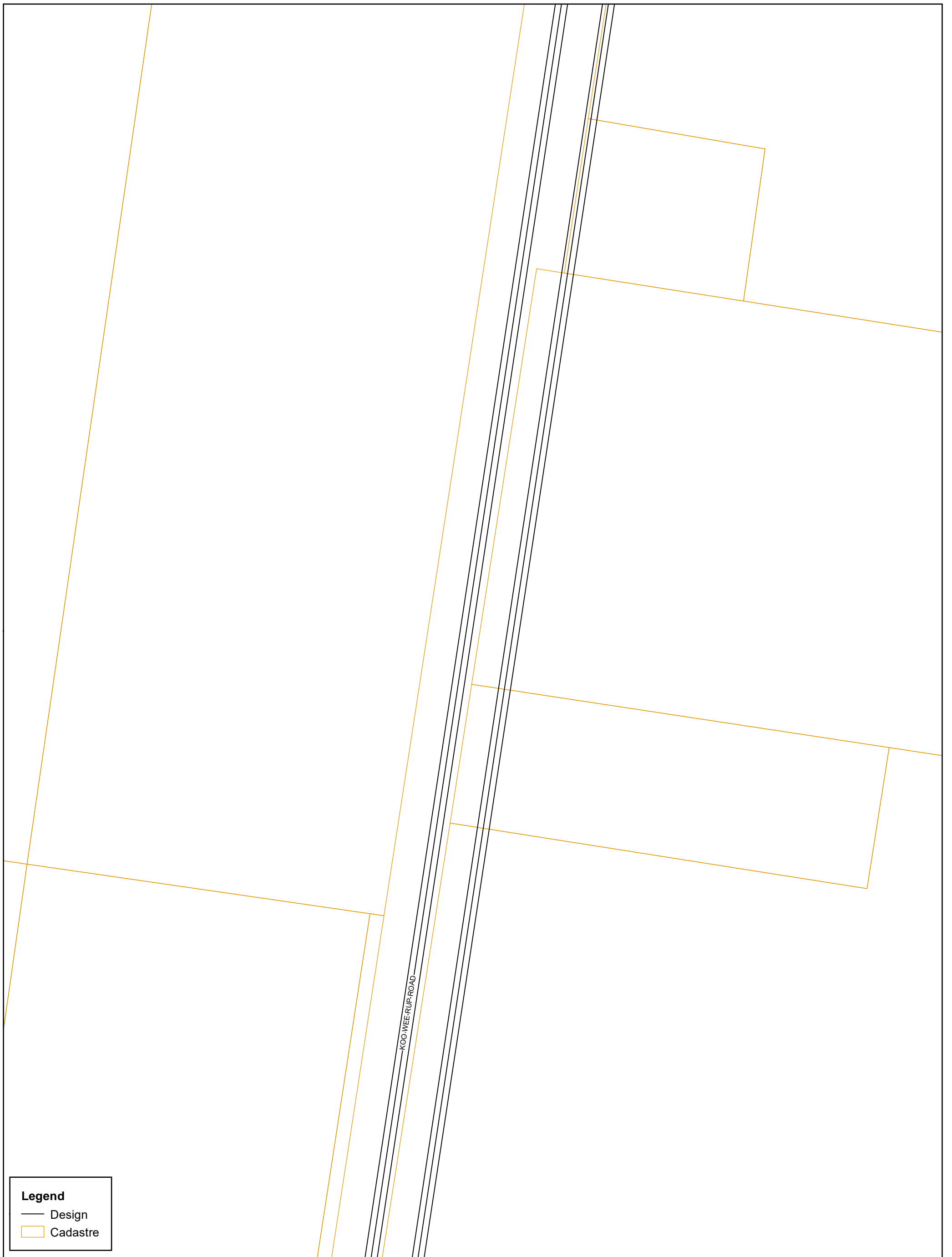

KOO-WEE-RUP ROAD

**Legend**

- Design
- ▭ Cadastre

Map: 2135645A_GIS_1532_A1	Author: MB		<p>1:2,000</p>		<p><b>Engineering and Technical Services for Healesville Koo Wee Rup Road Upgrade</b></p>
Date: 26/09/2018	Approved by: -				
<p>Data source: Copyright © The State of Victoria, Department of Environment, Land, Water &amp; Planning 2018 ID: 2135645A-SE-27-GIS-MAP-0001-A</p> <p>© WSP   Parsons Brinckerhoff - Asia Pacific (WSP   PB). Copyright in the drawings, information and data recorded is the property of WSP   PB. This document and the information are solely for the use of the authorised recipient and this document may not be used, copied or reproduced in whole or part for any purpose other than that which it was supplied by WSP   PB. WSP   PB makes no representation, undertakes no duty and accepts no responsibility to any third party who may use or rely upon this document or the information. NCSI Certified Quality System to ISO 9001. © APPROVED FOR AND ON BEHALF OF WSP   Parsons Brinckerhoff - Asia Pacific.</p>					
<p>\\apme01\proj\WVicRoads\2135645A_OSAR_ENGINEERING_TECHNICAL_SEI10_GIS\Projects\Maps\2135645A_GIS_1532_A1.mxd</p>				<p>MRPA</p>	<p>www.wsp.com</p>

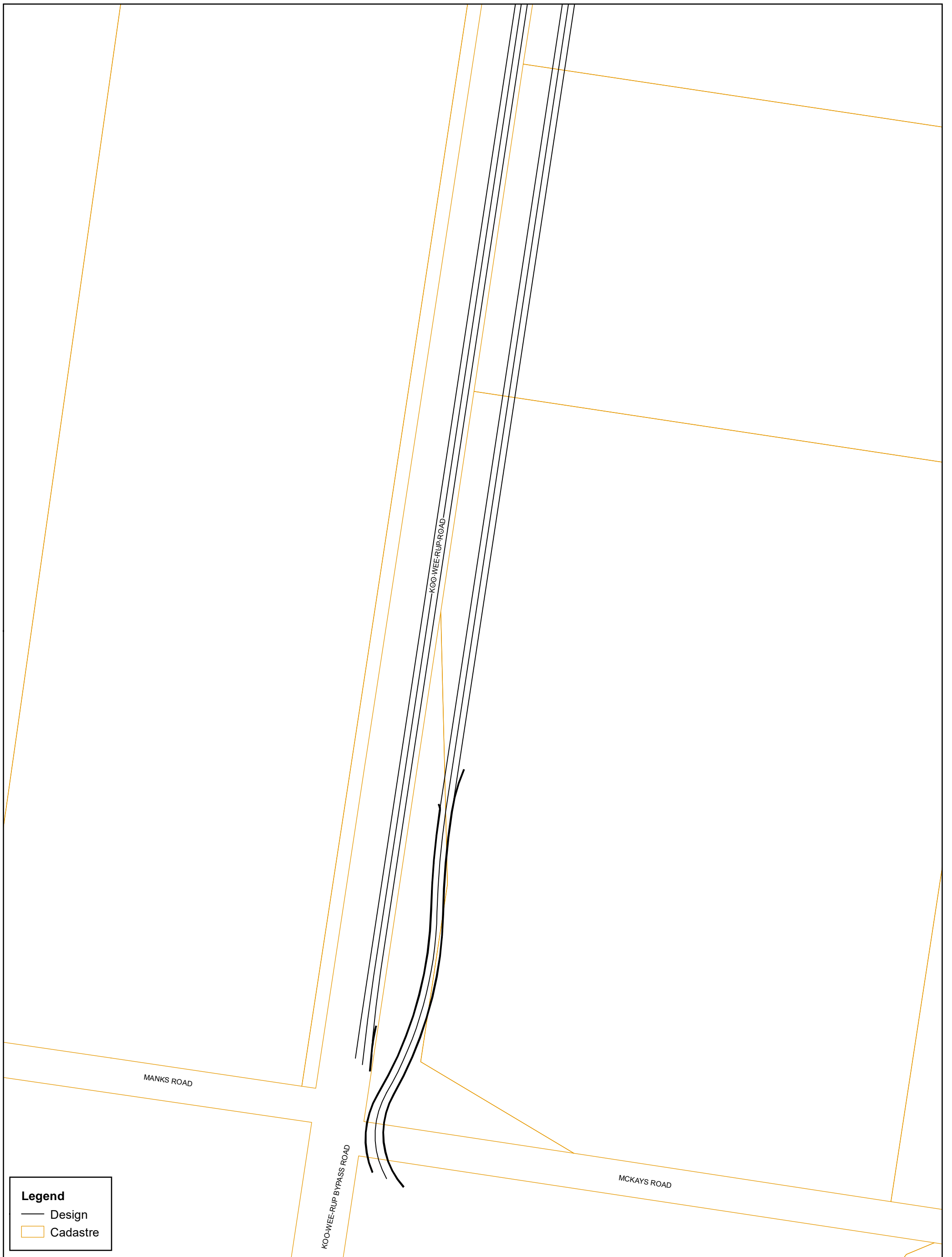

**Legend**

- Design
- ▭ Cadastre

Map: 2135645A_GIS_1532_A1	Author: MB		 1:2,000 Scale ratio correct when printed at A3	 		<b>Engineering and Technical Services for Healesville Koo Wee Rup Road Upgrade</b>  <div style="display: flex; justify-content: space-between; align-items: center;"> <span style="font-size: 2em; color: red; font-weight: bold;">PRELIMINARY</span> <span>Preliminary design Map 17</span> </div>
Date: 26/09/2018	Approved by: -					