

Recommended Approach

Part F

Lorimer

Projections for Lorimer show a dwelling density of 270 per hectare with a comparatively high residential density of 538 people per hectare. The worker density is expected to be slightly lower than other precincts at 201 per hectare resulting in a combined density of 739 people. Housing stock is expected to attract a similar demographic to Montague of singles and couples.

Structure

Neighbourhoods

Lorimer has been notionally divided into two neighbourhoods: LN1, LN2

Centres

- 2 local centres
- 2 neighbourhood centres

Open space

- 3 pocket parks
- 2 neighbourhood squares

Living streets zones, urban space zones, shared boulevard

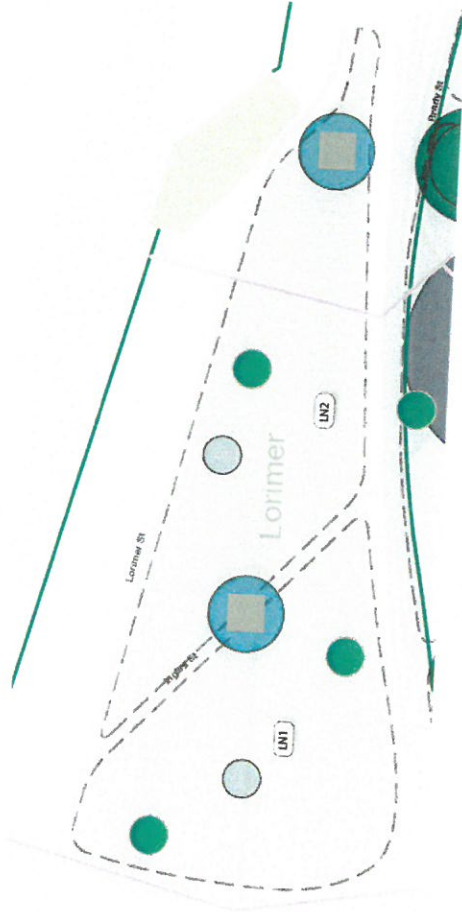

Illustrative Community Infrastructure

- Individual residential lot boundary
- Living streets and cycle network
- Urban space zones of boulevard
- City - 14.0m park, 0.2ha
- Large park 2ha
- Small park, 0.1ha
- Pocket park 0.25ha
- Primary square 0.1ha
- Secondary square 0.2ha
- Neighbourhood square 0.25ha
- Primary centres
- Secondary centres
- Neighbourhood centres
- Local centre