

Brunswick Street North – between Holden Street and Scotchmer Street

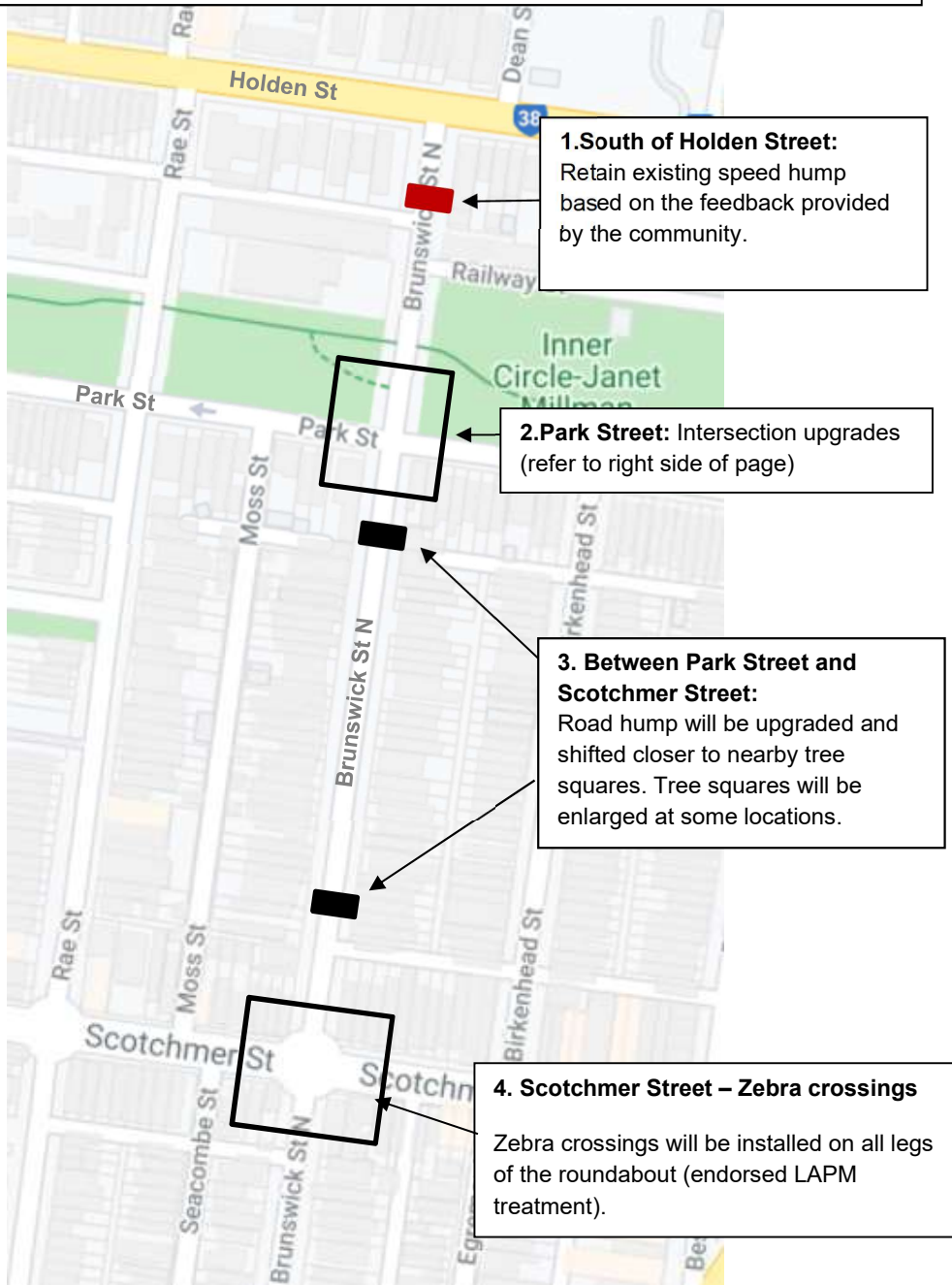

Park Street and Brunswick Street North

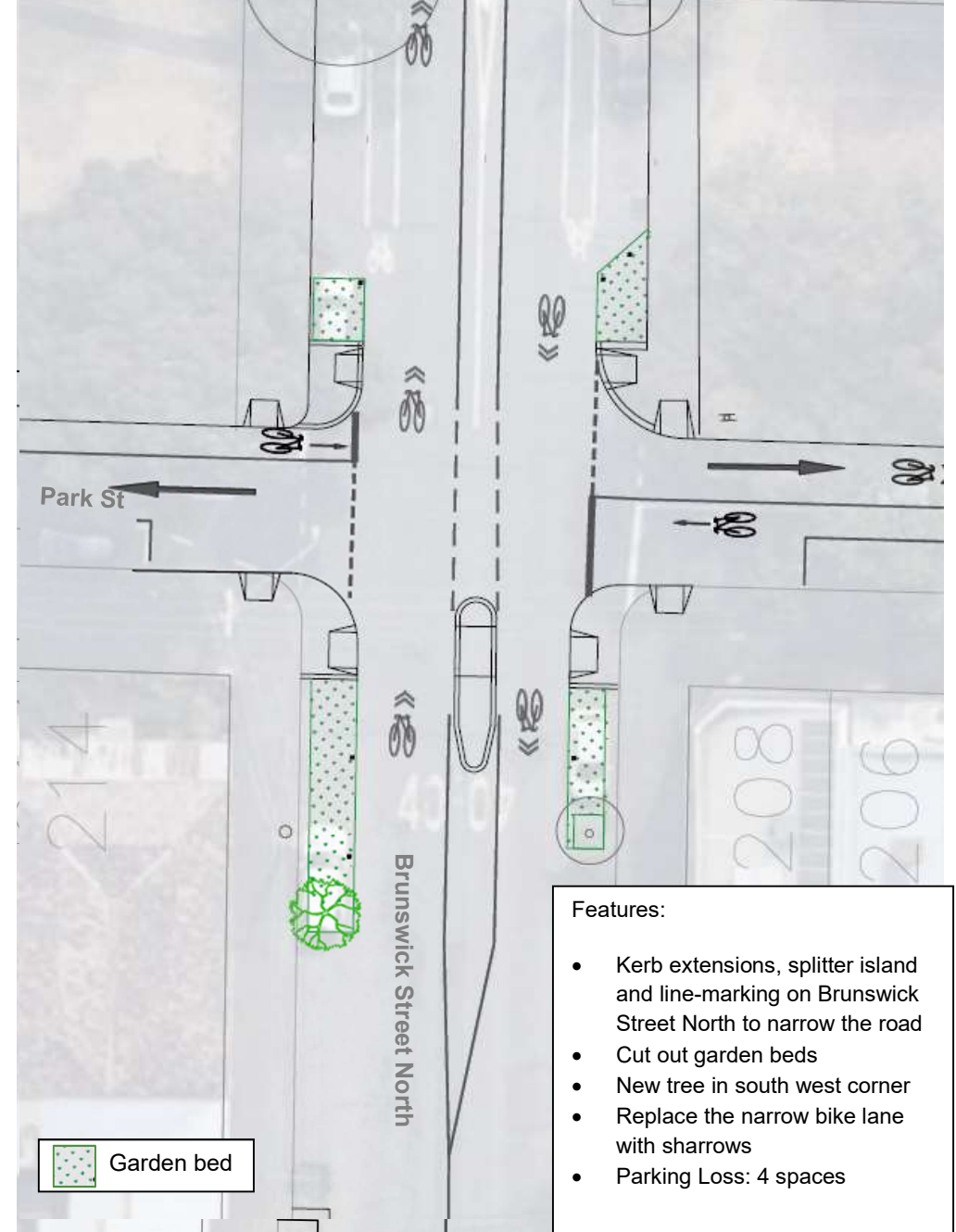

Brunswick Street North – between Scotchmer Street and St Georges Rd



5. Tramere Street: Intersection and road hump upgrades (refer to right side of page)

6. Reid Street and St Georges Road
Sharrows at the intersection

Tramere Street and Brunswick Street North

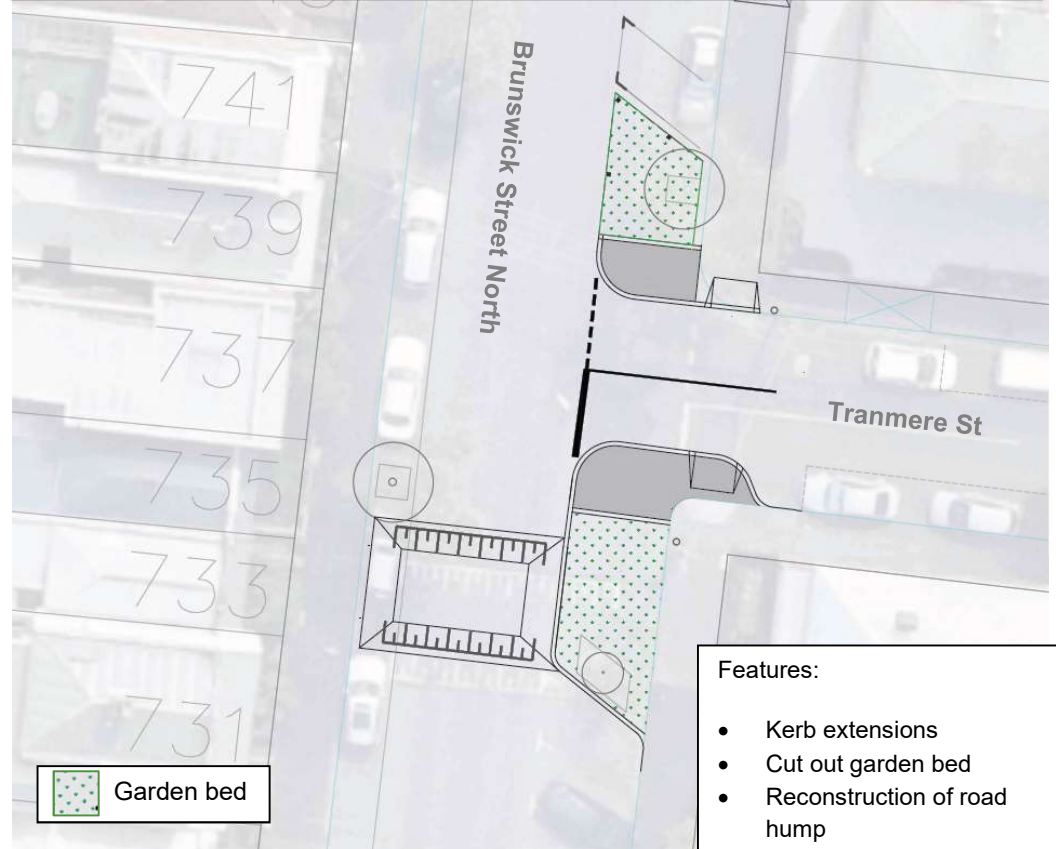

- Features:**
- Kerb extensions
 - Cut out garden bed
 - Reconstruction of road hump
 - Barrier kerb at the garden bed next to the road hump to prevent cars overrunning
 - No parking loss –one parallel bay converted to angle parking bay.



Example of cut out garden bed