

# We're working in your area

## Harewood Road - traffic signals and water upgrades (Night works notification)

What	We're working at night to install watermain infrastructure at two locations as part of the Harewood Road traffic signals and water upgrades work. This work includes new water connections which will require a temporary water shut-off.
Why	This work is part of the Harewood Road traffic signals and water upgrades work. We're undertaking this work at night when water usage is at its lowest.
Where	Harewood Road, Gardiners Road and Breens Road intersection, and Waimakariri Road and Whitchurch Place.
When	14 December 2025 to 18 December 2025, Sunday to Thursday, 7pm-7am (in addition to ongoing daytime work).
Contact	The contractor is Isaac Construction. Phone Elizabeth Mullan (Communications Advisor) on 027 406 2465 or 0800 472 222 or email <a href="mailto:communications@isaac.co.nz">communications@isaac.co.nz</a> .

### Details

We're working on the watermain at the intersection of Harewood Road, Gardiners Road and Breens Road, and on Waimakariri Road and Whitchurch Place at night from 7pm on Sunday 14 December to 7am on Thursday 18 December 2025.

We know this work can be disruptive, and we appreciate your cooperation and understanding.

### Traffic Impacts

- **Between 7pm and 7am** two-way stop-go traffic management will allow traffic from one direction to travel through the Harewood Road, Gardiners Road and Breens Road intersection at a time.
- This will reduce the volume of traffic. Please allow extra time to avoid delays.
- Temporary traffic lights will be set up for the stop-go system at 387 Harewood Road and at 436 Harewood Road.
- The traffic management in place on Waimakariri Road and Whitchurch Place will remain the same for night and day work. Two-way traffic will be maintained, and on-street parking will be restricted.
- The traffic management already in place will not change for the night works:
  - There will be no vehicle access to Harewood Road from Gardiners Road or to Gardiners Road from Harewood Road.
  - There will be no vehicle access to Harewood Road from Breens Road or to Breens Road from Harewood Road.
  - There will be no access to Harewood Road from Waimakariri Road for left turning vehicles.
  - Speed will remain reduced to 30km/h through the sites.
  - There will be no on-street parking available for the duration of this work.

## Thanks for your patience as we work in your area



### Noise

There may be increased noise, dust and vibrations during work but it shouldn't impact on your power, water, gas or phone services



### Safety

Safety is our biggest priority so please keep children and pets away from worksites.



### Bins

Please put your bins out as usual before 6am on your collection day. Our crew will move and return them if needed.



### Other projects

Learn more about our work.

[ccc.govt.nz/works](https://ccc.govt.nz/works)

# We're working in your area

## Water Shut-offs

- Some properties will experience a temporary water shut-off during the night works. If your property is impacted, you will receive a notice about this prior to the work starting.

## Impacts of Night Works

- We aim to complete the noisier work early in the evening.
- The nature of the work that we are doing will generate noise, dust and vibrations.
- Pedestrian detours will be in place, please adhere to signage.
- Access to residences and businesses may be briefly impacted at times, our crew will make access available as soon as possible. Please advise us if you have any specific property access requirements e.g. medical visits, large deliveries, home help and any planned works.
- Please put your bins out as usual by 6am on your collection day. Our team will move them and return them, if needed.

See below maps of the areas that we will be working in.

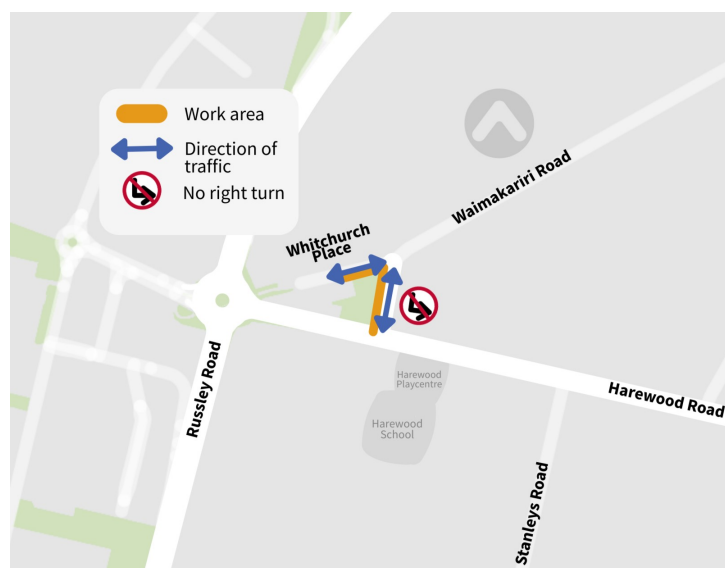
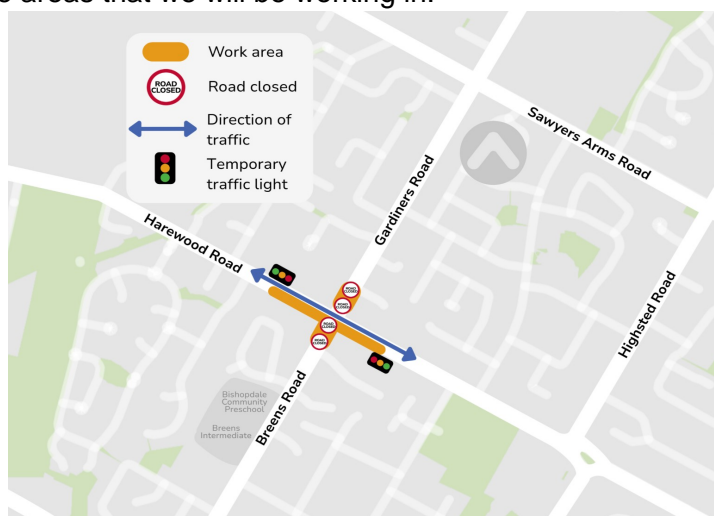

## Thanks for your patience as we work in your area



### Noise



### Safety



### Bins



### Other projects

There may be increased noise, dust and vibrations during work but it shouldn't impact on your power, water, gas or phone services

Safety is our biggest priority so please keep children and pets away from worksites.

Please put your bins out as usual before 6am on your collection day. Our crew will move and return them if needed.

Learn more about our work.

[ccc.govt.nz/works](https://ccc.govt.nz/works)

