

Installation Manual



Notes

- This fitting requires DC 24V input ONLY and it must NOT be connected to 240VAC/50Hz supply.
- While connecting multiple fittings together, proper attention should be given towards polarities-refer to Fig.4.
- Electrical Wiring and installation should always comply to the applicable local standards.
- We recommend that all low voltage cables should be run in flexible conduit for extra protection. Where extra cable is required, please source and use the equivalent cable only.
- Wherever applicable- waterproof cable joints (junction boxes or heavy walled adhesive lined heat shrink) must be used, or warranty is void.
- Do not install any inductive loads such as exhaust fans or pond pumps etc. within the same lighting circuit of this fitting. Issues caused by such wirings are not covered under our warranty policy.
- Do not open or interchange any parts of this fitting or the warranty will be void.
- The fitting may be hot to touch after continuous use.
- If you have any questions about the installation of this product, please contact Mondolux at 1300 601 931.

Care & Refinishing

Mondolux strongly recommends following cleaning procedures to maintain proper finish of the product.

- Do not use bleach or concentrated solvents under any circumstances.
- For Black finish: Wipe gently with a soft damp cloth or chamois. Do not use any abrasive compounds.
- Stainless Steel finish: Clean regularly using a soft brush with diluted detergent and warm water. Do not use bleach or any abrasive compound.

Optional Accessories

Cento Deck Light range has following optional accessories to suit different lighting and control method requirements.

- Cento deck lights comes with a non-dimmable integral 24V DC-DC driver with basic ON/OFF control only*

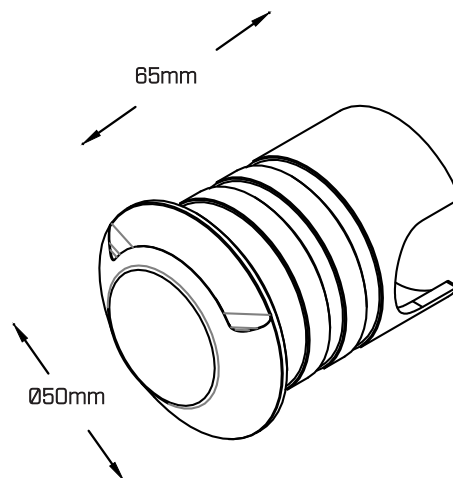

*For specific accessory order details and installation guidelines, please contact Mondolux at 1300 601 931.

Installation Steps

1. Ensure the mains power to the power supply is turned off and plug is removed, and secondary voltage is completely discharged.
2. Mark and cut the required hole in the wall/surface using the cutout dimensions given. See picture 1.
3. Pull the front panel out and secure the back recessed mounting box into the wall /surface using suitable plastering or other methods. See picture 3.
4. Pass the power supply cable through the recessed mounting box. See picture 3.
5. As per the electrical wiring/ lighting layout, prepare the required additional wiring to connect the designated fittings in parallel i.e., all (+)vs. and (-)vs. of the fittings should be wired together and connected to the positive and negative terminals respectively on the secondary side of the power supply as shown in Fig. 4.
6. Pay close attention to the polarities of the fittings while connecting them parallelly to avoid any mis wiring. See picture 4.
7. Connect the wires on the supply side to the respective terminals of the driver using the adhesive lined heat shrink provided. See picture 3.
8. Don't forget to crimp these heat shrinks on both ends to ensure proper watertight connections. See picture 3.
9. Once securing the connections in this way, place the front panel into the recessed box. See picture 5
10. Installation is complete. Turn the mains on. See picture 5.

