

Line Learning Adjustment

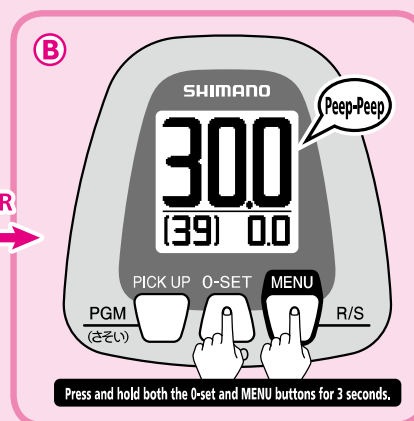

Set the target depth more accurately by correcting the discrepancy between the depth shown on the display and the markings on the line.

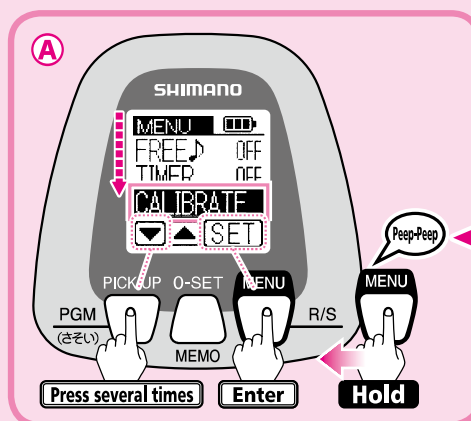
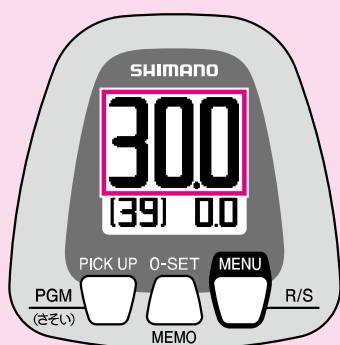

- 1 Effective at a depth of more than 10m. Round up the present depth displayed to a convenient number (round decimal points to 0) to easily match it with the markings on the line. The color of the line changes every 10m.

* More accurate adjustment is possible at depths greater than 100m, such as when the display changes from 199m to 200m.

- 2 Enter Line Learning Adjustment using either A or B.

There are two methods for making adjustments. The same adjustments can be made using either method.

A From the Menu Screen

Press and hold the **MENU** button for 3 seconds and the Menu Screen will appear. Press **▼** several times and select **CALIBRATE** and press **SET**.

(See pages 12 for details regarding Menu Screen operation.)

B Using the buttons

Press and hold both the **O-SET** and **MENU** buttons for 3 seconds to enter Line Learning Adjustment.

You will hear two short beeps.

※ When using this method, after calibration is completed you will return to the Water Depth Display.

(Continued on the next page.)

Caution: The values and settings shown on the reel display in this manual are in some cases just examples. Actual values may differ.

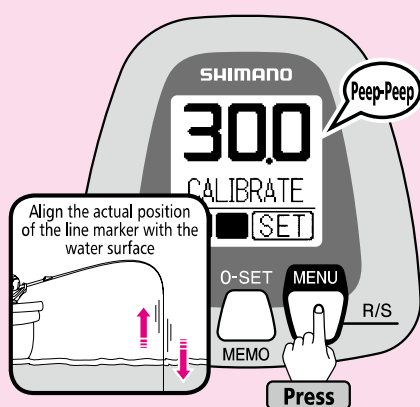

3 Adjust the display to match the actual position of the line (30m in this example) on the surface of the water.

* Using the motor (winding in the line or hooking a fish, etc.) will also cancel the adjustment. When that happens, the previous adjustment setting will be used.

Press MENU to complete the adjustment. The alarm will sound (peep-peep). The display will return to Standard Mode and the adjusted depth will be shown on the display.

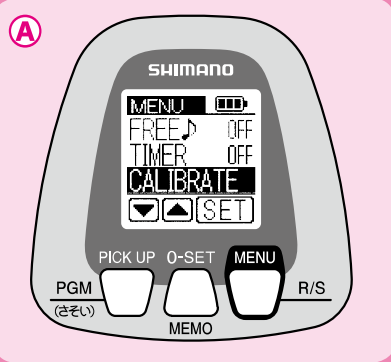

A From the Menu Screen

After the calibration is complete you will return to the Menu Screen.

Select RETURN on the Menu and you will return to the Water Depth Display and the calibrated water depth will be shown.

Even if the power is turned OFF, Line Learning changes will be saved.

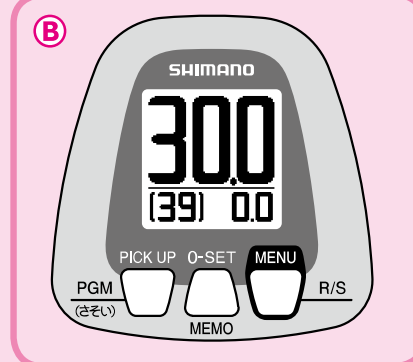

B Using the buttons

After the calibration is complete you will return to the Water Depth Display.

The calibrated water depth is shown on the Current Water Depth Display.

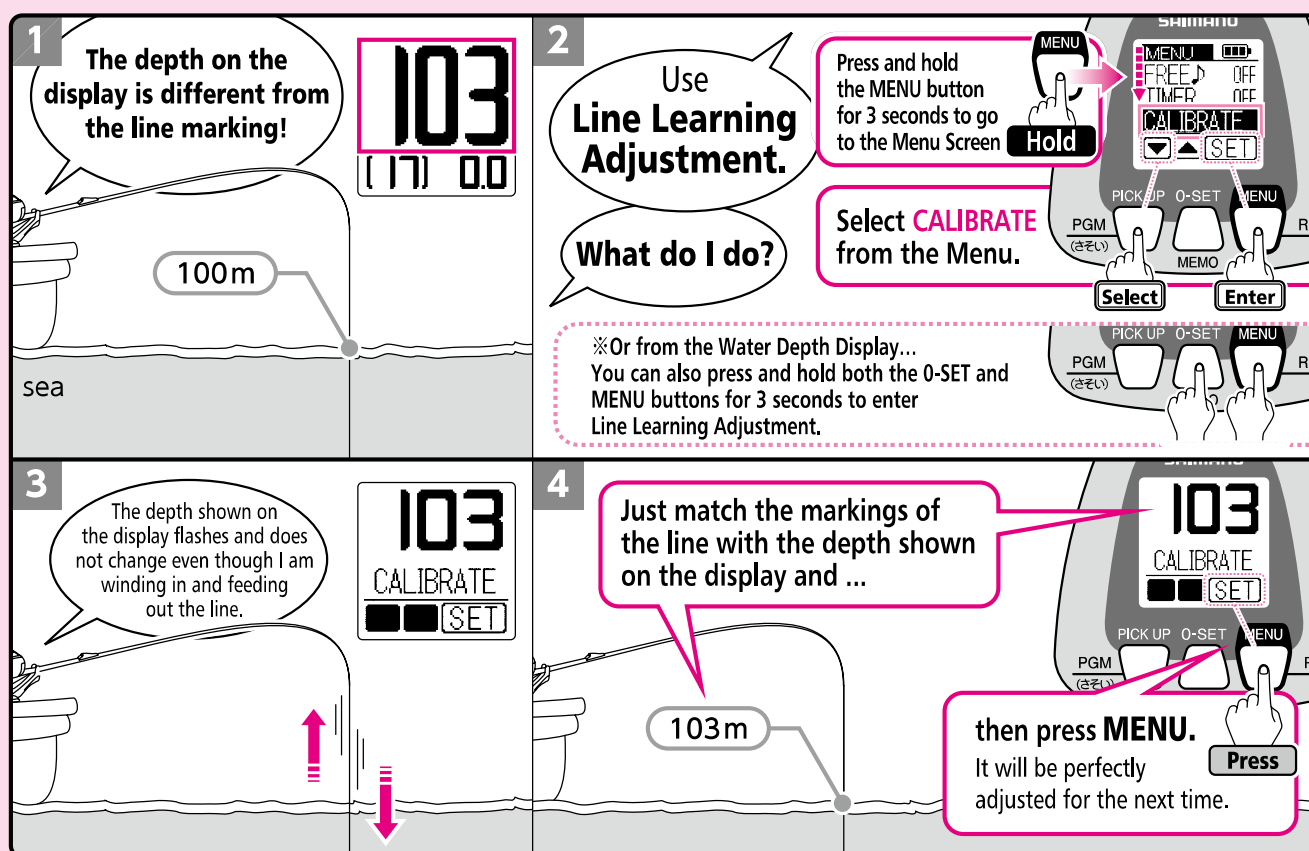

Handling Instructions

This reel consists of precision electrical components. Please read and follow the instructions below. Proper maintenance after every fishing trip is recommended to ensure that you will be able to enjoy using the reel for many years to come.

1 Caring for Your Reel

- * Remove the power cord and make sure that the reel has completely cooled down before you start any maintenance.

1. Tighten the drag.

2. Wash the outside of the reel with water, using a wet sponge to remove any dirt.

- * Do not immerse the reel in water.

3. Disengage the clutch to let out 2~3m of line while washing between the spool and reel to get rid of the salt as shown in the diagram.

4. Loosen the drag completely and leave the reel to dry in a shady place.

- * Wash or lightly brush the alligator clips using freshwater to get rid of any impurities from seawater.

* Salt Build-Up in the Bearings

S A-RBs (Shielded AntiRust Bearings) are made from corrosion-resistant material. However, that does not entirely prevent saltwater from entering the bearings and leaving a build-up of dried salt. They will not rust, but the rumbling sound that accompanies this build-up will sound the same as if they were rusty. The remedy for this will depend on the extent of the build-up, but you can either remove the SA-RBs and rinse them with fresh water to remove the salt, or replace the SA-RBs. It is recommended that you have the SA-RBs maintained regularly.

- * Please detach the power cord from the reel when in storage.

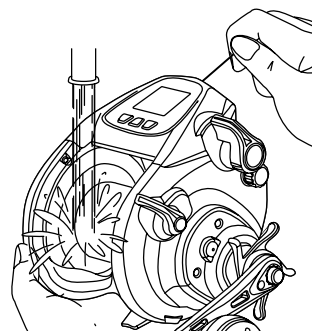

2 Cleaning Your Reel

(When you notice a deterioration in spool rotation.)

- If the spool is not rotating as smoothly as usual even after normal maintenance then this may indicate that there is a build-up of salt in the bearing near the handle.

* Remove the power cord.

1. Carefully immerse the reel in freshwater up to spool as shown in the diagram. Do NOT immerse the whole reel. Rotate the spool to dissolve the salt and regain performance.

Immerse up to this point.

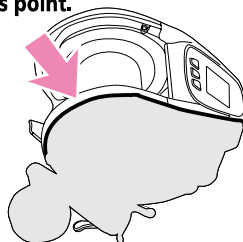

2. Remove the reel from the water and hold it up with the connector side facing down to ensure that the water completely drains from inside the reel.

If that does not improve the situation, please contact your nearest sales office to have the reel overhauled.

3 Precautions

- One of the characteristics of powered reels is that even though the motor is ON, sometimes line will not get wound in if a fish is hooked because the drag is slipping. This is similar to an automobile going along with the handbrake on. If this goes on for a long time, then the grease in the drag will be burn off and eventually the drag will burn out. Take care not to allow this to happen as it could destroy the entire reel.
- When the line is caught, do NOT exert excessive force on the rod or reel. Instead, please cut the line after taking care to minimize the amount of line left in the fishing ground.
- Please take care when handling the reel. Never throw it in your bag or allow it to bang against other items during transportation.
- NEVER drop or hit the reel. Treat it carefully.
- Take care not to hit the back of the reel or bend the power cord when putting the reel into a rod stand. Take special care not to trap the power cord between the reel and the gunwale.
- Some types of polarizing sunglasses make it difficult to properly view the display.
- After winding in a heavy load, take care when dropping the rig and winding it in the next time as the rig may get tangled with the tip of the rod.
- If the resin footing of the reel is secured to a metal reel mount, this may damage the resin and can ultimately damage the whole reel. Please make sure the resin protector is properly in place when attaching the reel to a metal mount.

(Continued on the next page.)

4 Maintaining Your Reel

- **Regular Maintenance - Please contact your nearest service center.**

The condition of the reel is greatly influenced by not only frequency of use, but also the environment in which it is used, how it is used and the target species. If any abnormality is detected, please contact your nearest service center through the place of purchase immediately. A regular professional maintenance check once every six months is highly recommended.

- Always remove the power cord from the reel before storing it.
- Place the protective cap on connectors when the reel is not in use.
- NEVER try to disassemble the reel as this can damage internal electrical components such as the motor and circuit breaker and may cause the reel to malfunction.
- NEVER oil the drag mechanism as this may decrease performance.
- Leaving the reel in high temperature, high humidity conditions for a long period of time may cause deformation or weakness. Always store in a cool, dry place after carrying out regular maintenance.
- NEVER immerse the entire reel in water, especially the display. (Although the display is shower proof it is best to avoid immersing it in order to prevent any trouble.

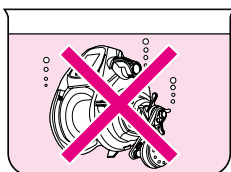

- **Removing the handle.**

1. Undo the two screws to remove the plate from the handle.
2. Undo the bolt inside the handle.

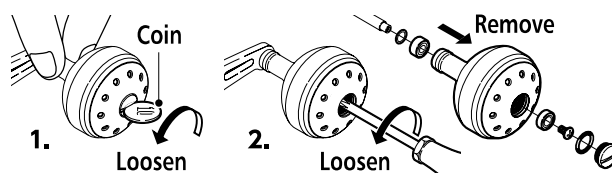

● Attaching the rod clamp

Set the reel on the rod, fit the rod clamp onto the rod from underneath and fasten with the clamp nuts.

※ 1: Clamp nut washers

If the diameter of rod is narrow, the clamp bolt will stick out from the clamp nut and you will not be able to tighten the nut with the included reel wrench. In this case, use a clamp nut washer.

※ 2: When fastening the clamp bolts with 8mm hex nuts, a certain amount of looseness is part of the design.

That looseness is necessary during attachment to the rod and is not a defect. The looseness will disappear when the reel is has been firmly attached so there is no need for concern.

Caution

- When attaching the rod clamp, make sure the rod's reel seat has sufficient strength before attaching.
- Use a standard 8mm hex nut wrench to tighten the 8mm hex nuts.

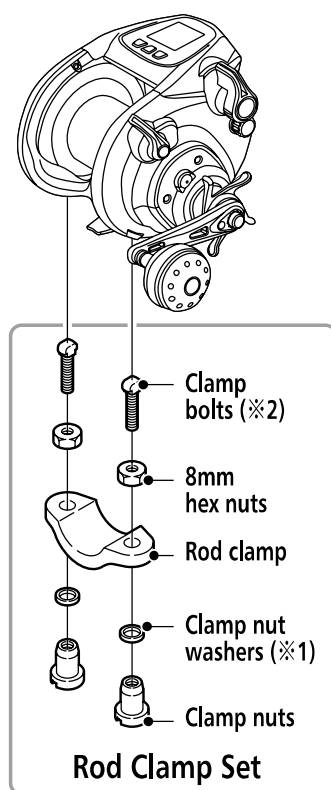

(Continued on the next page.)

5 Safety Features

• Automatic Circuit Breaker

The motor will turn ON and OFF at 1 second intervals if there is excessive load on the reel. This is normal. When that happens, the circuit breaker will trip and the display will flash. Leave it flashing for 5 minutes to protect the motor. Learning data will be saved even if the line is wound in or fed by hand. The motor will start to operate again when the flashing stops.

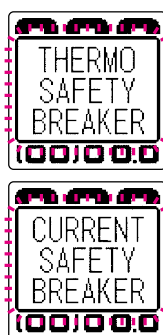

Caution:

- When the breaker has been tripped, it will not be deactivated by turning the power off and on again.
- Depending on the type of breaker action, it will take between 30 seconds and 3 minutes for the breaker to deactivate.

• Battery Status Display

When battery voltage drops below 10.5V (13.5V for the lithium-ion battery), or when the power cord is not properly connected, the battery icon on the display will flash. Check the connection first. If there is no problem with the connection then the battery will need to be charged.

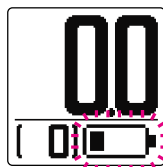

• Technical Lever Breakage

Please refer to the **Inquiries | After Sales Service section** to have the unit repaired if this error message is shown in the display.



* Do NOT wind or unwind the line when this Err error message is displayed. Line Learning will be inaccurate.

• If Voltage is Too High

This error message will be displayed if a voltage of more than DC28V is applied. Please check the power source and make sure that it provides between 12V~24V.

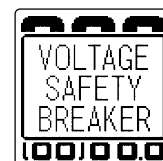

• Inaccurate Line Learning Operation

This error message indicates inaccurate Line Learning. Carry out Line Learning again.

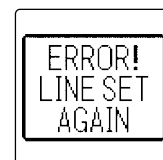

Specifications

Maximum Winding Strength	Maximum Drag	Maximum Winding Speed	Actual Winding Speed			Actual Maintainable Winding Strength
113kg 1107N	25kg/55lb 245N	165m/min.	1kg (Load) 148m/min.	2kg (Load) 146m/min.	3kg (Load) 143m/min.	17kg 167N
Reference	Maximum drag for Shimano boat reels is the drag produced when a person pulls the reel with one hand.	Retrieval speed when winding the line in with no load.	<p>The time required for bringing a rig to the surface from 100m. Actual winding speed is for example, is the speed at which a specific load can be reeled in from 100m at maximum speed using a #9000 series reel with 940m of POWER PRO 100lb.</p> <p>Measuring Conditions: A 13V power supply at 15~20°C. (Speed will be higher if a higher voltage lithium battery is used.)</p> <p>* Measurements may fluctuate according to the environment in which the reel is used.</p>			<p>The winding strength that can be maintained for an extended period of time.</p> <p>The actual maintainable winding strength is the weight of the load when the circuit breaker actually trips under the gradually increasing load.</p>

Model Number	Product Code	Gear Ratio	Weight (g/oz)	PowerPro EU DIA. (mm-m)	PowerPro US (lb.-yds.)	Winding Capacity (cm/turn : inch/turn)	Spool Dimensions (diameter/width (mm))	Handle Length (mm)	Bearing Number (balls/roller)
Beast Master 9000	51RG469000X	3.1	1490/52.6	0.32-1870 0.36-1650 0.41-1150 0.43-940	40-2050 50-1800 65-1260 80-1030	88 : 35	90 / 62	75	12 / 2 / 0

● Standard Accessories

Power Cord, Operating Manual, Component Diagram, Line Threading Pin, Reel Wrench, 10m line, Rod Cramp, Reel Bag

● Power Supply (DC Only)

DC12V (Compatible with lithium batteries.)

● Caution

When using POWER PRO 50lb or less, take care not to cause backlash or the line may be caught between the spool and the frame.

Troubleshooting

Situation	What to do	Reference
The display is black or shows all characters.	This happens when the unit is left somewhere at high temperature, such as in a car boot. It will return to normal when the temperature goes down.	
Nothing appears on the display.	Check to see if the (+) and (-) of the power cord are connected properly to the battery. Check to see if the battery has sufficient charge. Check the surface of the alligator clips for foreign objects.	P.16
Nothing appears on the display (when used in extreme cold).	When the LCD display is left in extreme cold (below -15°C), the display will not work for a while even though the power is turned on. Wait until the circuit board inside the unit warms up. When fishing in extremely cold conditions, it is recommended that the reel be kept in the cabin or under cover until it is needed.	
Line Learning cannot be set.	Please try the Line Learning process again.	P.17~32
The numbers on the display do not change even when line is fed out.	Please try the Line Learning process again.	P.17~32
There is too much discrepancy.	Please try the Line Learning process again.	P.17~32
The number on the display does not match the line depth marks.	Depending on the type of line, sometimes the line gets stretched, which can cause discrepancies on the display.	
The Gunwale Stop position is wrong.	This is probably due to winding tension or stretched line. Carry out 0 set. Gunwale set is only possible between 1~6m. Settings between 0~1m are rounded up to 1m for safety reasons.	P.37~P.38 P.46
The display is working but the motor is not.	Check if the battery has enough charge. When the battery does not have enough charge, the motor may work at low speed but not at high speed. Charge the battery and test the reel. If that does not improve the situation, you may need a new battery. The motor may not work when the temperature of the reel is below 0°C. When fishing in extremely cold conditions, keep the reel in the cabin or leave it ON until it is needed. Furthermore, the motor does not start when the display shows less than 1m for safety reasons.	P.16 P.15

Situation	What to do	Reference
The motor stops while winding.	Make sure all the screws on the power cord connector are at the connector. If the boat's power supply terminal or the reel's power cord connector is rusty, the current will not flow properly. Remove any rust and try again. Battery charge should also be checked.	P.16
There is a strange sound in the reel even when not winding.	A condenser is installed under the display unit to protect the reel from fluctuating current. The condenser may vibrate and make some noise when the reel is used with an unstable power supply. However, this will not affect reel function so it is OK to keep on using it.	
The characters "Er" appear in the display.	This is an error message generated by a safety feature. Refer to the "Safety Features" page.	P.68
Alphanumeric characters are displayed for two seconds when the power is turned on.	This is a display used for identification, and is not the sign of a problem. The display details vary depending on the product model.	

In order to enjoy fishing, please turn the power on and check the performance of the reel before you go.
(The motor does not come on unless the line is fed more than 1.1m.)

If above checks still do not improve the situation, please contact the retailer you purchased the reel from and explain the problem in detail.

Product Inquiries / After Sales Service Information

Please include your telephone number when you send us an inquiry by mail.
It is easier to explain some reel mechanisms on the phone rather than in writing.

- When the reel needs repairing, please take it to the retailer you purchased it from together with the guarantee and the power cord. We need to know detail regarding the problem. (E.g. The stopper does not work.)

A charge will be made for the necessary replacement parts and labor. We cannot compensate for damaged or lost tackle arising from a damaged Shimano product and/or fishing trip expenses.

- If you wish to order a part or replacement spool, please order from the place of purchase, specifying product name, merchandise code/product code, part name/number as shown in the component diagram. (We recommend sending in the whole reel for the repair.)

Example/

Product Name: Beast Master 9000

Product Code: 5RG469000

Part Number: 2

Part Name: Handle

- Shimano retains fundamental parts (i.e. the parts necessary to maintain the function of the product) for fishing rod for up to 6 years after the manufacturing of a particular model is stopped. We may not accept a request for the repair if parts are not available. Some other minor parts may not be provided even if it is less than 6 years since the manufacturing of the product has been stopped.

● Product Code

The top five digits of the product code is recorded on the instruction manual, component diagram, and bottom or side of the package.

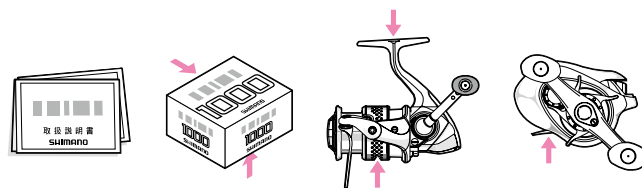

Service network

SHIMANO

SHIMANO EUROPE FISHING HOLDING B.V.

Industrieweg 24, 8071 CT Nunspeet, The Netherlands Phone: +31-341-272233

SHIMANO GERMANY FISHING GMBH

Diessemer Bruch 114 F, 47805 Krefeld, Germany Phone: +49-2151-55670

SHIMANO ITALY FISHING S.R.L.

Via Privata Maestri del Lavoro 29, 20025 Legnano Milano, Italy Phone: +39-0331-742711

SHIMANO AMERICAN CORPORATION

One Holland, Irvine, CA 92618 U.S.A. Phone: +1-877-577-0600

SHIMANO CANADA LTD.

427 Pido Road Peterborough, ON K9J 6X7, Canada Phone: +1-705-745-3232

SHIMANO AUSTRALIA FISHING PTY. LTD.

36 Bay Road, Taren Point, NSW 2229, Australia Phone: +61-2-9526-2144

SHIMANO (SINGAPORE) PTE. LTD.

20 Benoi Sector, Jurong Town, Singapore 629852 Phone: +65-6265-4777

SHIMANO INC.

3-77 Oimatsu-cho, Sakai-ku, Sakai City, Osaka 590-8577, Japan Phone: +81-72-223-3467

www.shimano.com



14

PRINTED IN JAPAN
IMPRIME AU JAPON

Memo



SHIMANO

• Line Threading Pin

(140424)