

Sterilizer product parts diagram



How to use the Bololo baby bottle sterilizer



1 Buckle the bottle or tableware that needs to be sterilized upside down on the bottle holder of the sterilizer barrel.



2 Place the pacifiers and small parts to be disinfected upside down in the pacifier bar and install them on the barrel (the pacifier bar has a triangle arrow mark facing the LOGO of the barrel body)



3 Close the lid (the lid has a triangular arrow mark facing LOGO side of barrel)



4 Pour 100ml of water into the heating plate of the base (the amount of water added does not exceed the MAX water level mark line)



5 Install the installed barrel on the base (the LOGO surface of the barrel and the switch knob surface of the base (back))



6 Plug in the power supply; turn the switch knob to start working according to the required function.

Introduction to Sterilizer Combination Mode

Mode 1



The wider side of the nipple bar (marked by a triangular arrow) is placed toward the knob surface of the base.

Mode 2



The pacifier bar has a wider side with triangular arrows, the barrel body has a LOGO surface, and the three sides of the base knob surface are in the same direction.

Mode 3



The LOGO of the barrel body is placed facing the knob surface of the base.

Introduction to disinfection work mode

1. Disinfection only



Add 100ml of water to the base (not exceeding the MAX water mark line), install and plug in; turn the switch to the disinfection position

2. Drying only



No water is added to the base, plug-in is installed, and the switch is turned to any position is the drying mode.

3. Disinfection and drying



Add 100ml of water to the base (not exceeding the MAX water mark line), install and plug in; turn the switch to 40-60 minutes.

How to clean

1. After each use, turn off the power and wait for it to cool. Wipe the bottom of the heating plate with a wet wipe or cloth.
2. The upper cover, nipple bar, bucket body, and bottle holder can be cleaned with detergent. It is recommended to clean it once a week.
3. The heating plate prevents water from being generated. Please use pure water as much as possible. If the scale has been produced, you can soak it in vinegar and water (3:1) or scale detergent for 1 hour and wipe it off; if it is not completely removed, repeat this operation.

Image 1:



Note:
Do not wash the motor in water, and only wipe the outside of the motor with a clean cloth. Please disconnect the power well and wait for it to cool down before cleaning. Do not deposit water on the air outlet when the container is fully washed.

Main features of this product

The milk bottle sterilization dryer adopts a high-temperature heating device to quickly evaporate water and generate high-temperature steam. In a closed sterilizer, the baby tableware and utensils such as milk bottles are disinfected in an all-round way. It also has a drying function to directly eliminate zero. Dry the food and utensils inside the container and the baby to keep it dry and hygienic, effectively preventing bacterial regeneration.



Quick disinfection and drying are done at one time. Use high-temperature steam for disinfection. After disinfection, it will automatically turn to hot air for drying. The entire process is automatically controlled and quickly completed, saving time and worry.



Free assembly and full satisfaction
The free assembly fully meets the split structure of the base, the barrel, the nipple basket and the upper cover, and can be assembled at will according to your needs to meet the needs of all kinds of high milk bottle disinfection and all-round needs.



Large storage expansion space
can accommodate 6 milk bottles. With the design of the detachable bottle rack, the space utilization is greatly improved. The milk bottles and tableware are sterilized and easily handled.



Safe and power saving
When the work is completed, the power will be cut off automatically, which is safe and secure.

Product specifications

Model	BL-1008 (White,pink,green) Universal		
Product name	Baby bottle sterilizer	Origin	Ningde, Fujian
Voltage/ Frequency	220V/50Hz	Year of manufacture	Marked on the package or product body
Disinfection power	600W	Recommended use environment	Please use indoors
Drying power	200W	Recommended room temperature	15~30°C
Packing	1 set	Recommended humidity	50~80%
Executive standard	GB4706.1 GB4706.19	Qualified level	Qualified product

Package contents and description for each part

Please check the quantity of contents before use. If there are any missing items, please contact the shop where you purchased it.

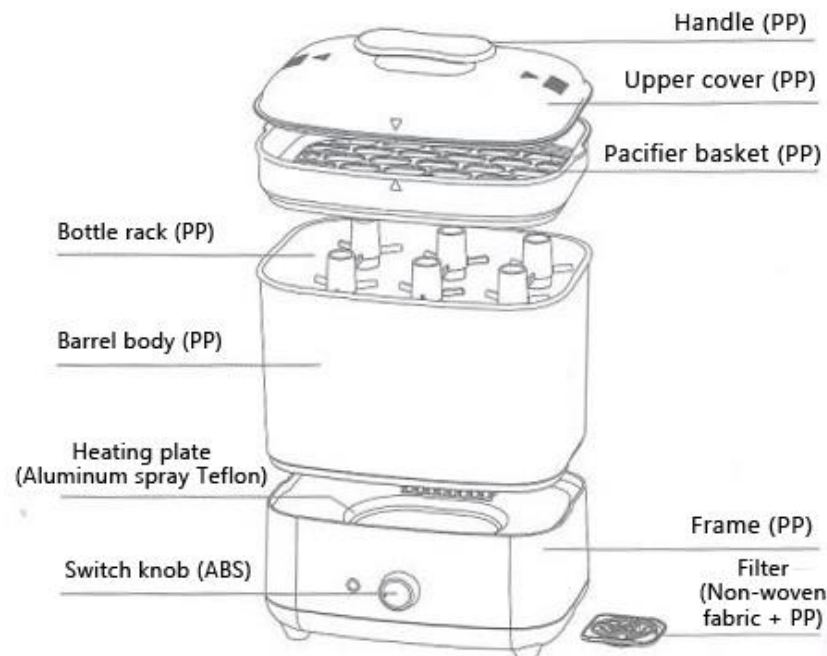

* The pictures in this manual may be different from the product, which means that the actual contents shall prevail.

Tips

The pictures in this manual may be different from the product. Please refer to the actual contents. Use traditional boiling water to sterilize the baby's utensils and utensils. The disadvantages:

- The penetration power of boiling water sterilization is not high-temperature steam. Strong, incomplete sterilization effect.
- Excessive boiling will deform some plastic utensils with low temperature resistance.
- The temperature of the heated iron (stainless steel) pot wall is extremely high. Once the plastic utensils are touched, they will be easily deformed or damaged.

Precautions for use

- Do not place near fire source.
- Do not drag the wire from the work surface to a place where children can reach it.
- Do not immerse the product base in water for cleaning, and avoid water entering the air outlet to avoid product damage and danger.
- If too much water is added to the heating plate, a small amount of water will flow from the air outlet drainage system to the table surface, which is normal and does not affect the use.
- Considering from the perspective of hygiene, the sterilizer should be used exclusively for special purposes and not for other purposes.
- During the heating process, please do not touch or block the "system steam outlet" to avoid injury.
- Do not place the product in a place where infants and young children can reach it.
- Before cleaning, please disconnect the power well and wait for it to cool down before operating.
- Change the filter once every 15 days to avoid affecting the drying effect.
- Please use pure water as much as possible. Please clean and disinfect the disinfection utensils to reduce the formation of scale.
- If the power cord is damaged, in order to avoid danger, it must be replaced by professionals from the manufacturer, its maintenance department or similar departments.
- The materials used in this product conform to national safety standards. If there is residual material odor, it is normal. Please clean the product according to the correct cleaning method before using it for the first time, which can effectively reduce or eliminate the residual odor.
- Before connecting the product to the power supply, be sure to check whether the voltage marked on the product is consistent with the supply voltage. The power plug of the product must be plugged into a grounded socket and make sure that it is firmly plugged in.
- If you can obtain supervision or guidance on the safe use of appliances and understand the dangers involved, this product can be used by people with impaired limbs, sensory or mental disabilities, or lack of relevant experience and knowledge.
- Do not let the power cord and plug come into contact with hot surfaces and sharp edges. If the plug, power cord or the product itself is damaged, do not use this product.
- Do not allow children to play with the product packaging PE bag to avoid the hazard of suffocation.
- When not in use, please unplug the power supply, clean it in time, and dry it for storage.
- This product is for indoor use only.

Panel description

Panel marking	The amount of water added to the heating plate (ml)	One-time working room + 6 minutes	Remark
Disinfect	100	About 15	Suitable for general bottle sterilization
40 Disinfection and drying	100	About 40	Suitable for sterilization and drying of general baby bottles
60 Disinfection and drying	100	About 60	Suitable for disinfection and drying of large amounts of content

Instructions

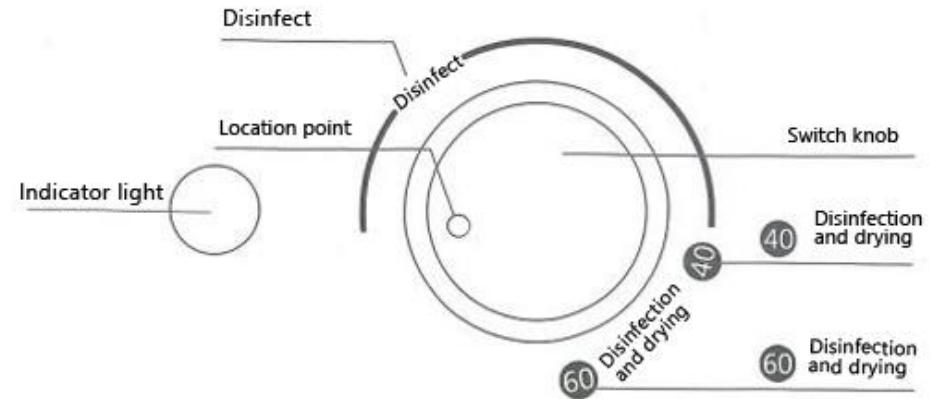

1. Disinfection: Rotate the knob clockwise to turn the "locating point" to the "disinfection" position to perform the disinfection function.
2. Disinfection and drying: According to the amount of content, turn the knob clockwise to rotate the "positioning point" to a position between "40" or "60" to perform the disinfection and drying function.
3. Indicator light; lights up when any function is working, and goes out after the work is completed

Instructions

- Before use, clean the parts first to ensure a better disinfection effect.

Assembling method

First place the base in a horizontal position, do not tilt it, and pour 100ml of water into the heating plate (drying alone does not require water), the water cannot exceed the MAX water level mark line, so as not to "make water enter the air outlet and damage the interior" Components. (Figure ①)

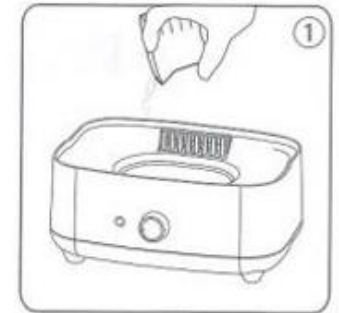

Instructions

- Place the barrel horizontally on the base, buckle the bottle mouth upside down on the bottle holder, buckle the nipple basket on the upper edge of the barrel, put the nipple and other accessories on top, and close the lid. (Figure ②)

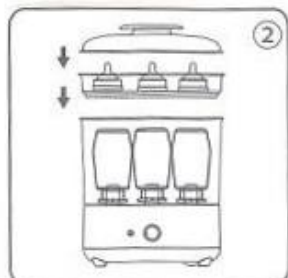

- Placing the nipple basket on the base separately can sterilize various small objects. (Figure ③)



- If you sterilize larger containers such as bowls, plates, chopsticks, etc., you can pull out the bottle holder to increase the space in the bucket. (Figure ④)

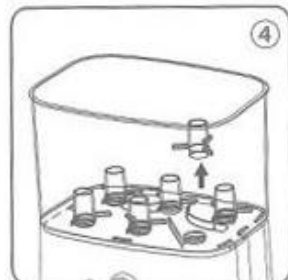

Disinfection + drying

- Turn on the power supply, turn the knob clockwise, turn the "positioning point" to the "40" or "60" position (you can choose according to the amount of drying items), and the heating plate is heated. After the water is boiled dry (about 15 minutes), it will automatically turn to drying. The "locating point" automatically returns to the "off" position, the indicator light is off, and the disinfection + drying function is completed. (Figure ⑤)
 Note: In case of poor drying effect, you can turn the 9 knob clockwise to add time for drying.

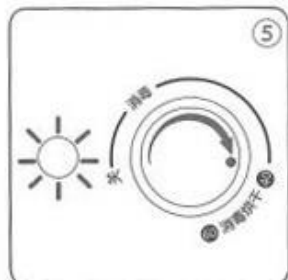

Instructions

Separate disinfection

- Turn on the power, turn the knob clockwise, turn the "locating point" to the "disinfection" position, the heating plate will heat up, the water will boil dry (about 15 minutes) in the "off" position, the indicator light will go out, and the disinfection function will be completed. (Figure ⑥)
 Note: If the amount of water added is too much or too little, it is normal for the water to fail to dry or to automatically switch to drying.

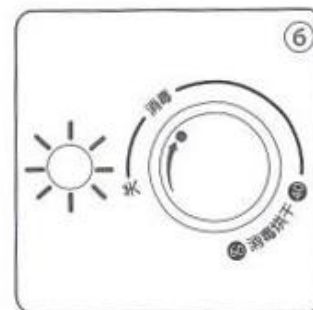

Dry separately

- Turn on the power, (no need to add water) turn the knob clockwise, turn the "positioning point" to the "40" or "60" position (you can choose according to the amount of dried items), and the sterilizer will perform an automatic drying program. "Locating point" automatically returns to the "off" position, the indicator light is off, and the drying function is completed. (Figure ⑦)
 Note: In order to achieve a better drying effect, when the machine is performing the separate drying function, the heating plate will be heated at 0 for about 50 seconds to ensure that the plate is completely dried before it is dried. In the air outlet mode, if the drying effect is not good, you can turn the knob clockwise to add time for drying.

