



MEYER ROAD BRIDGE REPLACEMENT PROJECT

WORKS NOTIFICATION

COMMENCEMENT OF WORKS - February 2020

The Department of Planning, Transport and Infrastructure, through the Public Transport Projects Alliance (PTPA) is delivering the Meyer Road Bridge Replacement Project at Lonsdale.

This project is funded by the Australian Government's Bridge Renewal Program and the City of Onkaparinga.

The Meyer Road Bridge provides a key connection between local industry, surrounding suburbs and road networks and spans over the Adelaide to Seaford passenger rail line.

Key Activities

Works on the Meyer Road Bridge are scheduled to commence the week of **Monday, 10 February, and will be completed mid-2020**, weather permitting. The works include:

- demolishing the majority of the existing bridge structure;
- building and installing new bridge structure; and
- installation of anti-throw screens and bridge barriers.

Works will be undertaken between the hours of **7am and 5pm, Monday to Saturday throughout the construction period.**

Night works and Sunday works will be scheduled intermittently within this period. Regular project updates will be posted on the project website listed below and DPTI social media as the works progress.

How will these works affect me?

Meyer Road will be closed to traffic from Sigma Road roundabout to the Christie Road junction for the duration of the works. Traffic detours and speed restrictions will be in place, **as shown on the attached map.**

Signage will be in place to alert road users to the changed traffic conditions. Access to businesses on Meyer Road will be maintained at all times throughout the works and we urge continued support of local businesses.

To minimise disruption to rail passengers, works impacting the Seaford rail line adjacent the Meyer Road Bridge will be scheduled, when possible, at night after the last scheduled rail service. However, some interruption to rail services may occur throughout the construction period. Adelaide Metro will provide advance notification of any changes to services. For more information, please visit www.adelaidemetro.com.au.

Every effort will be made to minimise noise impacts to nearby residents and businesses wherever practically possible. However, some noise will be unavoidable during this period. Your patience and cooperation whilst these important works are undertaken is appreciated.

More information

To find out more about the Meyer Road Bridge Replacement Project and register for future email updates, you can contact the project team using the contact details below.

 1300 205 998

 meyerroadbridge@ptpa.com.au

 ptpa.com.au/projects/meyerroadbridge



Australian Government

BUILDING OUR FUTURE



Government
of South Australia

Department of Planning,

MEYER ROAD BRIDGE REPLACEMENT PROJECT



WORKS DETOUR

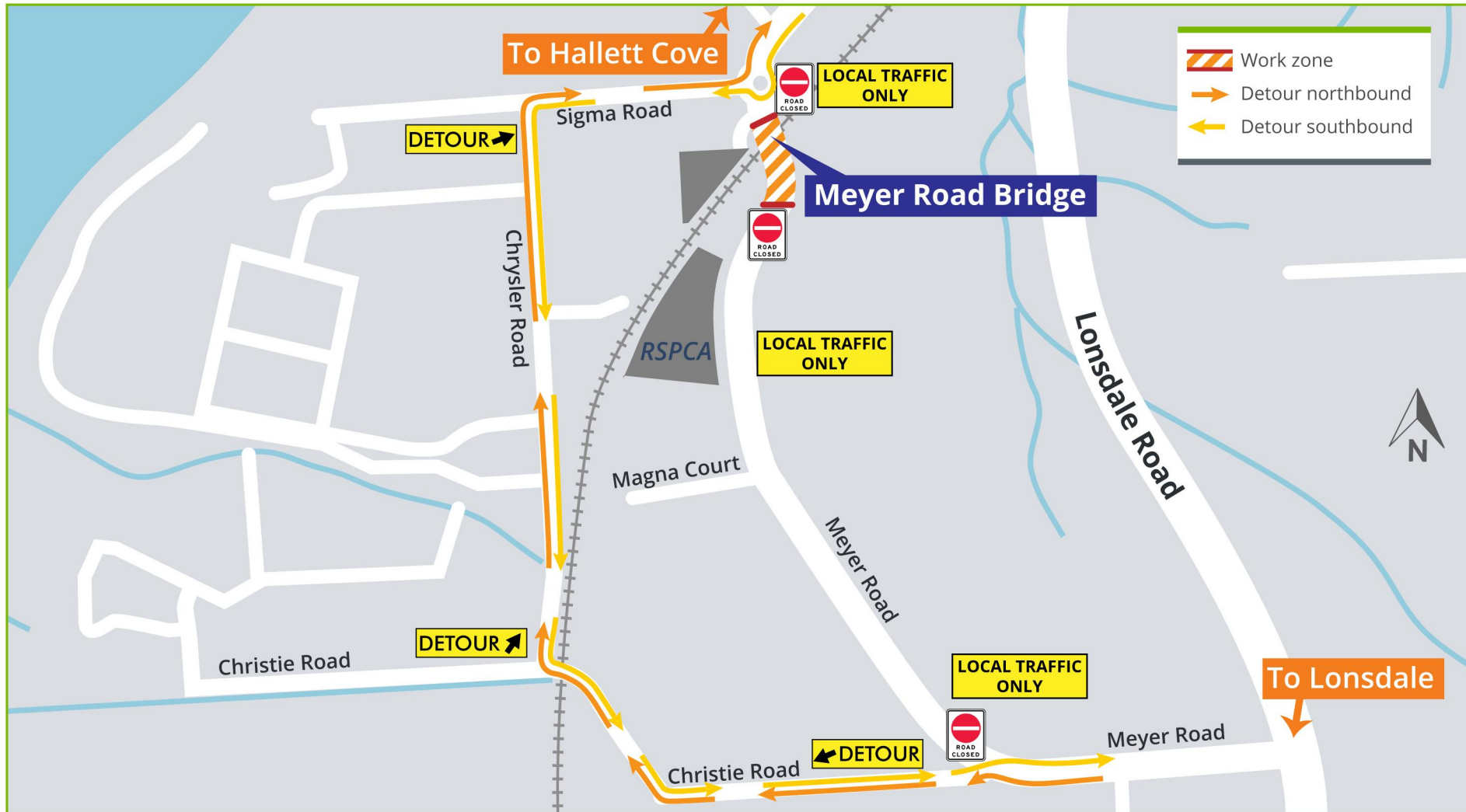

1300 205 998



meyerroadbridge@ptpa.com.au



ptpa.com.au/projects/meyerroadbridge



Australian Government

BUILDING OUR FUTURE



Government of South Australia

Department of Planning, Transport and Infrastructure