

# HARMONI

*on Hythe*





MIAMI BEACH (200M)

19 HYTHE ST

GOLD COAST HWY



NORTH BURLEIGH  
(500M)

19 HYTHE ST

MIAMI STATE  
HIGH SCHOOL (850M)



*Facade*



**ENTRANCE DOOR HANDLE**  
*MCGRATH DIGITAL LOCK*  
*BRASS HALF ROUND PULL HANDLE*



**TIMBER CEILINGS**  
*SATIN ASH*



**DECORATIVE SCREENS**  
*DECOWOOD CURLY BIRCH*



**WALL LIGHTS**  
*BRASS CYLINDRICAL LIGHTS*



**ENTRANCE DOOR & SIDELITE**  
*LIGHT OAK*  
*CLEAR GLASS*



**STONE CLADDING**  
*WHITE RANDOM*  
*STONE CLADDING*

**RENDER**  
*DULUX NATURAL WHITE*



*Exterior*



*U1 Kitchen*



U1 Kitchen



*U1 Kitchen*

**BENCH TOP & WATERFALL ENDS**  
YDL VENATINO



**HANDLES**  
BRASS BARRINGTON  
ECLIPSE RIBBED

**SPLASH BACK**  
MATT WHITE SQUARE TILE

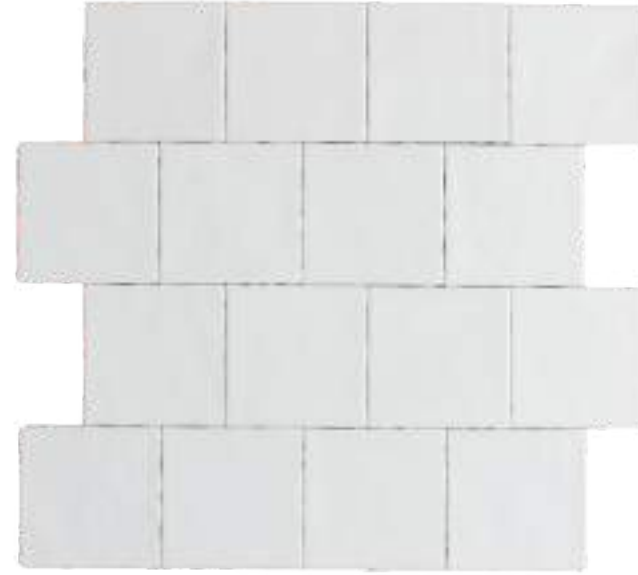

**FLOORING**  
PLANK RAWMA  
ENGINEERED TIMBER



**FEATURE LIGHTS**  
RITA RATTAN PENDANTS OVER  
ISLAND

**CABINETS**  
2PACK LEXICON  
QUARTER FLUSH PANEL  
WITH FEATURE VJ  
PROFILE TO BACK OF  
ISLAND

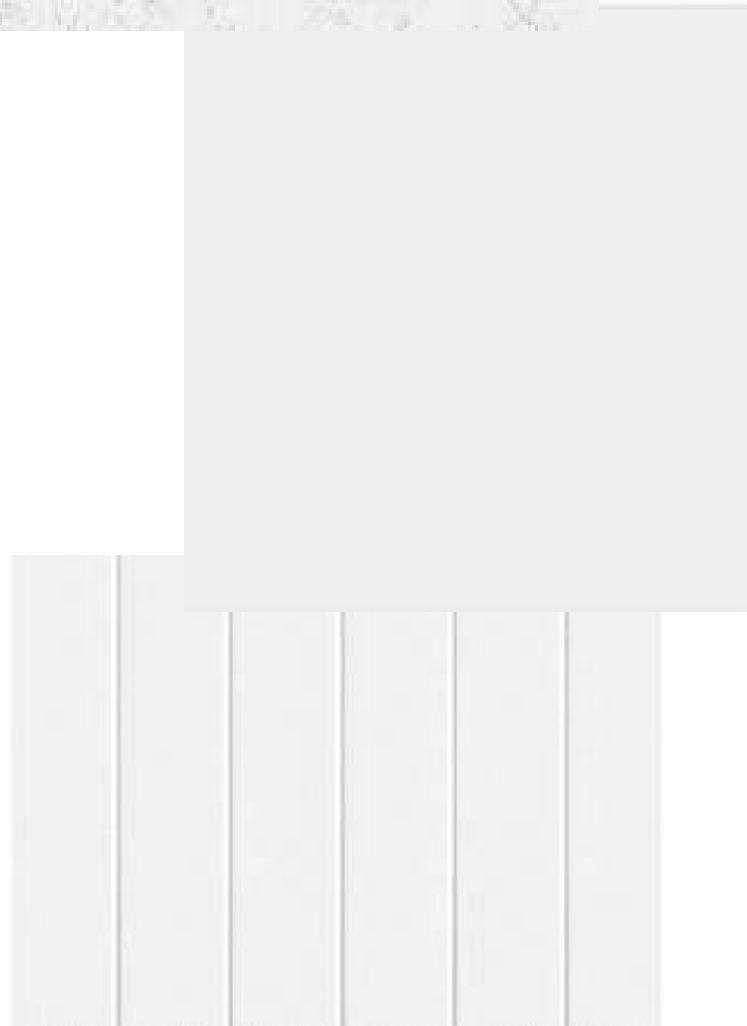

**SINK**  
SCHOCK POLARIS (WHITE) 1+1/3  
BOWL UNDERMOUNT SINK



**SINK MIXER**  
ABI BRUSHED BRASS



**NOTE:** WINDOW COVERINGS NOT INCLUDED

*Unit 1 & 4 Kitchen*



*U2 Kitchen*



*U2 Kitchen*

**BENCH TOP & WATERFALL ENDS**  
YDL VENATINO



**HANDLES**  
BRASS BARRINGTON  
ECLIPSE RIBBED

**SPLASH BACK**  
MATT WHITE SQUARE TILE

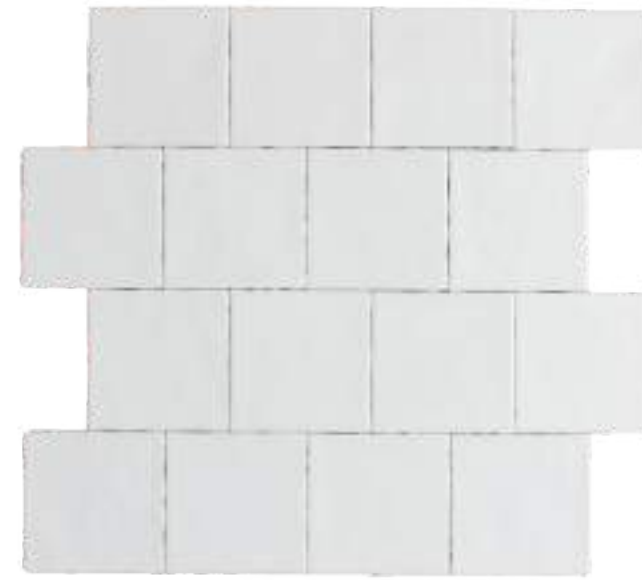

**FLOORING**  
PLANK RAWMA  
ENGINEERED TIMBER



**FEATURE LIGHT**  
SINGLE PANAMA RAFFIA  
PENDANT OVER ISLAND

**CABINETY**  
2PACK LEXICON  
QUARTER FLUSH PANEL  
WITH FEATURE VJ  
PROFILE TO BACK OF  
ISLAND  
NATURAL OAK RAVINE  
FEATURE SHELVES

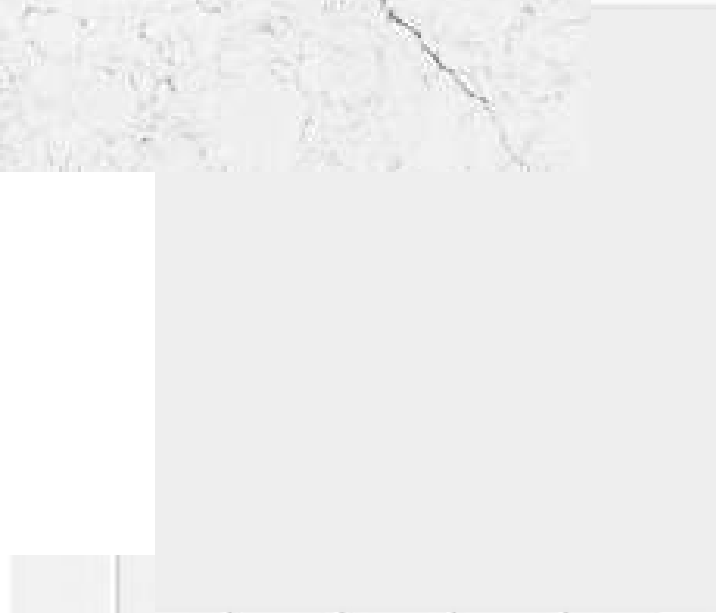

**SINK**  
SCHOCK POLARIS (WHITE) 1+1/3  
BOWL UNDERMOUNT SINK



**SINK MIXER**  
ABI BRUSHED BRASS



**NOTE: WINDOW COVERINGS NOT INCLUDED**

*Unit 2 & 3 Kitchen*

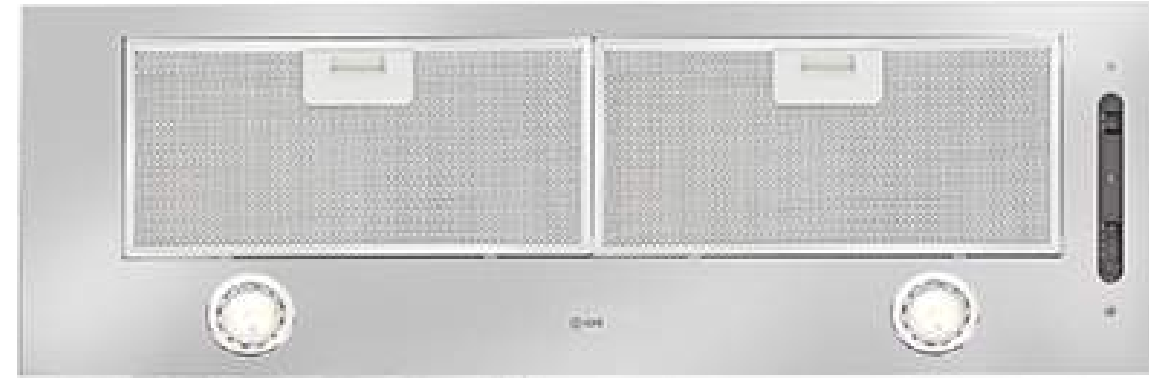

RANGEHOOD  
*ILVE INTEGRATED RANGEHOOD*

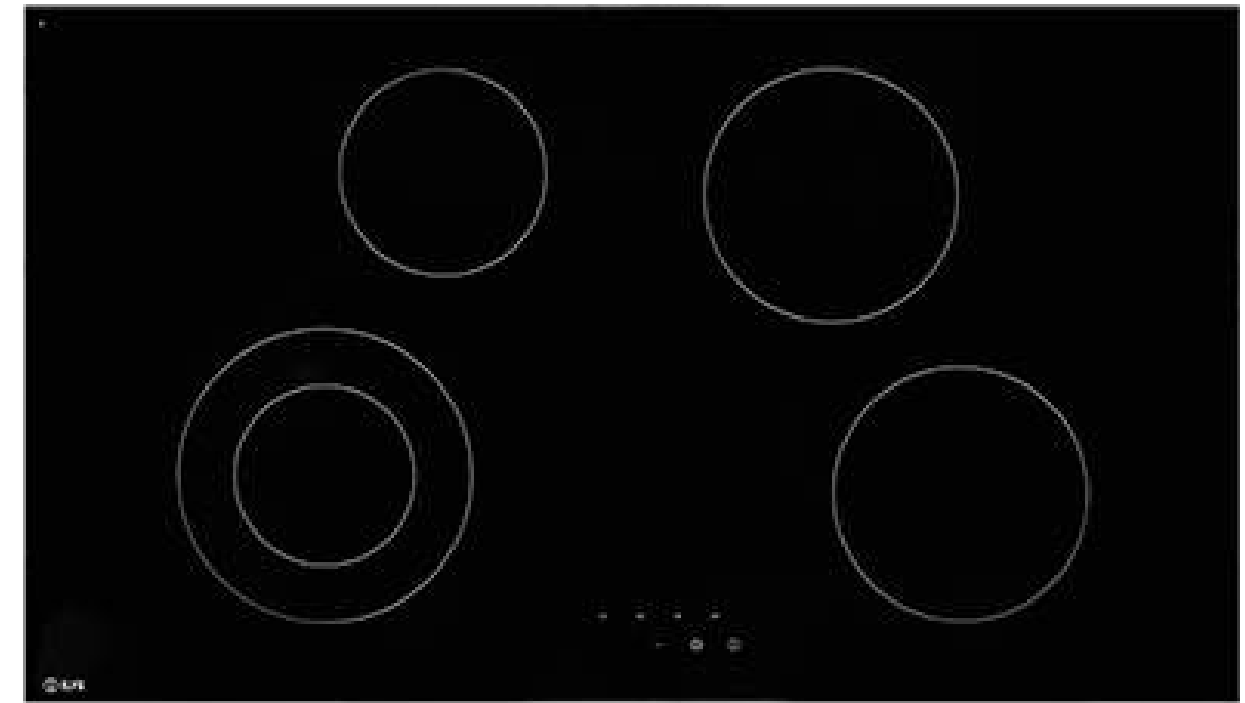

COOKTOP  
*ILVE 90CM COOKTOP*



DISHWASHER  
*ILVE  
INTEGRATED  
DISHWASHER*



OVEN  
*ILVE 90CM  
ELECTRIC OVEN BLACK*



*Kitchen Appliances*



*U1 Master Enquite*



*U2 Master Ensuite*



**BENCH TOP**  
*YDL VENATINO*



**CABINETRY**  
*POLYTEC RAVINE*  
*NATURAL OAK*



**CABINETRY HANDLES**  
*BRASS LIP PULL*



**BASINS**  
*ABI MISKA BASIN*  
*MATTE WHITE*



**TAPWARE & ACCESSORIES**  
*ABI BRUSHED BRASS*



**TILES**  
*TERRAZZO LOOK FLOOR & FEATURE WALL TILE*  
*MATT WHITE MINI SUBWAY VERTICAL WALL TILES*



**BATH (MASTER ENSUITE)**  
*FIENZA KOKO MATTE*  
*FREESTANDING BATH*



**NOTE: WINDOW COVERINGS NOT INCLUDED**

*Bathrooms*



*Powder Room*



**BENCH TOP**  
*YDL VENATINO*



**TAPWARE & ACCESSORIES**  
*ABI BRUSHED BRASS*



**FEATURE WALL**  
*VJ CLADDING*



**FLOOR TILES**  
*TERRAZZO LOOK TILE*



**BASINS**  
*ABI MISKA BASIN*  
*MATTE WHITE*



**NOTE: WINDOW COVERINGS NOT INCLUDED**

*Powder Room*

**BENCH TOP**  
YDL VENATINO



**CABINETS**  
POLYTEC CLASSIC  
WHITE MATT



**TILES**  
TERRAZZO LOOK FLOOR TILE  
MATT WHITE MINI SUBWAY  
VERTICAL SPLASHBACK TILE



**STORE TALL  
CUPBOARD HANDLES**  
ABI BRUSHED BRASS  
KNOBS



**SINK MIXER**  
ABI BRUSHED BRASS

**SINK**  
WHITE ROUND SINK



**NOTE: WINDOW COVERINGS NOT INCLUDED**

*Laundry*



*Living & Dining*



*Living & Dining*



**INTERNAL HANDLES**  
*MUCHELN BRASS*



**CEILING FANS**  
*WHITE TIMBER*

**PAINT COLOUR**  
*DULUX LEXICON QUARTER*

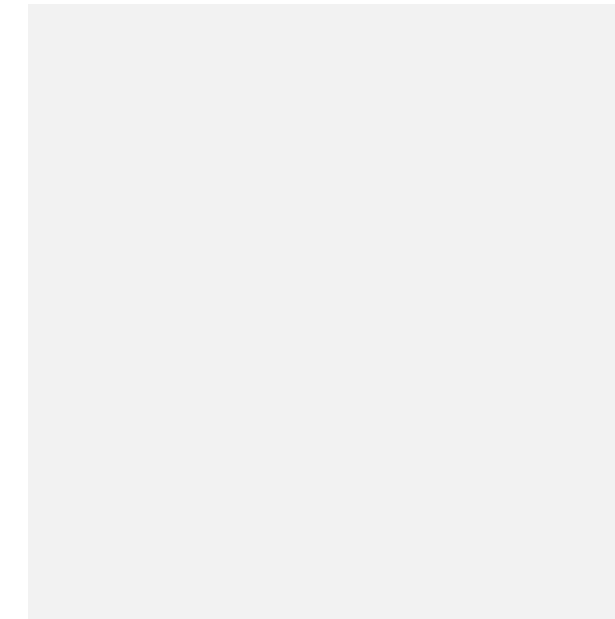

**FLOORING**  
*PLANK RAWMA*  
*ENGINEERED TIMBER*



**TV UNIT**  
*POLYTEC NATURAL*  
*OAK RAVINE*



**NOTE:** WINDOW COVERINGS NOT INCLUDED

*Living & Dining*

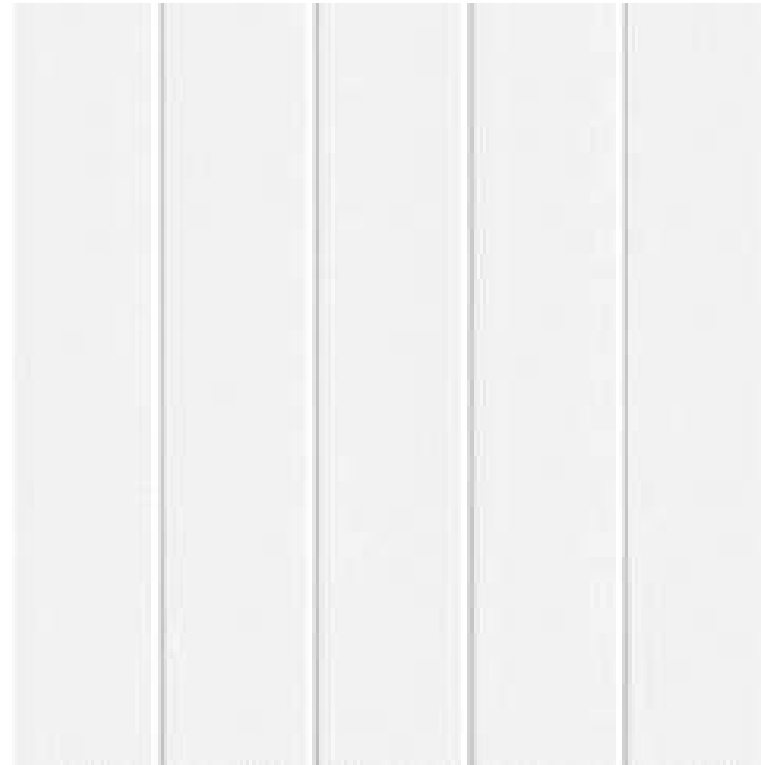

**STAIRWELL FEATURE WALL**  
*VJ CLADDING*



**STAIRWELL LIGHT**  
*MANDALI PENDANT*



*WHITE ROUND RECESSED STEP WASHLIGHTS*

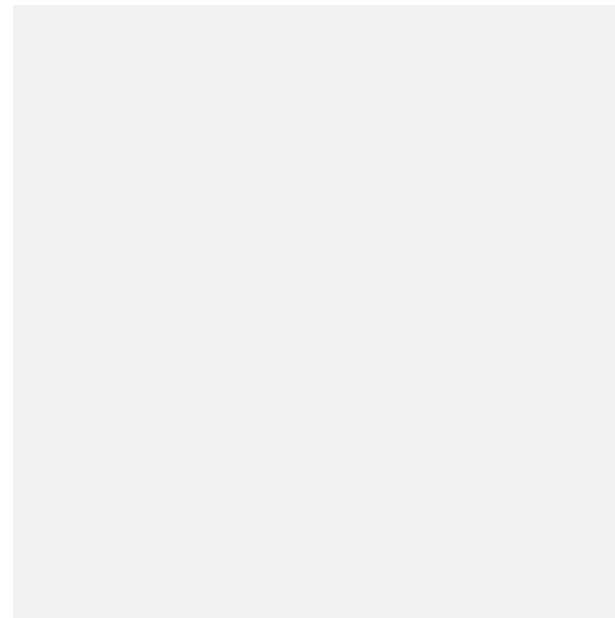

**PAINT COLOUR**  
*DULUX LEXICON  
QUARTER*



**FLOORING**  
*PLANK RAWMA  
ENGINEERED TIMBER*



*Stairwell & Entry*

**NOTE:** WINDOW COVERINGS NOT INCLUDED



*U1 Master Bedroom*



*Vanity Nook*



**CEILING FANS**  
*WHITE TIMBER*



**INTERNAL HANDLES**  
*MUCHELN BRASS*

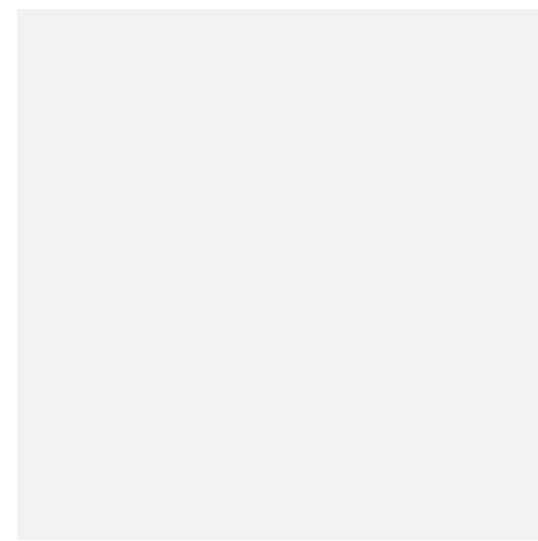

**PAINT COLOUR**  
*DULUX LEXICON QUARTER*



**BEDSIDE WALL SCONCES**  
*PLASTER WALL LIGHTS*



**VANITY NOOK**  
*YDL VENATINO  
BENCHTOP  
POLYTEC NATURAL OAK  
RAVINE CABINETRY  
BRASS LIP PULL HANDLES  
LED PILL SHAPE MIRROR*



**CARPET**  
*MODERN TEXTURE  
MORNING FOG*

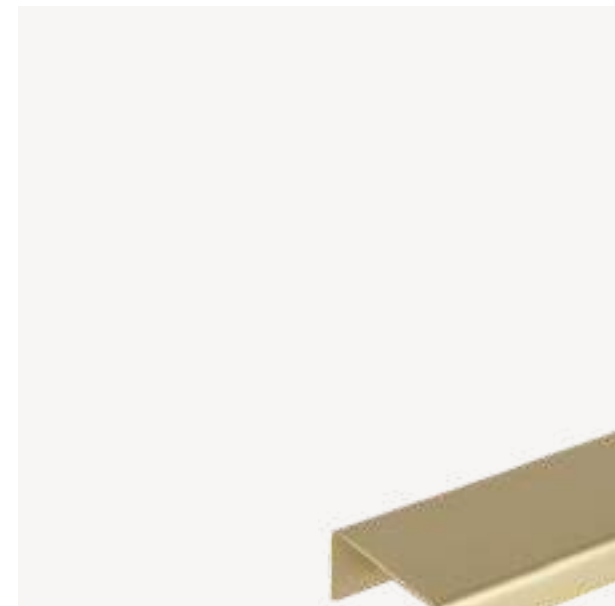

**WALK-IN ROBE**  
*POLYTEC CLASSIC WHITE  
MATT CABINETRY  
BRASS LIP PULL HANDLES*



**NOTE:** WINDOW COVERINGS NOT INCLUDED

*Master Bedroom*

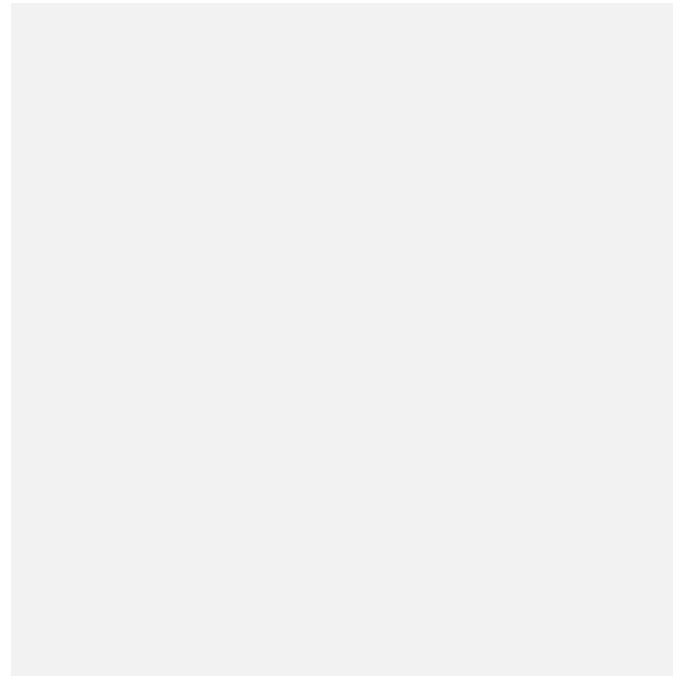

**PAINT COLOUR**  
*DULUX LEXICON QUARTER*



**CEILING FANS**  
*WHITE TIMBER*



**INTERNAL HANDLES**  
*MUCHELN BRASS*



**CARPET (BED 2 & 3)**  
*MODERN TEXTURE*  
*MORNING FOG*



**FLOORING (BED 4)**  
*PLANK RAWMA*  
*ENGINEERED TIMBER*



*Other Bedrooms*

**NOTE: WINDOW COVERINGS NOT INCLUDED**



*U1 Rooftop Entertaining*



*U1 Rooftop Entertaining*



*U3 Rooftop Entertaining*



**OUTDOOR KITCHEN CABINETRY**  
YDL ROSEMEE & 2PACK  
NATURAL WHITE

**OUTDOOR KITCHEN SINK  
& MIXER**  
ABEY ALFRESCO  
STAINLESS STEEL SINK  
OLIVERI ESSENTE  
STAINLESS STEEL MIXER



**TIMBER CEILING CLADDING**  
SATIN ASH

**OUTDOOR SHOWER**  
RAW BRASS SHOWER

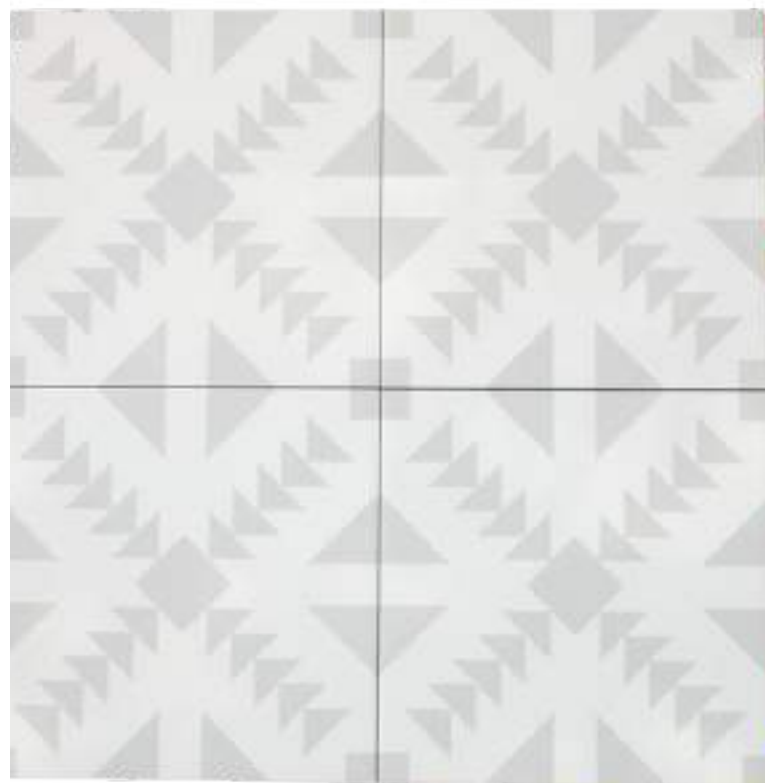

**ROOFTOP TILE**  
AUSTINMER GREY  
ENCAUSTIC LOOK TILE



**BALCONY TILE**  
BURLINGTON STONE  
BLANCO MATT



*Outdoor Living*

**HUSKY**



**BAR FRIDGE**  
*HUSKY 118L ALFRESCO DRINKS  
CHILLER*



**BBQ**  
*BEEFEATER BLACK  
BUILT-IN BBQ*



*Entertaining Appliances*

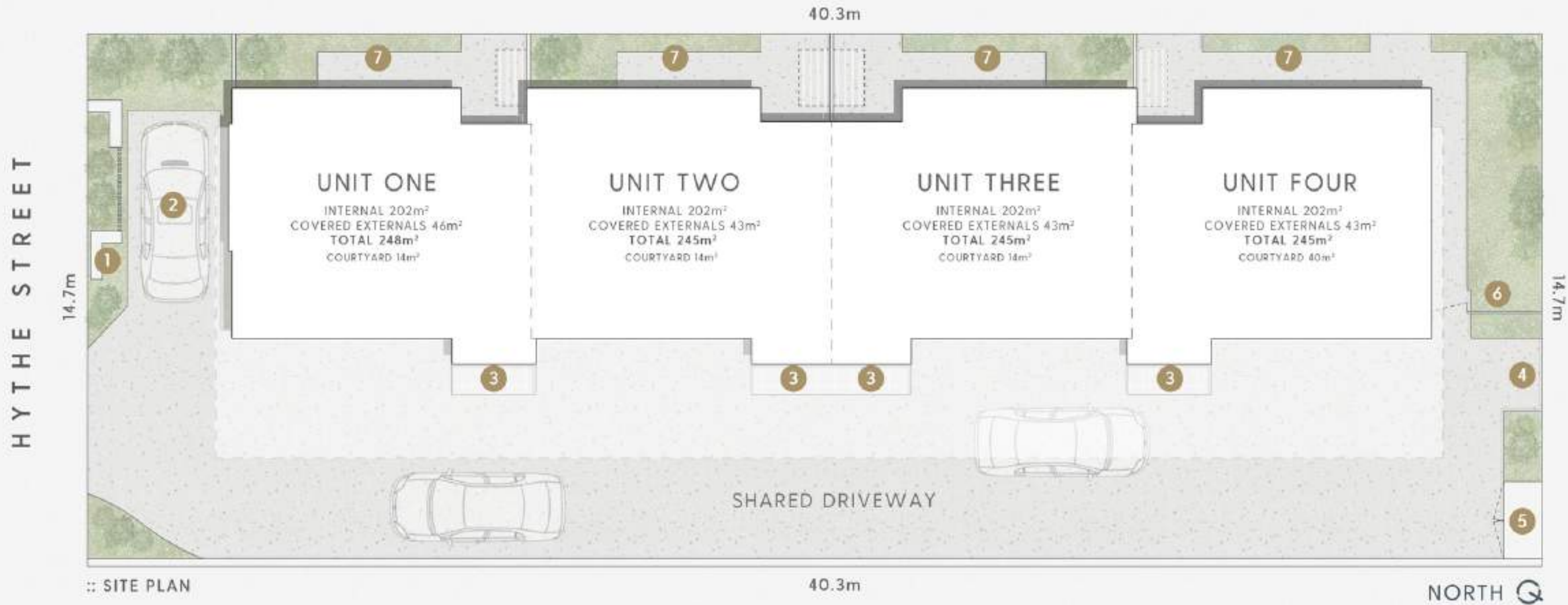

- KEY**
- 1. LETTER BOXES | 2. VISITOR CARSPACE | 3. ENTRY PORCHES | 4. BICYCLE PARKING
  - 5. BIN STORE (UNITS ONE -THREE) | 6. UNIT FOUR SIDE ACCESS | 7. PRIVATE COURTYARDS

# UNIT ONE 19 Hythe Street MIAMI

BED	4
BATH	3.5
CAR	2
INTERNAL	202m <sup>2</sup>
COVERED EXTERNAL	46m <sup>2</sup>
TOTAL	248m <sup>2</sup>
COURTYARD	14m <sup>2</sup>



FLOOR PLAN  
Third Floor - 2.6m Ceiling



FLOOR PLAN  
Second Floor - 2.7m Ceiling



FLOOR PLAN  
Ground Floor - 2.6m Ceiling



FLOOR PLAN  
First Floor - 2.6m Ceiling

*Unit 1 Floor Plan*

UNIT TWO  
19 Hythe Street  
MIAMI

BED	4
BATH	3.5
CAR	2
INTERNAL	202m <sup>2</sup>
COVERED EXTERNAL	43m <sup>2</sup>
TOTAL	245m <sup>2</sup>
COURTYARD	14m <sup>2</sup>



FLOOR PLAN  
Third Floor - 2.6m Ceiling



FLOOR PLAN  
Second Floor - 2.7m Ceiling



FLOOR PLAN  
Ground Floor - 2.6m Ceiling



FLOOR PLAN  
First Floor - 2.6m Ceiling



*Unit 2 Floor Plan*

**UNIT THREE**  
**19 Hythe Street**  
**MIAMI**

BED	4
BATH	3.5
CAR	2
<hr/>	
INTERNAL	202m <sup>2</sup>
COVERED EXTERNAL	43m <sup>2</sup>
TOTAL	245m <sup>2</sup>
COURTYARD	14m <sup>2</sup>



*Unit 3 Floor Plan*



:: FLOOR PLAN  
Third Floor



:: FLOOR PLAN  
Second Floor

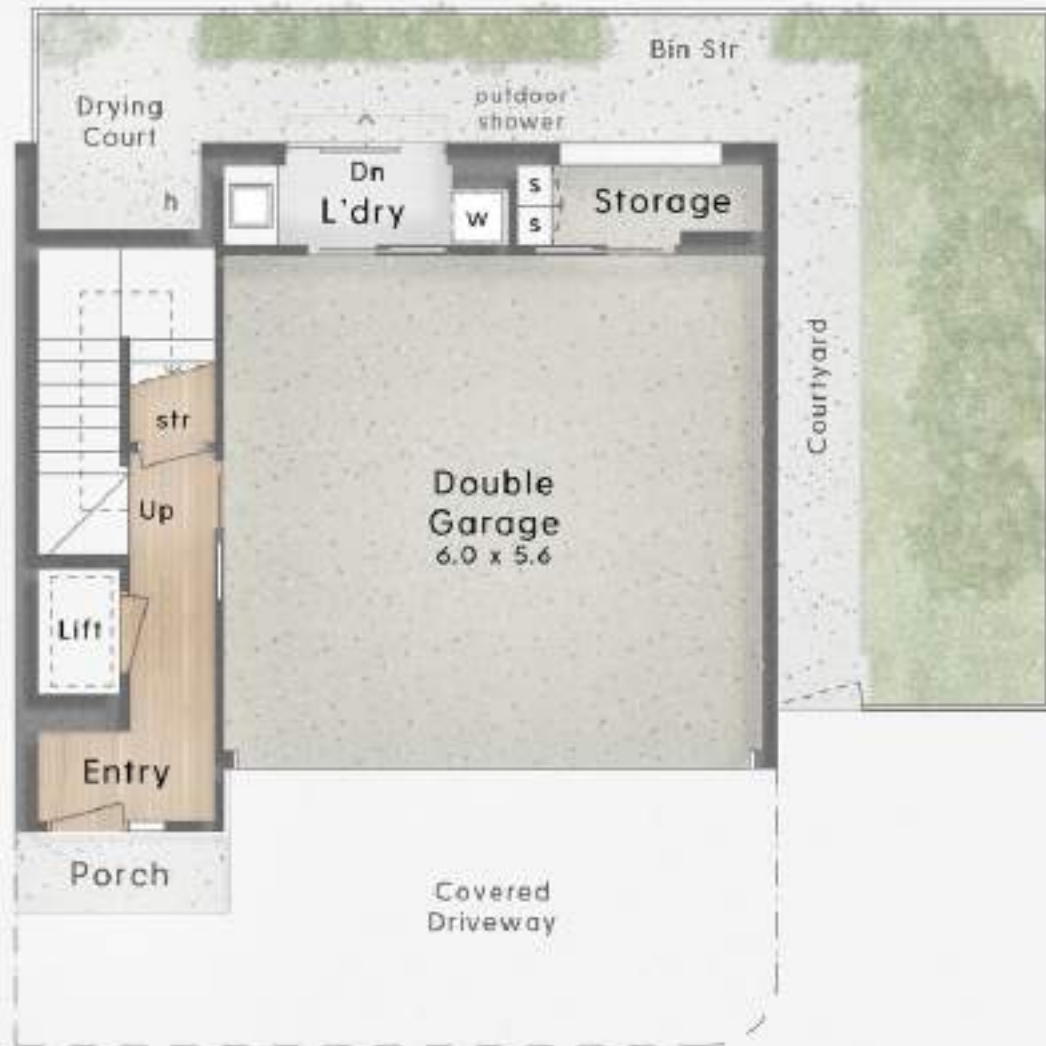

:: FLOOR PLAN  
Ground Floor



:: FLOOR PLAN  
First Floor

## UNIT FOUR 19 Hythe Street MIAMI

BED	4
BATH	3.5
CAR	2
INTERNAL	202m <sup>2</sup>
COVERED EXTERNAL	43m <sup>2</sup>
TOTAL	245m <sup>2</sup>
COURTYARD	40m <sup>2</sup>

*Unit 4 Floor Plan*

PREPARED BY

**HIGHLIFE**

---

**S A L E S**

www.highlifesales.com.au  
elyse@highlifesales.com.au  
0412 304 991

*All good faith and due care has been taken when preparing this document. Purchasers must note that images, information and figures have been provided by third parties, so no liability is taken for assumptions that may be incomplete, incorrect or erroneous. Potential purchasers must satisfy themselves in relation to all aspects of this document. The Vendor, Highlife Sales, or their employees, agents or representatives will not be liable for any loss or damage resulting from any statement, figure, calculation or any other information that a potential purchaser relies upon that is contained in this document or any other marketing material.*