



GROUND FLOOR



FIRST FLOOR

DWELLING

UNIT 1

- 4 BEDROOMS
- 3 BATHROOMS
- 2 LIVING ZONES
- 2 CAR GARAGE

TOTAL AREA 171.44m²

INTERNAL AREA 163.79m²

EXTERNAL AREA 7.65m²

GARDEN AREAS 46.00m²

FLOOR PLANS SHOWN IN THIS BROCHURE ARE INDICATIVE ONLY AND MAY DEPICT FIXTURES, FINISHES AND FEATURES NOT SUPPLIED BY THE DEVELOPER SUCH AS LANDSCAPING. FOR DETAILS HOME FINISHES AND FIXTURES PLEASE CONTACT OUR SALES CONSULTANT.

AWESOME INTERNATIONAL

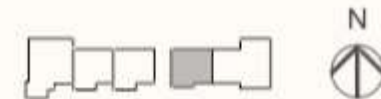

GROUND FLOOR



FIRST FLOOR



SECOND FLOOR

DWELLING

UNIT 2

3 BEDROOMS
3 BATHROOMS
2 LIVING ZONES
1 CAR GARAGE

TOTAL AREA 145.71m²
INTERNAL AREA 136.41m²
EXTERNAL AREA 9.30m²

GARDEN AREAS 20.30m²

FLOOR PLANS SHOWN IN THIS BROCHURE ARE INDICATIVE ONLY AND MAY DEPICT FIXTURES, FINISHED AND FEATURES NOT SUPPLIED BY THE DEVELOPER SUCH AS LANDSCAPING. FOR DETAILS HOME FINISHES AND FIXTURES PLEASE CONTACT OUR SALES CONSULTANT.

AWESOME INTERNATIONAL

NESIT

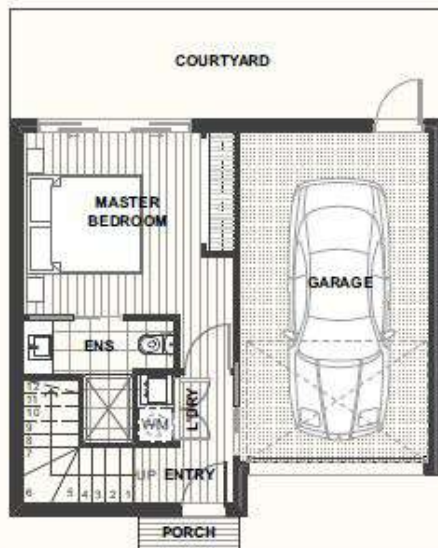
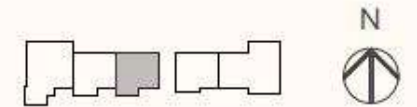

GROUND FLOOR



FIRST FLOOR



SECOND FLOOR

DWELLING
UNIT 3

3 BEDROOMS
3 BATHROOMS
2 LIVING ZONES
1 CAR GARAGE

TOTAL AREA 148.90m²
INTERNAL AREA 139.73m²
EXTERNAL AREA 9.17m²

GARDEN AREAS 20.30m²

FLOOR PLANS SHOWN IN THIS BROCHURE ARE INDICATIVE ONLY AND MAY DEPICT FIXTURES, FINISHED AND FEATURES NOT SUPPLIED BY THE DEVELOPER SUCH AS LANDSCAPING. FOR DETAILS HOME FINISHES AND FIXTURES PLEASE CONTACT OUR SALES CONSULTANT.

AWESOME INTERNATIONAL

NESIT



GROUND FLOOR



FIRST FLOOR

DWELLING

UNIT 5

4 BEDROOMS
3 BATHROOMS
2 CAR SPACES

TOTAL AREA 164.31m²
INTERNAL AREA 162.95m²
EXTERNAL AREA 1.36m²

GARDEN AREAS 25.15m²

FLOOR PLANS SHOWN IN THIS BROCHURE ARE INDICATIVE ONLY AND MAY DEPICT FIXTURES, FINISHED AND FEATURES NOT SUPPLIED BY THE DEVELOPER SUCH AS LANDSCAPING. FOR DETAILS HOME FINISHES AND FIXTURES PLEASE CONTACT OUR SALES CONSULTANT.

C.
(N)